

GOVERNMENT CORNER RESTORATION FORM

FILED

TOWNSHIP 26 S RANGE 05 W SEC. 23 PLSS # 039070

Date: 5/6/2013 By: JC

This survey consists of:

DOUGLAS COUNTY OREGON

DATE APRIL 12, 2013

Map: _____

Narrative: _____

Corner Rpt: CS 67 | 38-23

Corner Designation

DOUGLAS COUNTY SURVEYOR

SSE
DLC 39

- Condition Report
- Not Found
- Renewed
- Unrecorded
- Surveyed In
- Referenced Out

Previous Renewals 1922, 1954
Monument(s) Found: _____ (Condition and Source)

MONUMENT DETAIL

FROM THE 1922 RENEWAL AN IRON PIPE NOW A 1 INCH I. D. IRON PIPE, FIRMLY AND PLUMBLY SET, PROTRUDING 1 FOOT ABOVE GROUND AND SET 1 1/2 FEET WEST OF A N-S RUNNING FENCE LINE.

N/A

Accessories Found

EVIDENCE OF TWO ORIGINAL B.T.'S.
A B. OAK 24" DIA. NOW A ROOT HOLE WITH ROOTS AND ROTTED BLACK OAK FRAGMENTS NEARBY, BEARS S 70° W, 107 1/2 FEET DISTANT (AS PER RECORD).
A W. OAK 7" DIA. NOW A ROOT HOLE; BEARS N 63° W, 52 1/2 FEET DISTANT (AS PER RECORD).

EVIDENCE OF THE ONE NEW 1922 RENEWAL BEARING TREE.
A B. OAK 24" DIA. NOW A FALLEN AND OUT OF POSITION, ROTTED OUT AND BROKEN, 24+ INCH DIAMETER BLACK OAK WITH NO BLAZE OR SCRIBING REMAINING; THE ROOT HOLE OF WHICH BEARS N 58° E, 52 3/4 FEET DISTANT (AS PER 1954 RECORD).

TWO 1954 RENEWAL BEARING TREES.
AN 18" W. OAK NOW A DOUBLE TRUNK WHITE OAK, THE SCRIBED TRUNK OF WHICH NOW IS 19 INCHES IN DIAM. AND SHOWS A FULLY HEALED DOUBLE BLAZE. A 13 INCH DIAM. TRUNK NOW STANDS BETWEEN THE SCRIBED TRUNK AND THE CORNER MONUMENT. THE CENTER OF THE ~~NOW~~ DOUBLE TRUNK BEARS S 50° W, 52 FEET DISTANT (RECORD S 50° W, 60 FT AGREES WITH THE BASE OF THE SCRIBED TRUNK).
A 10" W. OAK NOW A 14 INCH DIAM. WHITE OAK WITH A FULLY HEALED DOUBLE BLAZE; BEARS N 41° W, 28 1/2 FEET DISTANT (AS PER RECORD).

Monument Set (Procedure and Description)

MONUMENT DETAIL

N/A

N/A

New Accessories

A 12 INCH DIAM. WHITE OAK SCRIBED "SSE DLC 39 CS" "BT" ON A DOUBLE BLAZE; BEARS N43°E, 232 FEET DISTANT.

A 5/8 INCH DIAM. IRON ROD FIRMLY AND PLUMBLY SET PROTRUDING 8 INCHES ABOVE GROUND (ROD IS AT A FENCE CORNER WITH FENCES RUNNING NORTH-SOUTH AND WEST); BEARS S5 1/2°E, 243 FEET DISTANT.

Sketch of Monument, Accessories, and General Area

Location & Comments

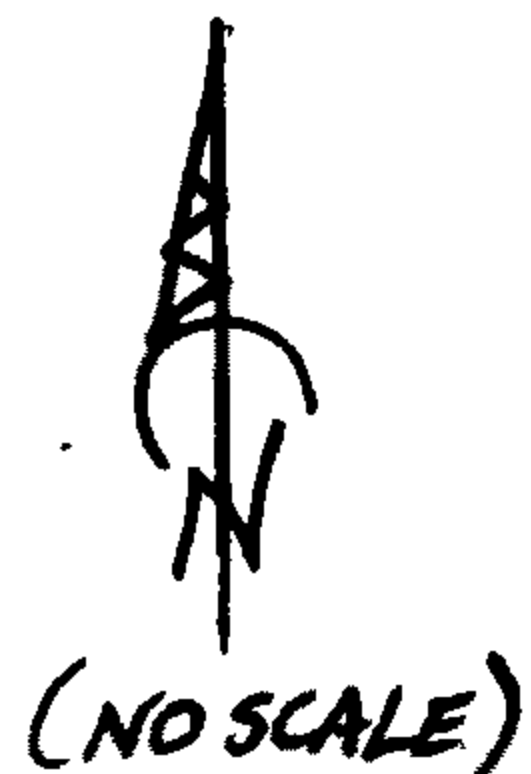

MONUMENT IS ON GENTLE WEST SLOPE IN OPEN OAK WOODLAND.

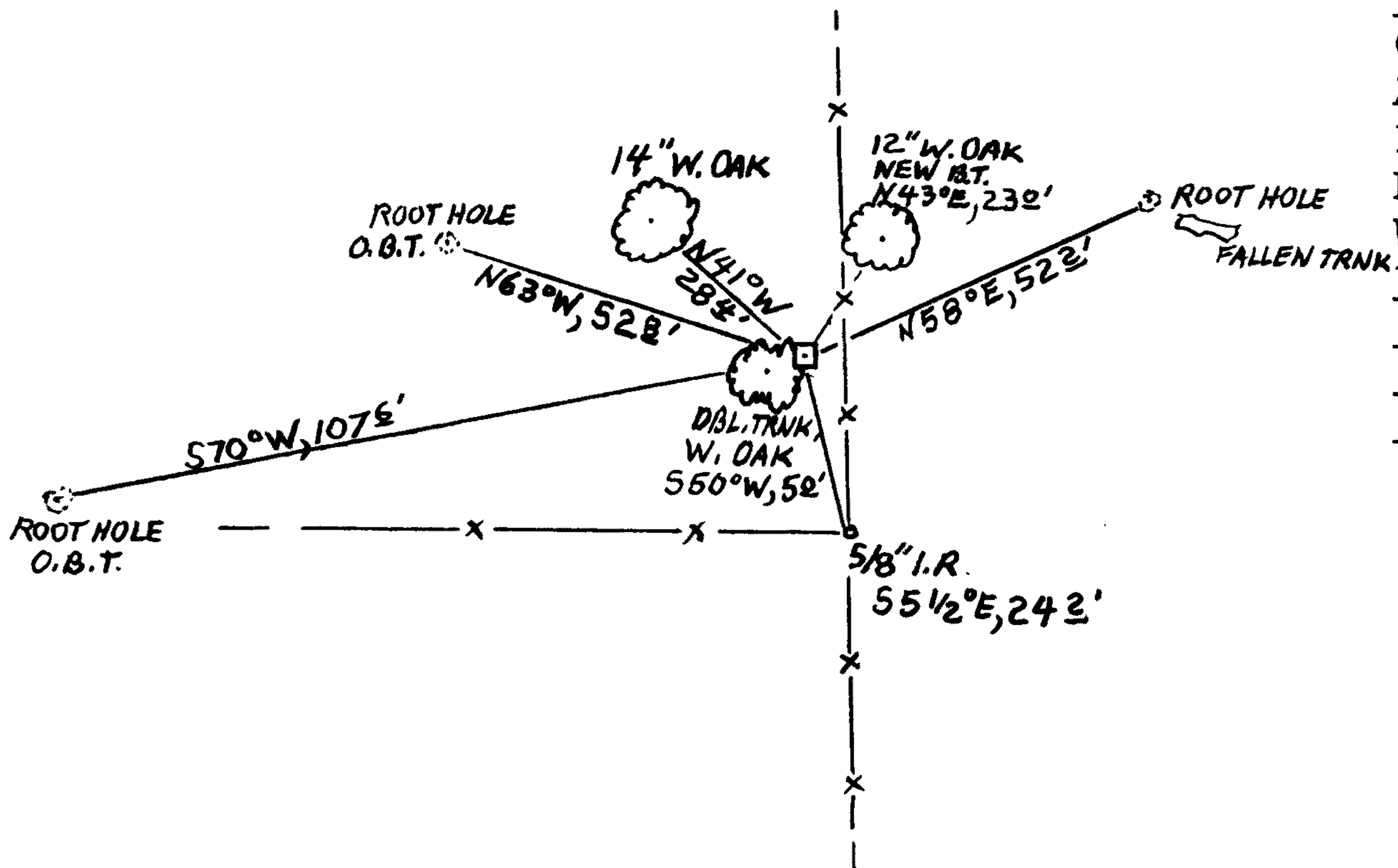

Comp. Decline. 15 1/2°E
Agency DC50
Party Chief STEPHEN JOHN FLAUSE
Note keeper Stephen John Flause
Witnesses MIKE S. KOCH

Surveyor's Seal

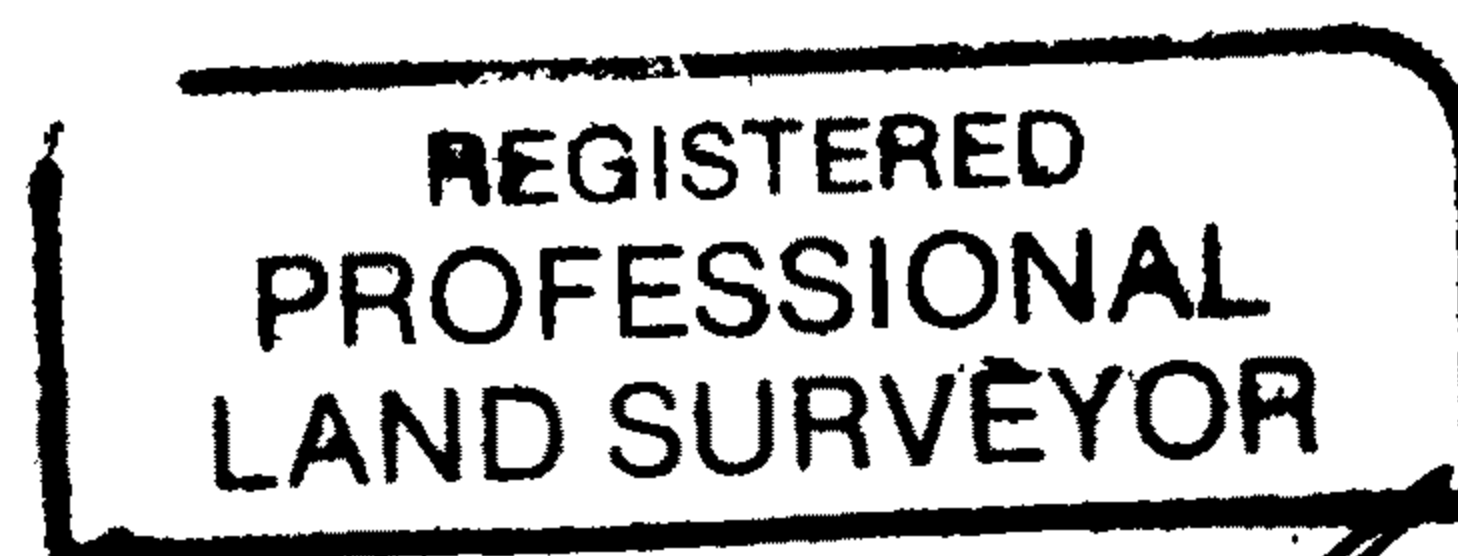

Handwritten signature of Randall W. Smith

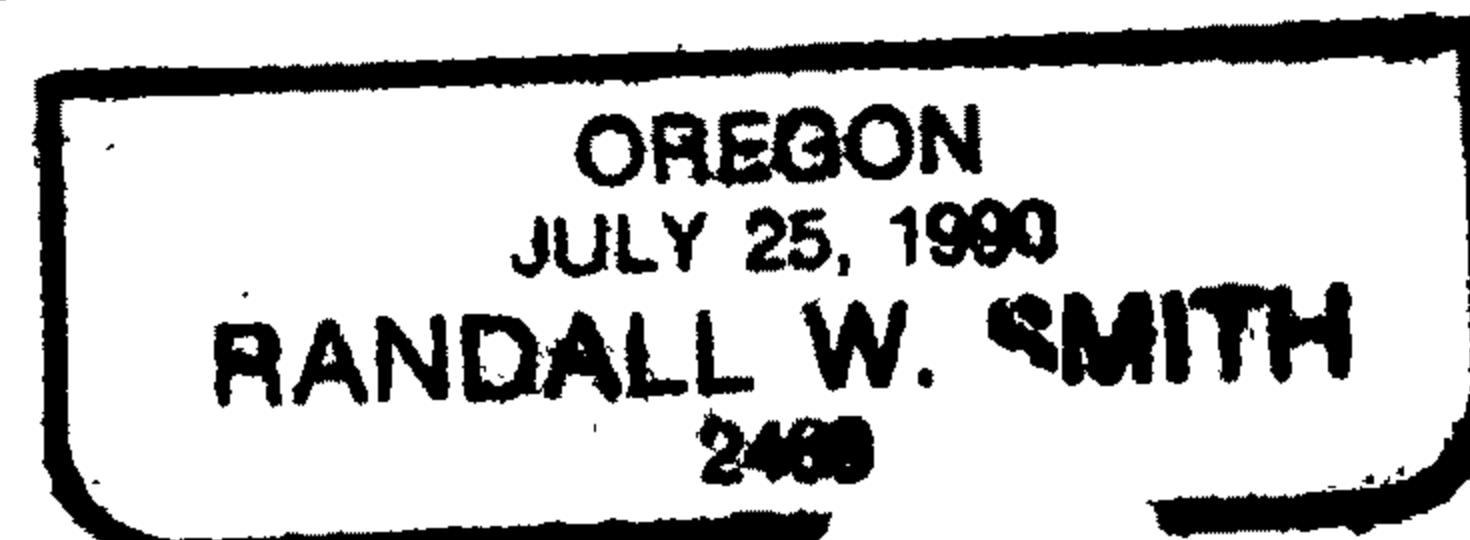

Renewal 6-30-2014