

RENEWAL

Monument Set (Procedure and Description)

THE POSITION OF THE FOUND IRON PIPE MONUMENT IS REFERENCED OUT, IT IS REMOVED AND IN ITS PLACE IS SET A 2 1/2 INCH DIAMETER BRASS CAP (MARKED AS AT RIGHT) ON A 1 INCH I.D. X 32 INCH LONG IRON PIPE. NEW B.C. MONUMENT NOW PROTRUDES 4 INCHES ABOVE GROUND, THE FOUND 1/2 INCH IRON PIPE IS SET PROTRUDING 2 INCHES ABOVE GROUND ON SOUTH EDGE OF B.C. MONUMENT.

CORNER POST OF NEW FENCES RUNNING WEST AND SOUTH IS SOUTHWEST 1 FOOT.

Monument Detail

DOUGLAS COUNTY SURVEYORS OFFICE

T 305
R 5 W
S 28
1/4 —●—
S 33
2013

New Accessories

A 14 INCH DIAMETER DOUGLAS FIR SCRIBED "1/4 S33.CS" "BT" ON A DOUBLE BLAZE; BEARS S65 1/2 °W, 18 1/2 FEET DISTANT.

AN 8 INCH DIAMETER WHITE OAK SCRIBED "1/4 S28.CS" "BT" ON A DOUBLE BLAZE; BEARS N58 1/2 °W, 21 1/2 FEET DISTANT.

Sketch of Monument, Accessories, and General Area

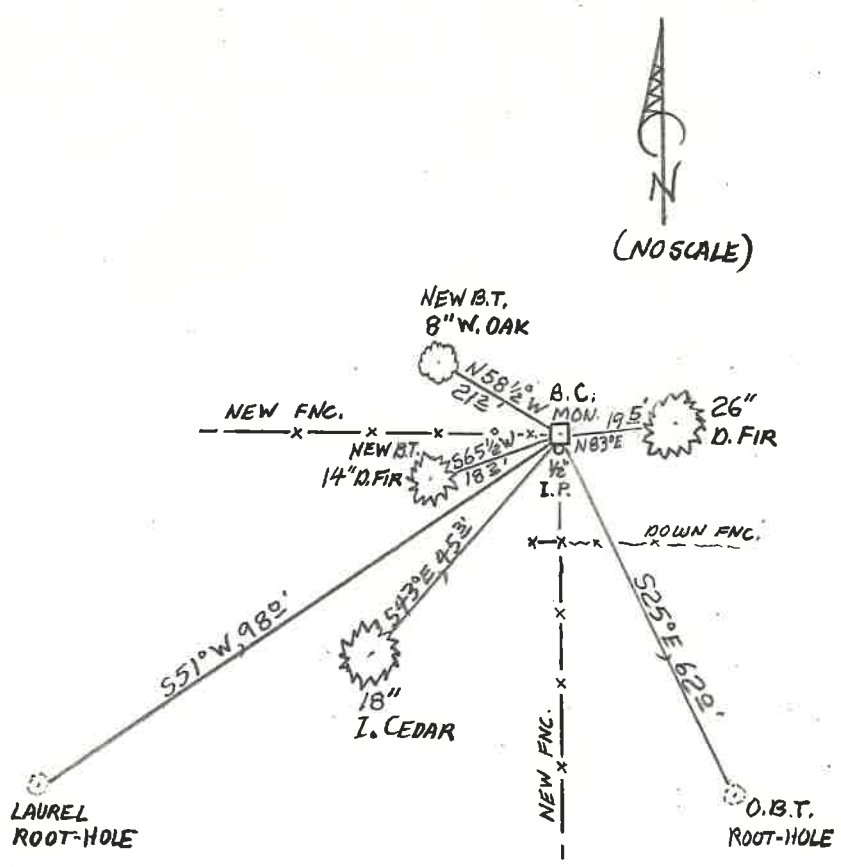

Location & Comments

MONUMENT IS ON MODERATE NE'LY SLOPE IN SPARSE WOODS OF OAK, MARRONE, FIR AND CEDAR.

Comp. Declin. 15 1/2 °E
Agency P.C.S.O.
Party Chief STEPHEN JOHN FLAUSE
Notekeeper Stephen John Flause
Witnesses MIKE S. KOCH

Address

REGISTERED
PROFESSIONAL
LAND SURVEYOR

Randall W. Smith

OREGON
JULY 25, 1990
RANDALL W. SMITH
2488

RENEWAL 6-30-14