

GOVERNMENT CORNER RESTORATION FORM

FILED

TOWNSHIP 30S RANGE 05W SEC. 27 PLSS # 062030

Date: 1-23-2013 By: JC

DOUGLAS COUNTY OREGON

DATE JAN. 17, 2013

This survey consists of:

Map: \_\_\_\_\_

Narrative: \_\_\_\_\_

Corner Rpt: CS67/38-3

Corner Designation

SW  
DLC 62

DOUGLAS COUNTY  
SURVEYOR

Previous Renewals 1922, 1953  
Monument(s) Found: \_\_\_\_\_ (Condition and Source)

- \_\_\_\_\_ Condition Report
- \_\_\_\_\_ Not Found
- Renewed
- \_\_\_\_\_ Unrecorded
- \_\_\_\_\_ Surveyed In
- \_\_\_\_\_ Referenced Out

A 3/4 INCH I.D. X 20 1/2 INCH LONG IRON PIPE (NOT OF RECORD) FIRMLY AND PLUMBLY SET PROTRUDING 6 INCHES ABOVE GROUND. WHEN THIS MONUMENT IS REFERENCED AND REMOVED TO SET NEW B.C. MONUMENT WE SEARCH FURTHER FOR 1953 "IRON ROD" BUT DO NOT FIND ANY EVIDENCE.

N/A

MONUMENT DETAIL

Accessories Found

EVIDENCE OF THE ORIGINAL BEARING TREE IS FOUND.  
A W. OAK 18" DIA. NOW A 31 INCH DIAMETER WHITE OAK WITH A PREVIOUSLY OPENED, AND NOW PARTIALLY REHEALED, UPPER BLAZE SHOWING A ROTTED INTERIOR WITH NO VISIBLE FACE REMAINING AND A POSSIBLE REHEALED LOWER BLAZE; BEARS N70°E, 31 1/2 FEET DISTANT (ORIG. RECORD N70°E, 33 1/2 FEET, THIS DISTANCE IS A POSSIBLE SLOPE DISTANCE TO FACE MEAS.).

EVIDENCE OF THE ONE 1922 RENEWAL BEARING TREE IS FOUND.  
AN 8" FIR NOW A 21 INCH DIAMETER DOUGLAS FIR WITH A PREVIOUSLY OPENED AND NOW REHEALED BLAZE; BEARS S31°E, 6 1/2 FEET DISTANT (RECORD S25°E, 6 1/2 FT. THIS BEARING MAY BE TO LEANING TRUNK AND NOT CENTER OF ROOT CROWN).

C.S. File 67/38-3

RENEWAL

Monument Set (Procedure and Description)

MONUMENT DETAIL

POSITION OF FOUND I.P. MONUMENT IS REFERENCED OUT, MONUMENT IS REMOVED AND IN ITS PLACE IS SET A 2 1/2 INCH DIAMETER BRASS CAP (MARKED AS AT RIGHT) ON A 1 INCH I.D. X 32 INCH LONG IRON PIPE PROTRUDING 6 INCHES ABOVE GROUND. THE FOUND 3/4 INCH I.D. IRON PIPE IS SET ON B.C. MONUMENTS SOUTH EDGE AND PROTRUDES 4 INCHES ABOVE GROUND.

DOUGLAS CO. SURVEYORS OFFICE

T 30 S

DLC 62

R 5 W

2013

New Accessories

A 21 INCH DIAMETER DOUGLAS FIR SCRIBED "SW DLC 62 CS" "BT" ON A DOUBLE BLAZE (BLAZE IS FAIRLY HIGH ON TREE DUE TO BURIED BASE); BEARS S 80 1/2° W, 32 1/2 FEET DISTANT.

AN 18 INCH DIAMETER WHITE OAK SCRIBED "SW DLC 62 CS" "BT" ON A DOUBLE BLAZE; BEARS N 54 1/4° W, 80 1/2 FEET DISTANT

Sketch of Monument, Accessories, and General Area

Location & Comments

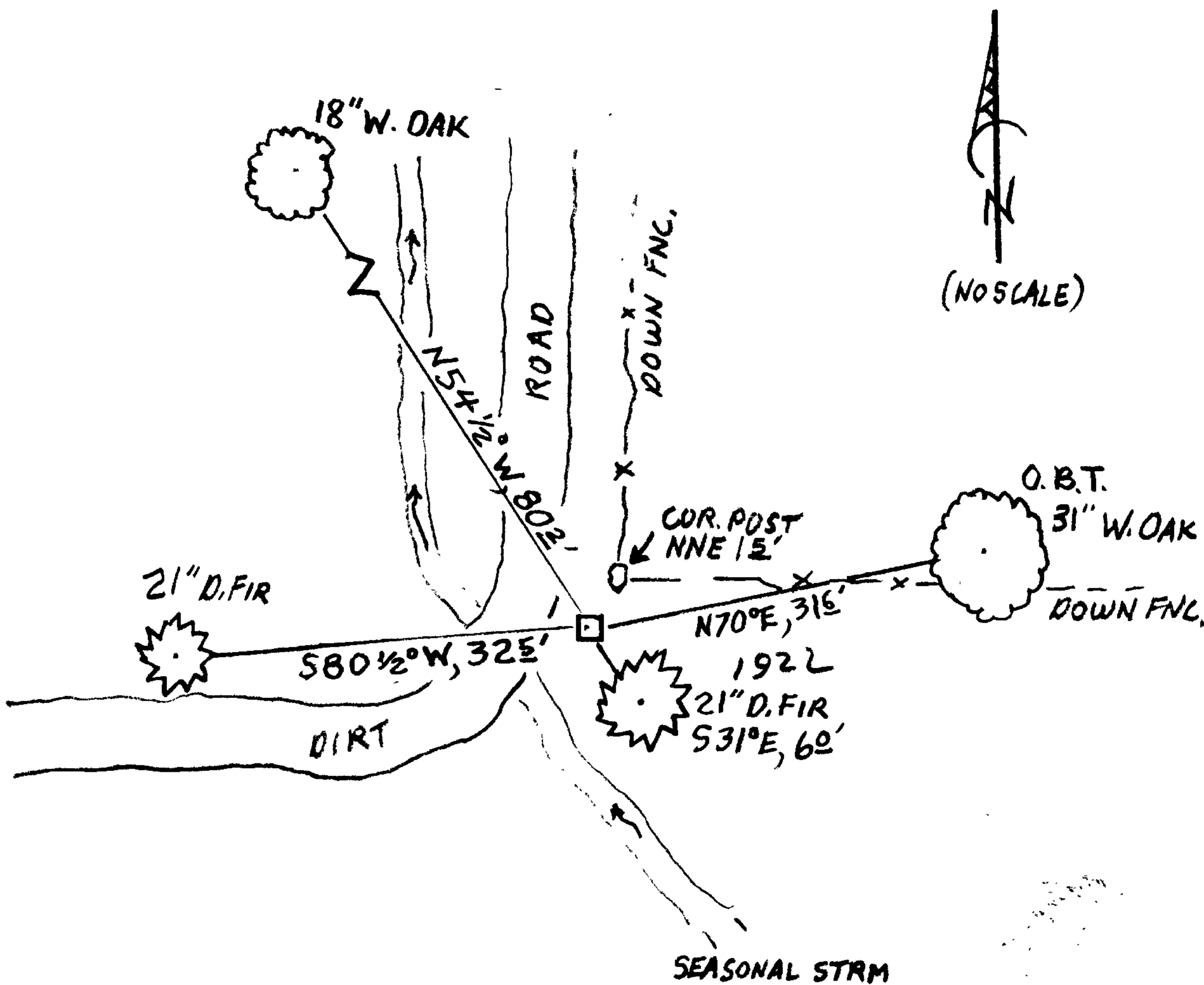

MONUMENT IS ON MODEST NORTH SLOPE ON EAST SIDE OF SHALLOW DRAW OF A SMALL SEASONAL STREAM. SPARSE OAK OPENINGS, SOME FIR AND MADRONE.

Comp. Decline. 15 1/2° E

Agency DC SO

Party Chief STEPHEN JOHN FLAUSE

Note keeper Stephen John Flause

Witnesses MIKE S. KOCH

Surveyor's Seal

REGISTERED PROFESSIONAL LAND SURVEYOR

Handwritten signature of Randall W. Smith

OREGON JULY 25, 1990 RANDALL W. SMITH 2488

RENEWAL 6-4-2014