

GOVERNMENT CORNER RESTORATION FORM

FILED

TOWNSHIP 30S RANGE 5W SEC. 26 PLSS # 500200

Date: 1-23-2013 By: JC
This survey consists of:

DOUGLAS COUNTY OREGON

DATE JAN. 17, 2013

Map: _____

Narrative: _____

Corner Rpt: 67/38-2

Corner Designation

DOUGLAS COUNTY
SURVEYOR

527 | 526
---+---
534 | 535

- ___ Condition Report
- ___ Not Found
- Renewed
- ___ Unrecorded
- ___ Surveyed In
- ___ Referenced Out

Previous Renewals 1922, 1953-54, 1967
Monument(s) Found: _____ (Condition and Source)

MONUMENT DETAIL

A 3 1/4 INCH DIAMETER BRASS CAP (MARKED AS AT RIGHT) ON A 2 1/2 INCH I.D. IRON PIPE, FIRMLY AND PLUMBLY SET, PROTRUDING 6 INCHES ABOVE GROUND.

U.S. DEPT. OF THE INTERIOR
T30S R5W
527 | 526
534 | 535
1967

1953-54 IRON PIPE MONUMENT SET UNDER B.C. MONUMENT (NOT LOOKED FOR).

BUR. OF LAND MANAGEMENT

Accessories Found

POSSIBLE EVIDENCE OF 2 ORIGINAL BEARING TREES.
A W. OAK 10" DIA. NOW AN 18 INCH DIAMETER WHITE OAK WITH A POSSIBLE ROTTEN BLAZE (WE DO NOT OPEN FURTHER) IS FOUND, OUT OF POSITION, BUT NEAR SE QUADRANT D.B.T. BEARING AND DISTANCE. NO ROOT-HOLE REMAINS.
A W. OAK 12" DIA. NOW A FALLEN (ON FACE) AND ROTTED 18 INCH DIAMETER WHITE OAK WITH NO BLAZE EVIDENT; THE ROOT OF WHICH BEARS S10°W, 33° FEET DISTANT (AS PER RECORD)

EVIDENCE OF ONE 1922 RENEWAL BEARING TREE FOUND.
A 24" FIR NOW A 40 INCH DIAMETER DOUGLAS FIR STUMP 4 FEET TALL, BUT SHOWING NO BLAZE EVIDENCE (WE DO NOT OPEN); BEARS S89°E, 68 1/2 FEET DISTANT (RECORD N89°E, 68 1/2 FT.).

EVIDENCE OF THREE 1953-54 RENEWAL BEARING TREES FOUND.
A 36" B. OAK NOW A FALLEN AND VERY ROTTED 34 INCH DIAMETER OAK, DOWN AND OUT OF POSITION WITH NO REMAINING BLAZE EVIDENCE; THE POSSIBLE ROOT-HOLE OF WHICH BEARS S80°E, 33 1/2 FEET DISTANT (RECORD S78 1/2°E 33 1/2 FT.).

A 24" OAK, NOW A CLEAR WELL DEFINED ROOT-HOLE (NO IDENTIFIABLE EVIDENCE OF TREE FOUND); BEARS N78 3/4°W, 54 1/2 FEET DISTANT (AS PER RECORD).

A 14" W. OAK NOW A 16 INCH DIAMETER WHITE OAK WITH A FULLY HEALED DOUBLE BLAZE; BEARS S60 1/2°W, 63° FEET DISTANT (AS PER ORIG. RECORD).

BLM 1967 RENEWAL HAD NO NEW B.T.S.

C.S. File 67/38-2

RENEWAL

Monument Set (Procedure and Description)

MONUMENT DETAIL

N/A

N/A

New Accessories

A 29 INCH DIAMETER DOUGLAS FIR SCRIBED "T30SR6WS26CS" "BT" ON A DOUBLE BLAZE; BEARS N49°12'E, 79 FEET DISTANT.

A 22 INCH DIAMETER MADRONE SCRIBED "T30SR5WS35CS" "BT" ON A DOUBLE BLAZE; BEARS S18°14'E, 48 FEET DISTANT.

A 26 INCH DIAMETER BLACK OAK SCRIBED "T30SR5WS27CS" "BT" ON A DOUBLE BLAZE; BEARS N72°12'W, 79 FEET DISTANT.

Sketch of Monument, Accessories, and General Area

Location & Comments

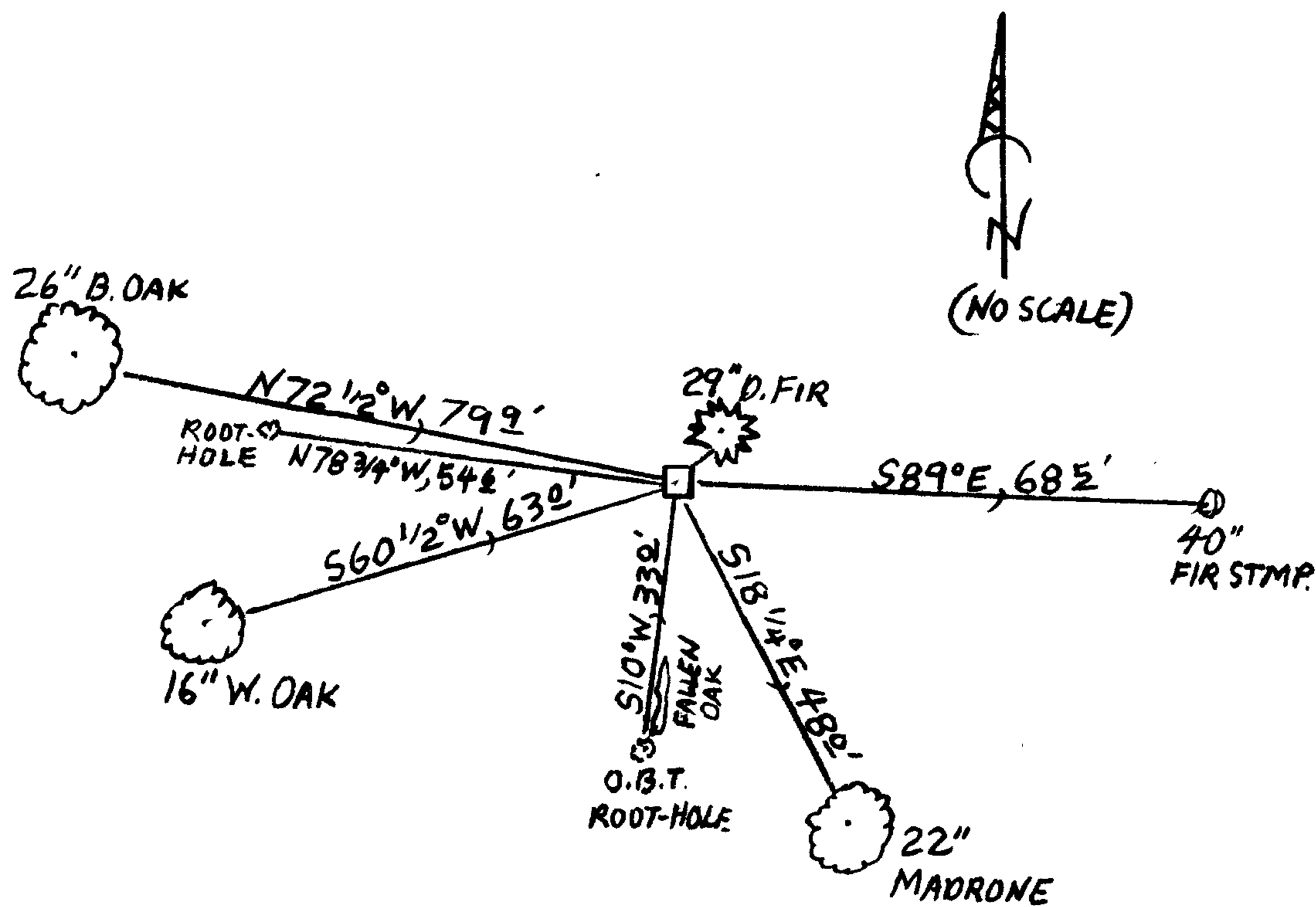

(OUT OF POSITION TREES NOT SHOWN)

Comp. Decline. 15°12'E
 Agency DCSO
 Party Chief STEPHEN JOHN FLAUSE
 Note keeper Stephen John Flause
 Witnesses MIKE S. KOCH

Surveyor's Seal

REGISTERED
 PROFESSIONAL
 LAND SURVEYOR

OREGON
 JULY 25, 1990
 RANDALL W. SMITH
 2400

Rovvnr 6-30-2014