

FILED

GOVERNMENT CORNER RESTORATION FORM

Date: 11/6/2012 By: JC
This survey consists of:
Map: _____
Narrative: _____
Corner Rpt: CS 67/36-34

Township 30S Range 05W Sec. 27 County DOUGLAS

State OREGON Date OCT. 25, 2012 No. 051060

Corner Designation

ESE
DLC 51

DOUGLAS COUNTY
SURVEYOR
Condition Report Only
Not Found
 Renewed
Unrecorded
Surveyed In
Referenced Out

Previous Renewals 1974

Monument(s) Found: (Condition and Source)

FROM THE 1974 RENEWAL A 2 1/2 INCH DIAMETER BRASS CAP (MARKED AS AT RIGHT: CORNER DESIGNATION IS INCORRECT, SHOULD BE ESE DLC 51), ON A 1 INCH I.D. IRON PIPE, IS FIRMLY AND PLUMBLY SET PROTRUDING 6 INCHES ABOVE GROUND.

T 30 S R 5 W

INT.
COR | 51
DLC

OLS 536 1974

(STAMPING ON CAP IS ORIENTED SW)

Accessories Found:

NO EVIDENCE OF O.B.T.
LOCATION OF TREE IS NOW UNDER DEEP FILL FROM BUILDING SITE.

FROM 1974 RENEWAL EVIDENCE OF TWO BEARING TREES FOUND.
AN 8" W. FIR NOW A LARGE UNEVEN ROOT-HOLE WITH NO EVIDENCE OF B.T. REMAINING, AGREES REASONABLY WITH RECORD N 63 3/4° E, 188 FEET DISTANT.
A 6" W. FIR (INCORRECTLY IDENTIFIED) NOW A 17 INCH DIAMETER DOUGLAS FIR WITH A FULLY HEALED DOUBLE BLAZE; BEARS N 11 3/4° W, 6 3/4 FEET DISTANT (RECORD N 7 3/4° W, 5 1/2 FEET; THIS IS CLOSER TO A FACE MEASUREMENT).

C.S. File No 67/36-34

RENEWAL

Monument Set (Procedure and Description)

Monument Detail

MONUMENT ACCEPTED AS FOUND INCORRECT MARKINGS NOTED BUT NOT ALTERED.

N/A

New Accessories

AN 18 INCH DIAMETER PONDEROSA PINE SCRIBED "ESE DLC 51C5" "BT" ON A DOUBLE BLAZE; BEARS N85 1/4°E, 248 FEET DISTANT.

A 1 1/2 INCH I.D. IRON PIPE FOUND PROTRUDING 2 INCHES ABOVE GROUND ON EAST EDGE OF CORNER POST FOR FENCES RUNNING WEST AND NORTH NORTHWEST. THIS PROPERTY CORNER MONUMENT WAS SET FOR A SURVEY FILED IN DCSD RECORDS AS M 65-23 ; BEARS S89°E, 605 FEET DISTANT (AS PER RECORD FROM DCSD LAND PART. FILE 1993-30).

A 6 INCH DIAMETER INCENSE CEDAR SCRIBED "X" "CSBT" ON A HIGH-LOW BLAZE; BEARS S11 3/4°W, 63 FEET DISTANT.

Sketch of Monument, Accessories, and General Area

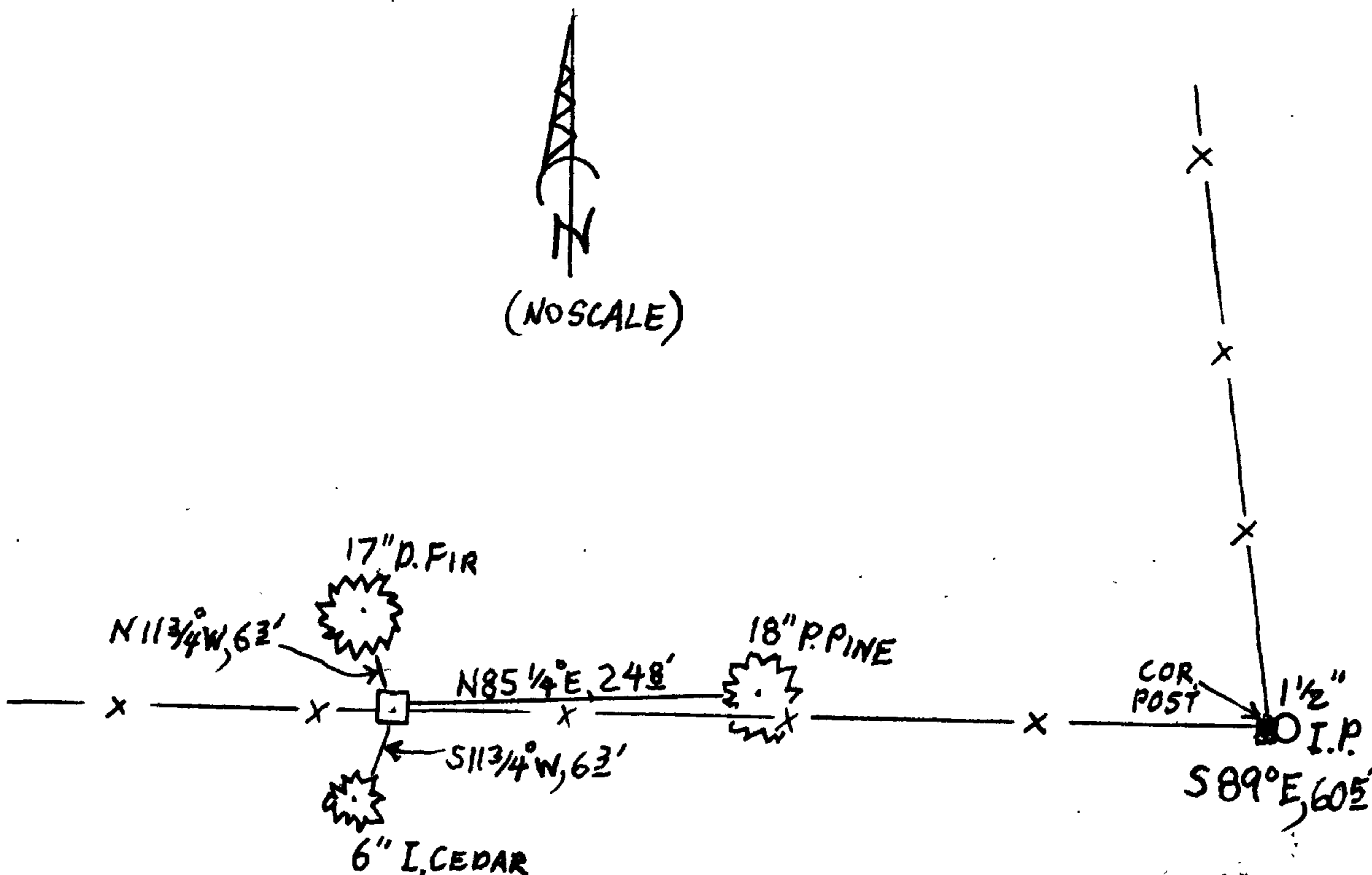

Location & Comments

MONUMENT IS ON VERY GENTLE EAST SLOPE IN MIXED CEDAR, FIR, PINE AND OAK WOODS.

Comp. Declin. 15 1/2°E

Agency DCSD

Party Chief STEPHEN JOHN FLAISE

Notekeeper Stephen John Flaise

Witnesses MIKE S. KOCH

Address

Surveyor's Seal

REGISTERED PROFESSIONAL LAND SURVEYOR

Stephen John Flaise

RENEWAL 6-30-2013

OREGON
JULY 25, 1990
RANDALL W. SMITH
2488