

FILED

GOVERNMENT CORNER RESTORATION FORM Date: 11/6/2012 By: JC

Township 30S Range 05W Sec. 28 County DOUGLAS

State OREGON Date OCT. 12, 2012 No. 046060 Narrative: _____

Corner Rpt: CS 67/36-33

Corner Designation

DOUGLAS COUNTY

SURVEYOR

Condition Report Only

Not Found

Renewed

Unrecorded

Surveyed In

Referenced Out

MONUMENT DETAIL

Previous Renewals 1920, 1951, 1975

Monument(s) Found: (Condition and Source)

N/A

NO EVIDENCE OF PREVIOUS MONUMENTS FOUND. DEEP FILL FOR BASE OF ABANDONED DAM PROJECT COVERS AREA.

Accessories Found:

THE ONE ORIGINAL BEARING TREE IS FOUND. A B. OAK 18" DIA. NOW A 39 INCH DIAMETER BLACK OAK WITH A FULLY HEALED SINGLE BLAZE (PROBABLY PREVIOUSLY OPENED); BEARS N38 1/2° W, 213 1/2 FEET DISTANT (RECORD N37 1/2° W, 213 1/2 FT.).

NO EVIDENCE OF 1920 RENEWAL B.T.'S FOUND.

NO EVIDENCE OF 1951 RENEWAL B.T.'S FOUND.

EVIDENCE OF TWO 1975 RENEWAL B.T.'S FOUND. A 14" B. OAK NOW A 2 1/2 INCH DIAMETER 1 FOOT TALL OAK STUMP WITH NO EVIDENCE REMAINING OF BLAZING OR SCRIBING; BEARS N27 1/2° E, 463 FEET DISTANT (RECORD N29° E, 463 FT.).

A 21" I. CEDAR NOW A 32 INCH DIAMETER 4 1/2 FOOT TALL INCENSE CEDAR STUMP WITH NO BLAZES EVIDENT (DUE TO THICK FURROWED BARK); BEARS N75 1/2° E, 333 FEET DISTANT (RECORD N71 1/2° E, 333 FT.).

RENEWAL

Monument Detail

Monument Set (Procedure and Description)

AT A POINT DETERMINED BY INTERSECTING THE RECORD DISTANCE MEASUREMENTS FROM THE THREE FOUND B.T.'S WE SET A 2 3/8 INCH DIAMETER BRASS CAP (MARKED AS AT RIGHT) ON A 3/2 LONG 1 INCH I.D. IRON PIPE 30 INCHES IN THE GROUND.

COUNTY SURVEYORS OFFICE

T 30 S

SE

DLC 46

R 5 W

2012

New Accessories

A 19 INCH DIAMETER DOUGLAS FIR SCRIBED "SE DLC 46 CS" "BT" ON A DOUBLE BLAZE; BEARS N 61 1/2° E, 71 5 FEET DISTANT.

A 10 INCH DIAMETER MAPLE SCRIBED "SE DLC 46 CS" "BT" ON A DOUBLE BLAZE; BEARS S 65° W, 120 3 FEET DISTANT.

A DOUBLE TRUNK INCENSE CEDAR, THE 14 INCH DIAMETER SOUTHEAST TRUNK OF WHICH IS SCRIBED "SE DLC 46 CS" "BT" ON A DOUBLE BLAZE; BEARS N 14 3/4° W, 61 8 FEET DISTANT (TO C.R.C. OF DOUBLE TRUNK).

Sketch of Monument, Accessories, and General Area

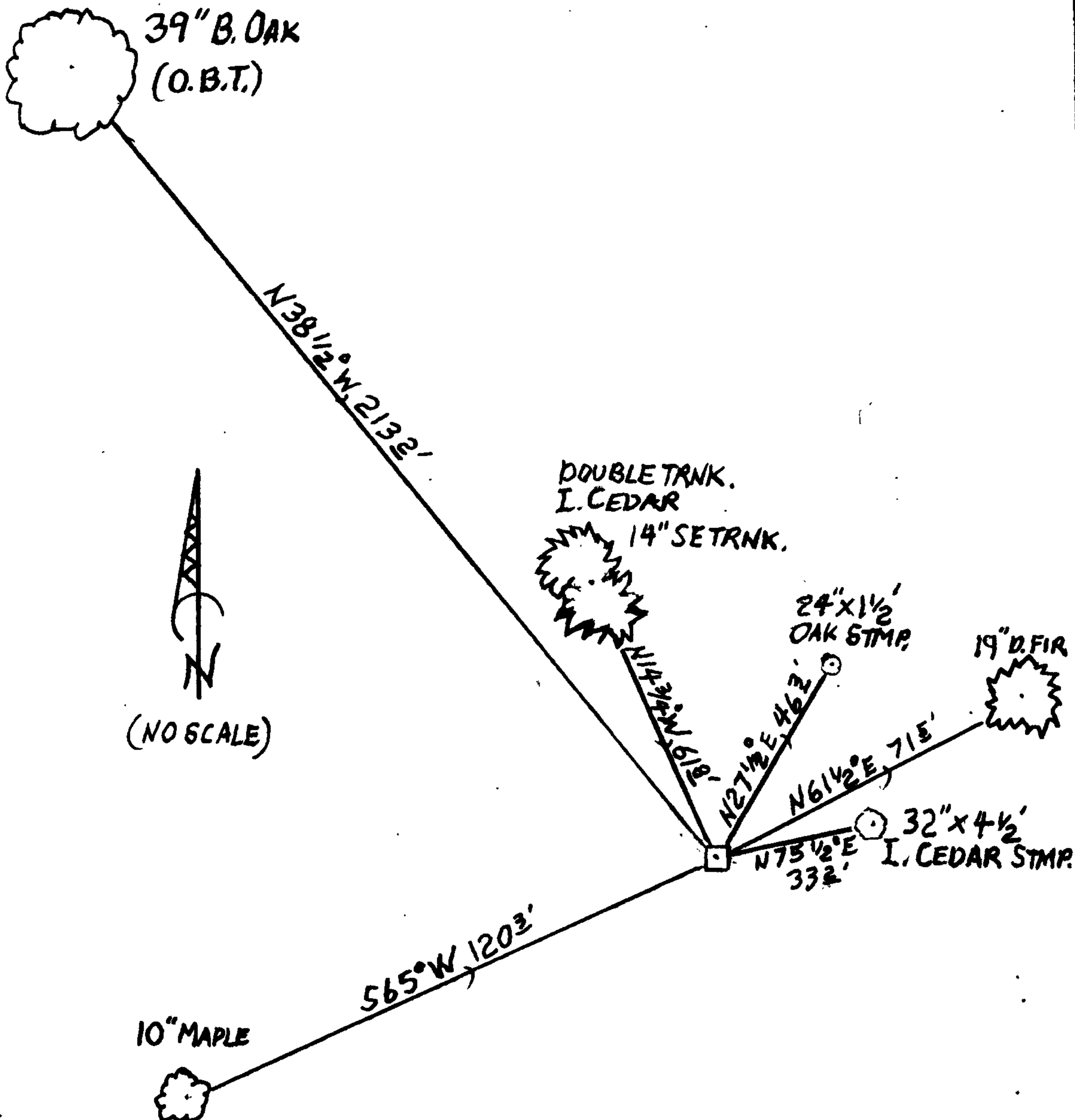

Location & Comments

MONUMENT IS ON MODERATE SOUTHEAST SLOPE ON NORTH SIDE WIDE CANYON RUNNING NORTHEASTERLY. MONUMENT JUST ABOVE A FLAT BEACH IN, AND NEAR THE NORTH PERIMETER OF THE FILL BASE OF AN ABANDONED DAM PROJECT.

Comp. Declin. 15 1/2° E

Agency NCSO

Party Chief STEPHEN JOHN FLAUSE

Notekeeper Stephen John Flause

Witnesses MIKE S. KOCH

Address

Surveyor's Seal
REGISTERED PROFESSIONAL LAND SURVEYOR
RANDALL W. SMITH
OREGON JULY 25, 1990
2400
Renewed 6-30-2013