

GOVERNMENT CORNER RESTORATION FORM

FILED

Township 30S Range 05W Sec. 20

County DOUGLAS This survey consists of:

Date: 11-5-2012 By: SC

State OREGON Date OCT 12, 2012

No. 300300 Map: _____

Narrative: _____

Corner Rpt: CS 67/36-31

Corner Designation

S20 | S21
S29 | S28

- Condition Report Only
 Not Found
 Renewed
 Unrecorded
 Surveyed In
 Referenced Out

MONUMENT DETAIL

Previous Renewals 1920, 1963, 1975

Monument(s) Found: (Condition and Source)

FROM THE 1920 RENEWAL A STONE (NO DESCRIPTION OF SIZE) NOT FOUND. STONES ARE AROUND BASE OF B.C. MONUMENT (BELOW) BUT NONE ARE MARKED.

FROM THE 1963 REWAL A 2 1/2 INCH DIAMETER BRASS CAP (MARKED AS AT RIGHT) ON A 1 INCH I.D. IRON PIPE IS FIRMLY AND PLUMBLY SET PROTRUDING 15 INCHES ABOVE A LOW ROUGH MOUND OF STONE

COUNTY SURVEYORS OFFICE

T 30S

S20 | S21

S29 | S28

R5W

1963

Accessories Found:

EVIDENCE OF 4 O.B.T.s FOUND. A POSSIBLE ROOT HOLE IS FOUND CLOSE TO BEARING AND DISTANCE OF THE NE BEARING TREE. A W. OAK 20" DIA. NOW A 24 INCH DIAMETER WHITE OAK WITH A ROTTEN CENTER (NO BLAZING OR SCRIBING REMAINS); BEARS S56°E, 31 8 FEET DISTANT (RECORD S60°E, 29 0 FEET, THIS DIST. IS CLOSE TO FACE MEAS.) A B. OAK 12" DIA. NOW A 25 INCH DIAMETER BLACK OAK WITH A PREVIOUSLY OPENED, NOW FULLY HEALED, BLAZE; BEARS S45°W, 114 3 FEET DISTANT (RECORD S45°W, 112 2 FT.). A B. OAK NOW A LOW ROTTED OAK STUB; BEARS N45°W, 59 4 FEET DISTANT (AS PER RECORD).

EVIDENCE OF FOUR 1920 RENEWAL B.T.s FOUND. A LAUREL 10" DIA. NOW A 1 FOOT TALL 15 INCH DIAMETER MADRONE STUMP WITH NO BLAZE EVIDENCE; BEARS S55 1/2°E, 9 2 FEET DISTANT (AS PER RECORD). AN 11" LAUREL NOW A 3 FOOT LONG 14 INCH DIAMETER MADRONE STUMP WITH A POSSIBLE ROTTED OUT BLAZE SCAR IS TIPPED OUT AND FALLEN (ORIGINAL POSITION INDISCERNIBLE). A W. OAK 5" DIA. NOW AN 8 INCH DIAMETER BLACK OAK WITH A POSSIBLE HEALED BLAZE (VERY FAINT); BEARS N65°W, 14 7 FEET DISTANT (RECORD N65°W, 15 2 FT.) A LAUREL 8" DIA. NOW A 12 INCH DIAMETER MADRONE WITH AN UNHEALED ROTTED-OUT DOUBLE BLAZE; BEARS N8 1/2°W, 7 3 FEET DISTANT (RECORD N11°W, 7 3 FT.).

EVIDENCE OF FOUR 1963 RENEWAL B.T.s FOUND. A 5" W. OAK NOW AN 8 INCH DIAMETER WHITE OAK WITH A FULLY HEALED DOUBLE BLAZE; BEARS N44°E, 16 2 FEET DISTANT (AS PER RECORD). A 7" R. FIR NOW A MOSTLY ROTTED AWAY FALLEN DOUGLAS FIR BUT WITH BLAZE FACES STILL INTACT READING "T30S R5W S28 CS" "BT"; LIES NEAR RECORD B. AND D. BUT HAS NO REMAINING ROOT-HOLE. AN 8" R. FIR NOW A DOUGLAS FIR (SAME DESCRIPTION AND SCRIBING AS FOR PREVIOUS FIR BUT WITH INTACT ROOT CROWN); BEARS S28°E, 33 6 FEET DISTANT (AS PER RECORD). AN 8" LAUREL NOW A 16 INCH DIAMETER MADRONE WITH A FULLY HEALED DOUBLE BLAZE; BEARS S48°W, 38 6 FEET DISTANT (RECORD S52°W, 38 0 FT.)

EVIDENCE OF THE 1975 RENEWAL BEARING TREE. A 13" FIR NOW A 25 INCH DIAMETER DOUGLAS FIR WITH A FULLY HEALED DOUBLE BLAZE; BEARS N86°W, 59 2 FEET DISTANT (AS PER RECORD).

C.S. File No 67/36-31

Monument Set (Procedure and Description)

Monument Detail

N/A

N/A

New Accessories

ALL FOUND B.T.S ARE TAGGED TO REFLECT CHANGED MEASUREMENTS.

Sketch of Monument, Accessories, and General Area

(TO SIMPLIFY, SKETCH SHOWS LIVE B.T.S ONLY)

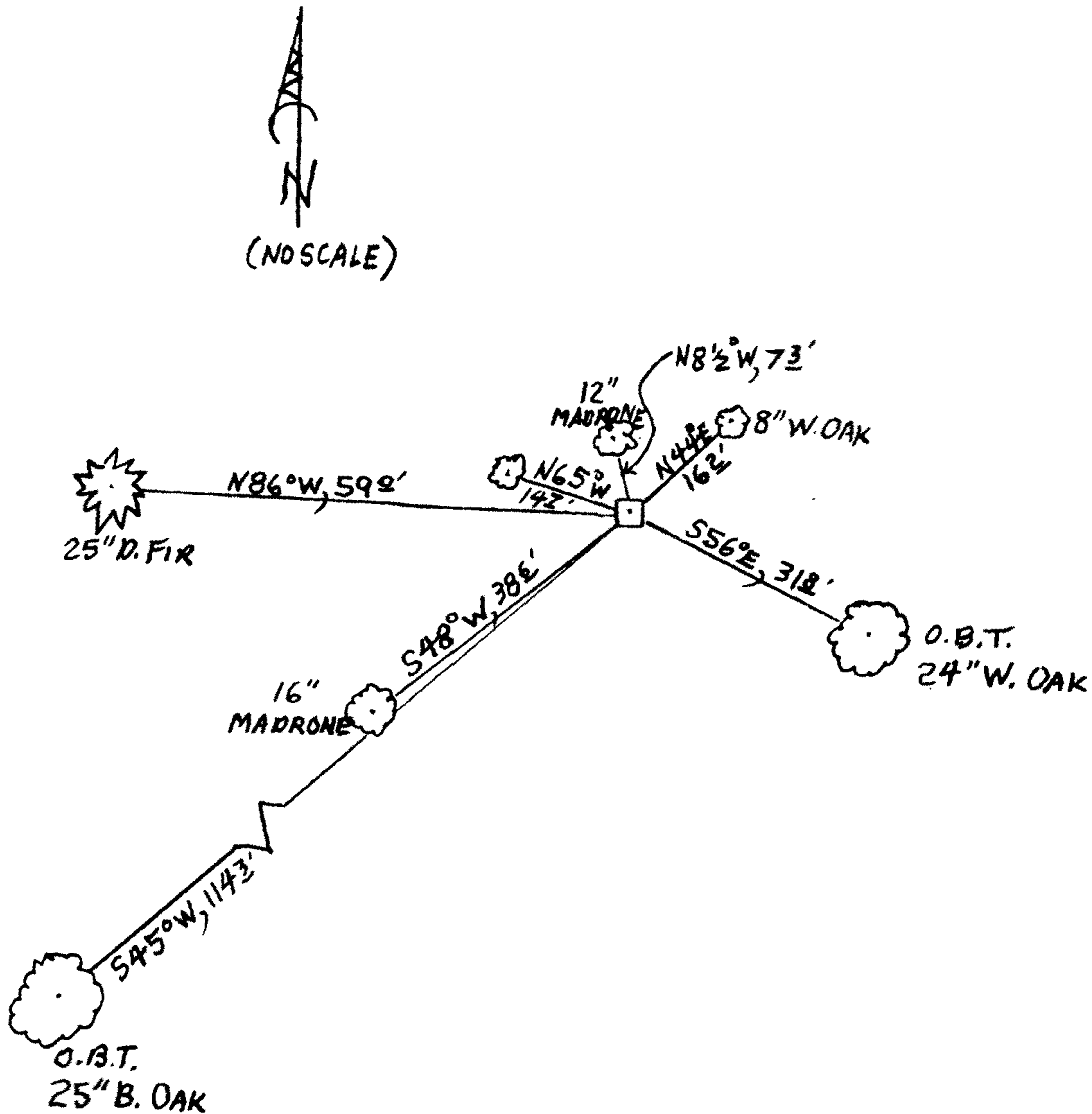

Location & Comments

MONUMENT IS ON FLAT GROUND NEAR SUMMIT OFF BROAD HIGH RIDGE APPROX. 75 FEET WEST FROM A N-S FENCELINE AND IN A MIXED FOREST OF OAK, MADRONE AND FIR.

Comp. Declin. 15 1/2° E
Agency DC SO
Party Chief STEPHEN JOHN FLAUSE
Notekeeper Stephen John Flause
Witnesses MIKE S. KOCH

Address

Surveyor's Seal

REGISTERED PROFESSIONAL LAND SURVEYOR

Handwritten signature and date: Randall W. Smith 6-30-2012

OREGON
JULY 25, 1990
RANDALL W. SMITH
2400