

GOVERNMENT CORNER RESTORATION FORM

Date: 10-2-2012 By: JC

Township 32 S Range 01 W Sec. 15

County DOUGLAS This survey consists of:

State OREGON Date SEPT. 11, 2012

No. 400400 Narrative: \_\_\_\_\_

Corner Rpt: CS 67/36-23

Corner Designation

S16	S15
S21	S22

DOUGLAS COUNTY

- Condition Survey Only
- Not Found
- Renewed
- Unrecorded
- Surveyed In
- Referenced Out

MONUMENT DETAIL

Previous Renewals BLM 1955, DCSO 1974

Monument(s) Found: (Condition and Source)

NO EVIDENCE OF ORIGINAL STONE FOUND FROM THE 1955 BLM DEPENDENT RESURVEY  
A 2 1/2 INCH DIAM. BRASS CAP (MARKED AS AT UPPER RIGHT) ON A 2 INCH I. D. X 36 INCH LONG CONCRETE FILLED, IRON PIPE IS FOUND LOOSE ON GROUND SURFACE IN A SKID ROAD CUT-BANK SLIDE WITH NO DISCERNIBLE POSITION.

FROM THE 1974 DCSO RENEWAL A REFERENCE MONUMENT (WITNESS COR. PER DCSO 1974) IS FOUND. A 2 1/2 INCH DIAM. BRASS CAP (MARKED AS AT LOWER RIGHT) ON A 1 INCH I. D. IRON PIPE FIRMLY, AND PLUMBLY SET, PROTRUDING 6 INCHES ABOVE GROUND.

Accessories Found:

U. S. GENERAL LAND OFFICE SURVEY  
 T32S R1W  
 S16 | S15  
 S21 | S22  
 1955

COUNTY SURVEYORS OFFICE  
 T32S R1W  
 WIT. COR.  
 S16 | S15  
 S21 | S22  
 30 FT. SOUTH TO COR.  
 1974

FROM THE 1955 RESURVEY CORNER POSITION, AS DETERMINED FROM THE ABOVE FOUND REFERENCE MONUMENT, EVIDENCE OF ONE 1955 RENEWAL BT IS FOUND; ALL OTHER BT'S WOULD HAVE BEEN CUT-BANK SLIDE.  
A FIR 13" DIA. NOW A 2.3 INCH DIAMETER DOUGLAS FIR WITH A FULLY HEALED DOUBLE BLAZE; BEARS N59 3/4° E, 24 1/2 FEET DISTANT (AS PER RECORD).

FROM THE LOCATION OF THE 1974 REFERENCE MONUMENT THE TWO BEARING TREES ESTABLISHED TO WITNESS THIS POSITION ARE FOUND.  
A 13" D. FIR NOW A 20 INCH DIAMETER DOUGLAS FIR WITH A FULLY HEALED DOUBLE BLAZE; BEARS N82° W, 9° FEET DISTANT (AS PER RECORD).  
A 36" D. FIR NOW A 36 INCH DIAMETER DOUGLAS FIR WITH A FULLY HEALED DOUBLE BLAZE; BEARS N51 1/2° E, 55 1/2 FEET DISTANT (RECORD N53° E, 55 1/2 FT.).

RENEWAL

Monument Set (Procedure and Description)

Monument Detail

N/A

USING THE FOUND 1974 REFERENCE MONUMENT AND THE ONE FOUND 1955 RESURVEY BEARING TREE THE LOCATION OF THE 1955 CORNER MONUMENT IS DETERMINED. THE MONUMENT POSITION FALLS IN HARD BEDROCK IN A STEEP CUT-BANK. THE 1955 B.C./I.P. MONUMENT CANNOT BE SET HERE; INSTEAD A 1 1/2 INCH LONG "MAG" NAIL WITH A 9/16 INCH DIAMETER TOP IS DRIVEN PERPENDICULARLY INTO THE BEDROCK TO BE LEFT PROTRUDING APPROXIMATELY 1/2 INCH AND HAVE ITS TOP CENTER AT THE CORNER POSITION.

THE 1955 BC/I.P. MONUMENT IS LAIN HORIZONTALLY ON GROUND NEXT TO THE REFERENCE MONUMENT BC/I.P. (COULD BE RESET AT TRUE CORNER POSITION IN FUTURE).

New Accessories

(THESE ACCESSORIES REFERENCE THE "MAG" NAIL POSITION I.E. THE 1955 RESURVEY SECTION CORNER).

A 2.5 INCH DIAMETER DOUGLAS FIR SCRIBED "T32.SRIW.S15CS" "BT" ON A DOUBLE BLAZE; BEARS N 35 1/2° E, 390 FEET DISTANT.

A 5 INCH DIAMETER DOUGLAS FIR MARKED "X" "BT" ON A HIGH-LOW BLAZE; BEARS N 78 1/4° W, 18 1/2 FEET DISTANT.

Sketch of Monument, Accessories, and General Area

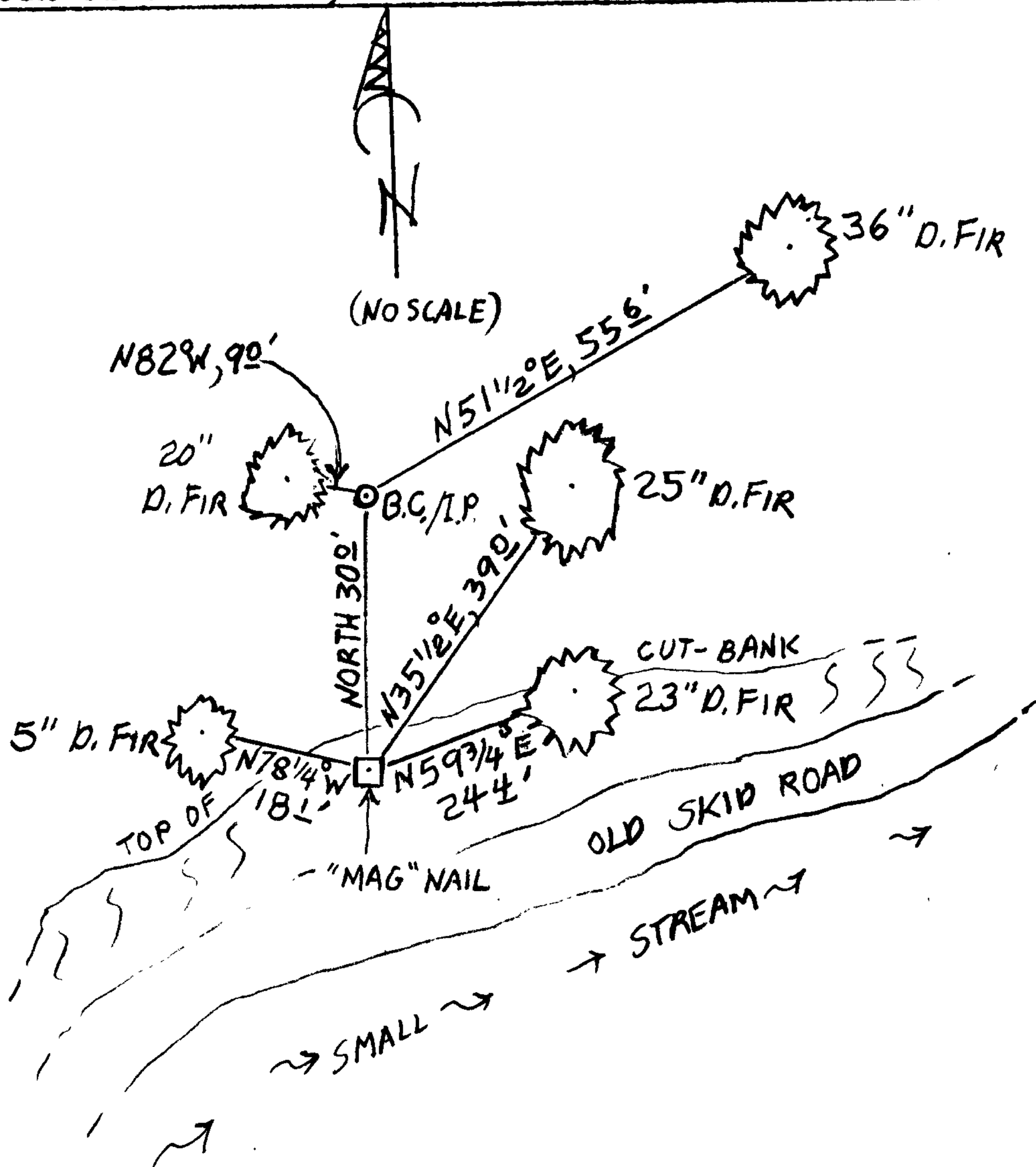

Location & Comments

CORNER FALLS NEAR BOTTOM OF STEEP SOUTHEAST SLOPE IN CUT-BANK OF AN OLD SKID ROAD RUNNING NORTHEASTERLY FOLLOWING NEAR THE BOTTOM OF A SMALL STREAM CANYON ALSO RUNNING NE'LY.

Comp. Declin. 15 1/2° E

Agency DCSD

Party Chief STEPHEN JOHN FLAUSE

Notekeeper Stephen John Flause

Witnesses MIKE S. KOCH

Address

Surveyor's Seal REGISTERED PROFESSIONAL LAND SURVEYOR

Handwritten signature of Randall W. Smith

OREGON JULY 25, 1990 RANDALL W. SMITH 2400

Lowman 6-30-2013