

GOVERNMENT CORNER RESTORATION FORM

FILED

Date: 7/31/2012 By: JC

This survey consists of:

Township 26S Range 3W Sec. 34 County DOUGLAS Map: \_\_\_\_\_

State OREGON Date JULY 19, 2012 No. 500120 Narrative: \_\_\_\_\_  
Control File: CS 67/36-18

Corner Designation

S 1/16  
534 | 535

DOUGLAS COUNTY  
SURVEYOR

Condition Report Only

Not Found

Renewed

Unrecorded

Surveyed In

Referenced Out

MONUMENT DETAIL

Previous Renewals ESTB. 1975, B.L.M. RENEWAL 1981

Monument(s) Found: (Condition and Source)

ORIGINAL MONUMENT SET BY BAUGHMAN IN 1975; A 2 1/2 INCH DIAMETER BRASS CAP (MARKED AS AT RIGHT) ON A 1 1/4 INCH O.D. IRON PIPE, FIRMLY SET BUT NO LONGER PLUMB. MONUMENT IS IN REMAINS OF SMALL MOUND OF STONE, OTHER STONES SCATTERED NEARBY. WE INVESTIGATE AND FIND UPPER 16 INCHES OF I.P. IS SEVERLY BENT RESULTING IN B.C. BEING APPROX. S 27 1/2° E, 0.8 FEET FROM THE PLUMB MONUMENT POSITION.

T26S R3W

S 1/16

534 | 535

RLS 536

1975

Accessories Found:

ACCESSORIES ARE MEASURED FROM PLUMB POSITION OF FOUND MONUMENT. OUR COMPASS READINGS INDICATE A POSSIBLE LOCAL ATTRACTION OF ≈ 2 1/2° WEST FROM TRUE NORTH. WE ADJUST BEARINGS TO B.L.M.'S TRUE BASIS.

AN ORIGINAL 8" CEDAR NOW A 13 INCH DIAMETER INCENSE CEDAR WITH A FAIRLY HIGH, FULLY HEALED, SINGLE BLAZE; BEARS S 85 3/4° E, 18.5 FEET DISTANT (AS PER B.L.M. RECORD, ORIGINAL BAUGHMAN RECORD EAST, 18.6 FT.)

AN ORIGINAL 10" D. FIR NOW A 16 INCH DIAMETER DOUGLAS FIR WITH A FAIRLY HIGH, FULLY HEALED, SINGLE BLAZE; BEARS S 04 3/4° E, 40.9 FEET DISTANT (AS PER B.L.M. RECORD, ORIGINAL BAUGHMAN RECORD S 6° E, 41 FT.)

FROM BAUGHMAN MAP (DCSO FILE C.S. 58/36-2) DETAIL B, A 1/2" IRON ROD NOW 1/2 INCH DIAMETER IRON ROD FIRMLY SET WITH TOP PROTRUDING 6 INCHES ABOVE GROUND; BEARS WEST, 14.5 FEET DISTANT (AS PER ORIG.). TOP OF ROD IS BENT WST'LY ≈ 0.2 FEET BUT MAY HAVE BEEN ORIGINALLY SET THUS.

THE 1981 B.L.M. RENEWAL TREE IS FOUND. A FIR 8 INS. DIAM. NOW A 15 INCH DIAMETER DOUGLAS FIR WITH A LOW FULLY HEALED SINGLE BLAZE; BEARS S 63 1/4° W, 34 3/8 FEET DISTANT (AS PER RECORD).

A STEEL FENCE POST IS FOUND, FIRMLY SET, PROTRUDING 4 FEET ABOVE GROUND, SOUTH 1 FOOT FROM B.C. MONUMENT (NO RECORD; SET BY PROPERTY OWNER?)

C.S. File No 67/36-18

RENEWAL

Monument Set (Procedure and Description)

Monument Detail

N/A

ALL FOUND ACCESSORIES INDICATE PLUMB POSITION OF FOUND MONUMENT IS GOOD. WE REFERENCE OUT PLUMB POSITION OF MONUMENT AND REMOVE IT FROM GROUND. 1 1/4 INCH D.D. IRON PIPE MEASURES 30 INCHES LONG AND IS FLARED AT BOTTOM. WE STRAIGHTEN IRON PIPE AND THEN RETURN B.C./I.P. MONUMENT TO ITS ORIGINALLY SET PLUMB POSITION.

B.C. MONUMENT IS NOW FLUSH IN TOP OF ≈ 2 FOOT DIAMETER LOOSE MOUND OF STONE WHICH IS ROUGHLY LEVEL WITH SURROUNDING GROUND.

New Accessories

FOUND STEEL FENCE POST WAS REMOVED WHILE REPOSITIONING BC/IP MONUMENT. THIS 6 FOOT LONG POST IS NOW FIRMLY SET PROTRUDING 4 FEET ABOVE GROUND APPROX. 2 FEET NORTH FROM SAID MONUMENT.

Sketch of Monument, Accessories, and General Area

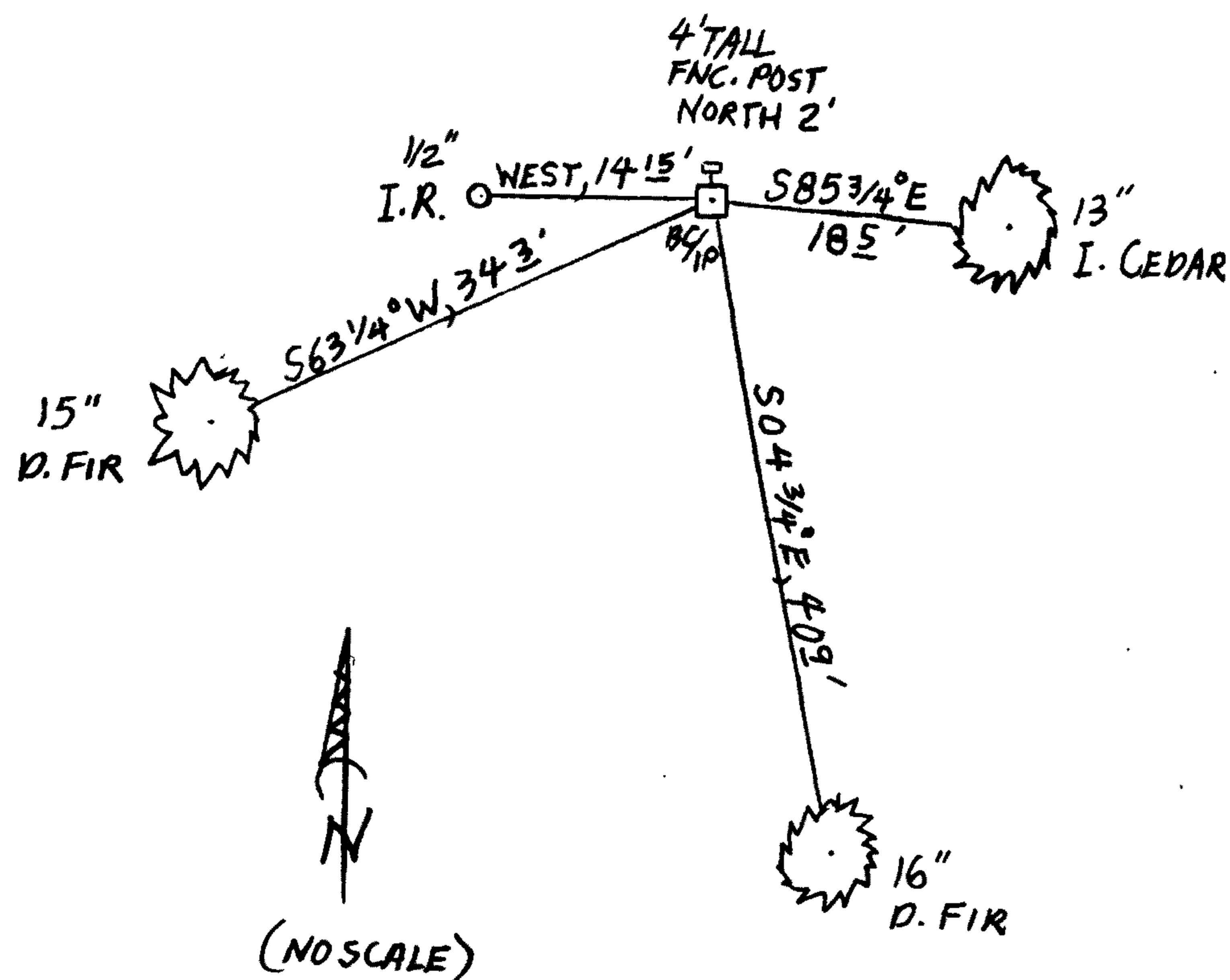

Location & Comments

MONUMENT IS ON A GENTLY WESTERLY SLOPING BENCH LAND ON EAST SIDE OF LITTLE RIVER DRAINAGE. BENCH IS FORESTED WITH AN OPEN STAND OF MIXED FIR, CEDAR AND PINE.

Comp. Declin. 15 1/2° E  
Agency DCSO  
Party Chief STEPHEN JOHN FLAUSE  
Notekeeper Stephen John Flause  
Witnesses DENNIS D. LEE

Address

Surveyor's Seal

REGISTERED PROFESSIONAL LAND SURVEYOR

*Handwritten signature*  
JUL 26 - 6 - 30 - 2013

OREGON  
JULY 25, 1990  
RANDALL W. SMITH  
2488