



RENEWAL

Monument Set (Procedure and Description)

Monument Detail

MONUMENT IS RETURNED TO A FIRMLY SET PLUMB  
CONDITION AND NOW PROTRUDES 8 INCHES ABOVE  
GROUND.

N/A

New Accessories

N/A FOUND ACCESSORIES ARE TAGGED AND FLAGGED.

Sketch of Monument, Accessories, and General Area

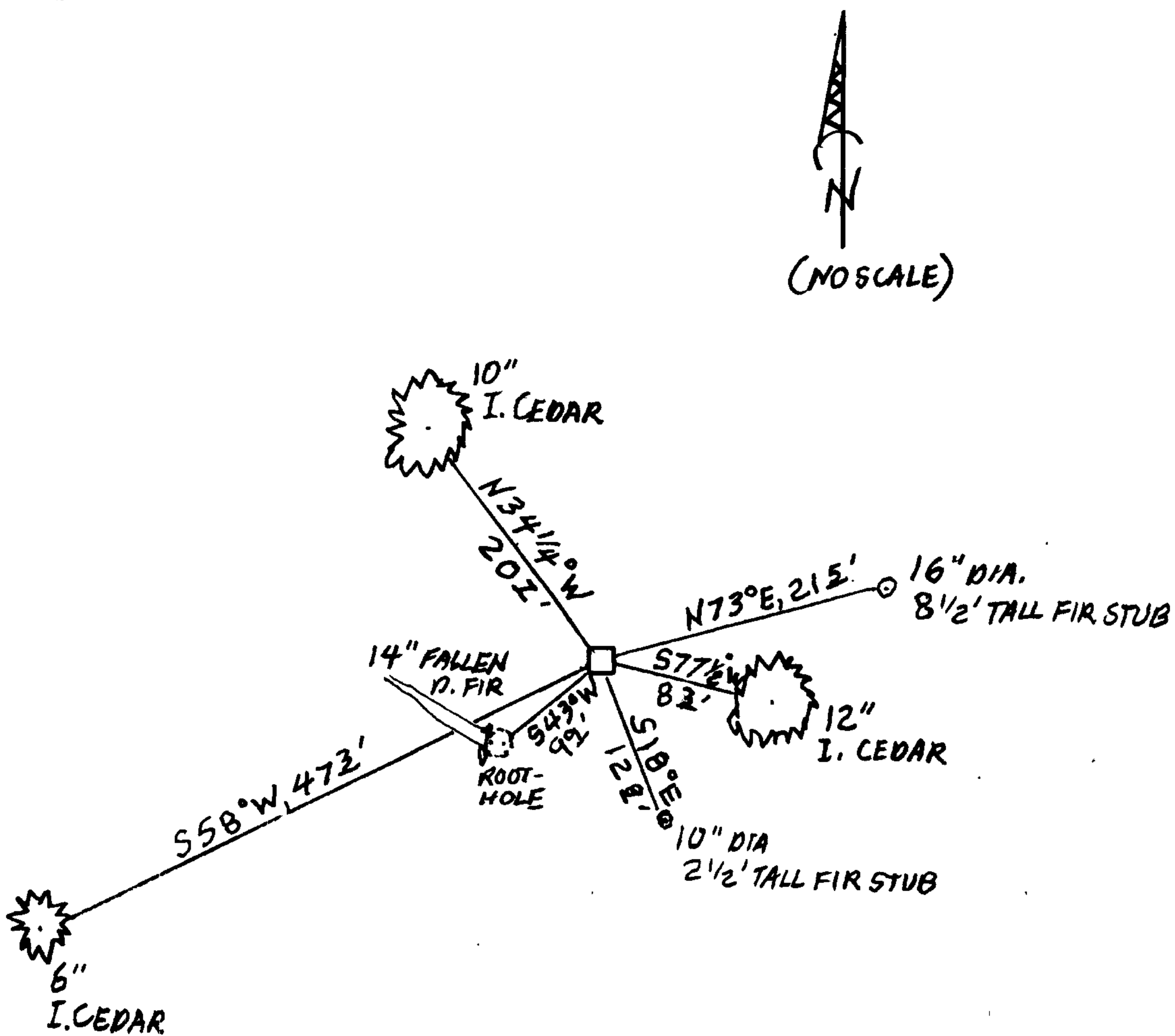

Location & Comments

MONUMENT IS ON STEEP WNW SLOPE  
ON SOUTH SIDE OF RATTLESNAKE  
CREEK FORESTED WITH STUNTED  
CEDAR, PINE AND FIR.

Comp. Declin. 15 1/2° E

Agency DCSO

Party Chief STEPHEN JOHN FLAUSE

Notekeeper Stephen John Flause

Witnesses

M. S. KOCH AND D. D. LEE

Address

Surveyor's Seal

REGISTERED  
PROFESSIONAL  
LAND SURVEYOR

*Randall W. Smith*

JULY 25, 1900

RANDALL W. SMITH  
2400

6-30-2013