

GOVERNMENT CORNER RESTORATION FORM

FILED

Date: 7/26/2012 By: JC

This survey consists of:

Township 27S Range 03W Sec. 1

County DOUGLAS

State OREGON

Date JULY 9, 2012

No. 600660

Map:

Narrative:

Corner Rpt: CS 67/36-16

Corner Designation

N 1/16  
S2 | S1

DOUGLAS COUNTY

- Condition Report Only
- Not Found
- Renewed
- Unrecorded
- Surveyed In
- Referenced Out

MONUMENT DETAIL

Previous Renewals SRVD. IN 1936, SRVD. IN 1987

Monument(s) Found: (Condition and Source)

FROM 1987 SURVEY (FILED IN DCSD AS SURVEY M103-61) A 2 1/2 INCH DIAMETER ALUMINUM CAP (MARKED AS A RIGHT) ON A 1 INCH O.D. IRON PIPE PROTRUDING 8 INCHES FIRMLY SET BUT LEANING ≈ S50°W, 0 3/4 FEET.

ALL FOLLOWING BEARING AND DISTANCE MEASUREMENTS ARE FROM PLUMB POSITION OF ABOVE FOUND MONUMENT.

A FOUND 1" IRON ROD FROM THE 1987 SURVEY WE FIND TO BE THE 1 INCH DIAMETER THREADED TOP OF A LONG STEEL ROCK DRILL PROTRUDING ≈ 1 INCH ABOVE GROUND. THE TOP SEVERAL INCHES OF THIS FOUND DRILL IS BENT AND LEANING ≈ S40°W, 0 3/4 FEET (WE MEASURE TO PLUMB POSITION). FROM ABOVE FOUND ALU./IR. MONUMENT THIS DRILL MON. BEARS S29 1/2°E, 14 9/16 FEET DISTANT (RECORD S25°E, 14 5/16 FEET). SOURCE UNKNOWN, MAY MONUMENT 1936 COR. POSITION.

Accessories Found:

WE SEARCH FOR 1936 ACCESSORIES FROM FOUND DRILL STEEL BUT FIND NO DEFINITIVE EVIDENCE.

EVIDENCE FOR THE TWO 1987 BEARING TREES IS FOUND  
A 19" FIR NOW A 2 1/2 INCH DIAMETER 1 1/2 FOOT TALL SAWN FIR STUMP WITH A FRAGMENT OF A HEALED UPPER BLAZE AND A FULLY HEALED LOWER BLAZE; BEARS S44°E, 9 5/16 FEET DISTANT (AS PER RECORD).

A 16" FIR NOW A 2 INCH DIAMETER 2 FOOT TALL SAWN FIR STUMP (BLAZES AS ABOVE); BEARS S73°W, 30 3/4 FEET DISTANT (AS PER RECORD).

N 1/16  
S2 | S1  
1987  
PLS 1988  
DO NOT DISTURB

C.S. File No 67/36-16

RENEWAL

Monument Detail

Monument Set (Procedure and Description)

MONUMENT IS RETURNED TO PLUMB POSITION AND IS NOW FIRMLY SET PROTRUDING 6 INCHES ABOVE GROUND.

N/A

New Accessories

A 5 INCH DIAMETER D. FIR SCRIBED "X" "BT" ON A HIGH-LOW BLAZE; BEARS N44°E, 6± FEET DISTANT.

A 6 INCH DIAMETER D. FIR SCRIBED "N 1/16 S 2 C S" "BT" ON A DOUBLE BLAZE; BEARS S76°W, 17± FEET DISTANT.

Sketch of Monument, Accessories, and General Area

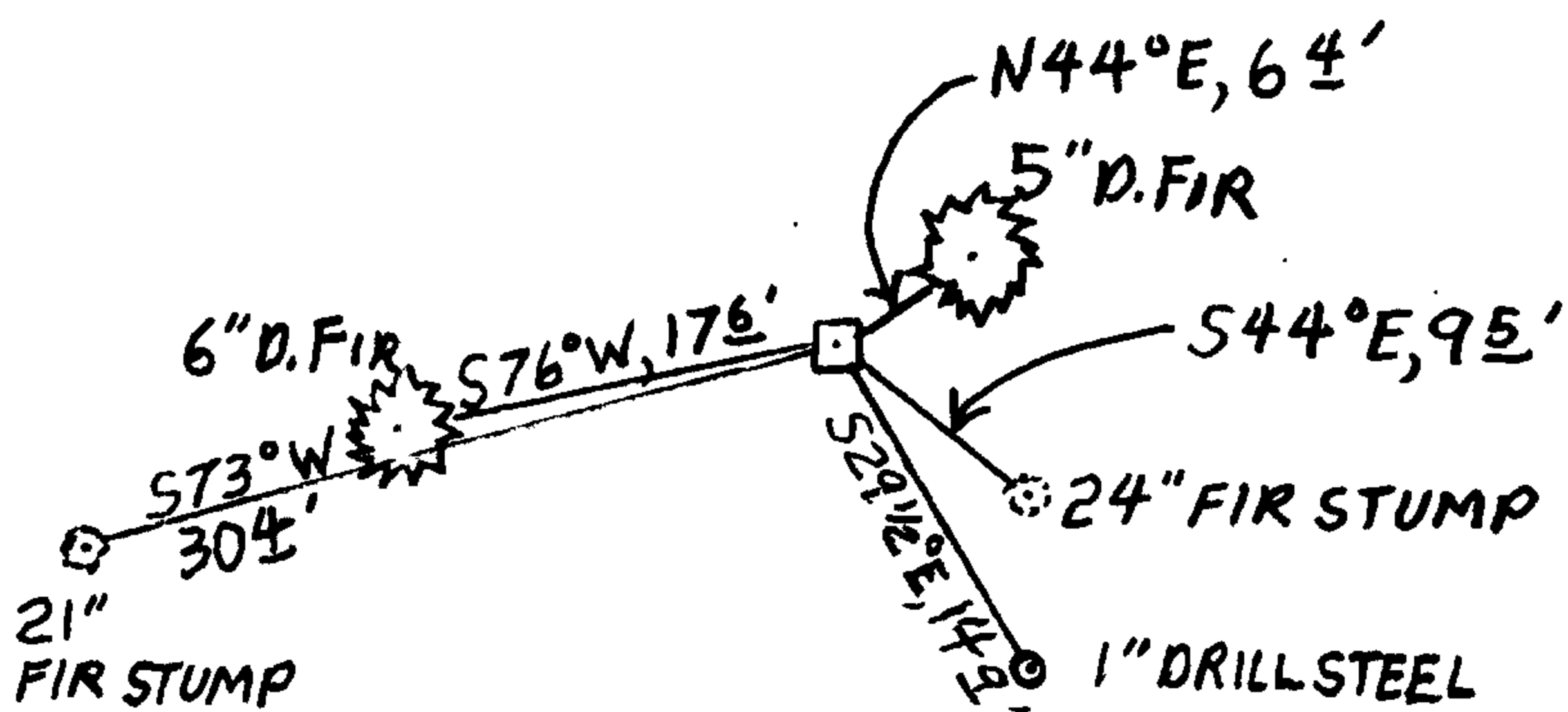
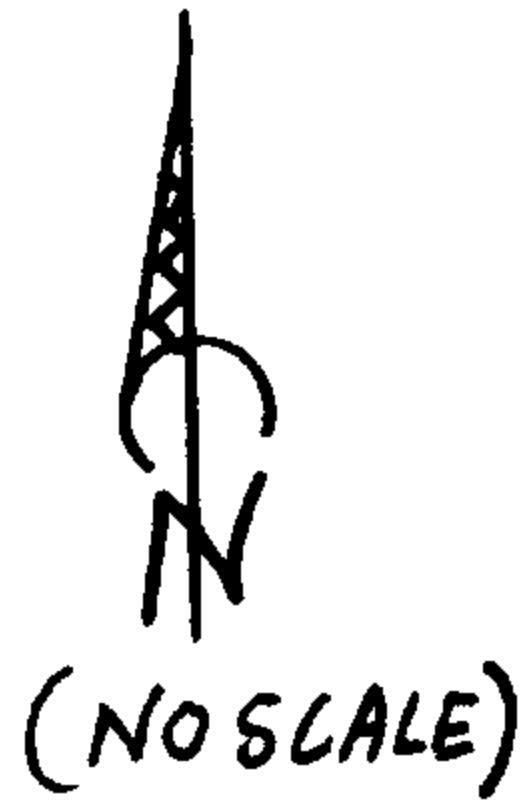

Location & Comments

MONUMENT IS ON GENTLE WESTERLY SLOPE IN STAND OF ≈ 20 YEAR OLD REPROP. DOUGLAS FIR.

A LIGHT STEEL FENCE POST IS SET PROTRUDING 4 FEET ABOVE GROUND ≈ 3 FEET NORTH FROM ALC./LR. MONUMENT.

Comp. Declin. 15 1/2° E

Agency DCSO

Party Chief STEPHEN JOHN FLAUSE

Notekeeper Stephen John Flause

Witnesses MIKE S. KOCH

Address

Surveyor's Seal

REGISTERED  
PROFESSIONAL  
LAND SURVEYOR

*Randall W. Smith*  
FORWARD 6-30-2013

OREGON  
JULY 25, 1990  
RANDALL W. SMITH  
2489