

FILED

GOVERNMENT CORNER RESTORATION FORM

Date: 6/25/2012 P.y. JC

This survey consists of:

Township 23S Range 05W Sec. 04

County DOUGLAS Map:

State OREGON Date JUNE 19, 2012

No. 040030

Narrative: \_\_\_\_\_  
Corner Rpt. 67/36-14

Corner Designation SWCOR-DLC 40

DOUGLAS COUNTY  
SURVEYOR

- \_\_\_\_\_ Condition Report Only
- \_\_\_\_\_ Not Found
- Renewed
- \_\_\_\_\_ Unrecorded
- \_\_\_\_\_ Surveyed In
- \_\_\_\_\_ Referenced Out

MONUMENT DETAIL

Previous Renewals 1967, 1975 AND 1977, 1979, 1987

Monument(s) Found: (Condition and Source)

A STONE PROTRUDING APPROX. 2 INCHES ABOVE GROUND (AT HIGHEST POINT) AND MEASURING APPROX. 12 X 14 INCHES AT GROUND SURFACE; HAS NO DIS-CERNABLE MARKINGS. (RECOGNIZED AS ORIG. MON.)

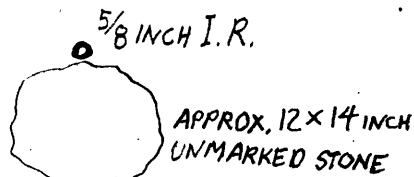

FROM THE 1967 RENEWAL A 5/8 INCH DIAM. I.R. FIRMLY SET AND PROTRUDING 6 INCHES ABOVE GROUND IS SET ON NORTH EDGE OF ABOVE FOUND STONE MON. AND BEARS NORTH, 0.7 FEET FROM STONES CENTER.

Accessories Found:

BEARING AND DIST'S. FROM TOP CENTER OF STONE MON.

NO B.T.'S SET IN ORIGINAL SURVEY.

EVIDENCE OF ONE 1975 RENEWAL TREE FOUND. A 32" D. FIR NOW A MOSTLY ROTTEN AWAY DOUGLAS FIR STUMP WITH SOME PERIMETER BARK STANDING (DIAM WAS 30+ INCH) HAS NO REMAINING SCRIBING OR BLAZE EVIDENCE AND BEARS N74°E, 11 1/2 FEET DISTANT (AS PER RECORD). NW B.T. NOW IN CLEARED FIELD NO EVIDENCE REMAINS.

EVIDENCE OF THE 1979 ADDED RENEWAL B.T. FOUND.

A 14" MADRONE NOW A 25 INCH D.B.H. MADRONE WITH NO VISIBLE SCRIBE MARKS (BUT HAS ALUMINUM B.T. TAG WITH 20+ YEARS OF TREE GROWTH PARTIALLY COVERING SAME); BEARS N34°E, 46 1/2 FEET DISTANT (AS PER 1987 CORRECTED RECORD).

EVIDENCE OF THE 1987 ADDED RENEWAL B.T. FOUND.

A 26" DIA., 4 FT HIGH D. FIR STUMP WITH BOAT SPIKE AND B.T. TAG, NOW AN ALMOST COMPLETELY ROTTEN AWAY D. FIR STUMP (DIAM WAS 26 INCHES) WHICH IS NOW MISSING BOAT SPIKE AND TAG; BEARS WEST, 11 1/2 FEET DISTANT (AS PER RECORD).

C.S. File No 67/36-14

RENEWAL

Monument Set (Procedure and Description)

Monument Detail

MONUMENT IS FIRMLY SET AND UNDISTURBED WE ACCEPT AS FOUND.

N/A

New Accessories BEARINGS AND DIST'S. FROM TOP CENTER OF STONE MONUMENT.

A 10x26 FOOT CONCRETE SLAB M/L FLUSH WITH GROUND WHICH CONTAINS THE GEORGE CUTLACK FAMILY BURIAL PLOT; THE SOUTHWEST CORNER OF WHICH BEARS N38°E, 59' FEET DISTANT.

A 49 INCH D.B.H. DOUGLAS FIR (DOUBLE TRUNKED 10 FEET ABOVE GROUND) SCRIBED "SW DLC 40CS" "BT" ON A DOUBLE BLAZE; BEARS N78°E, 49' FEET DISTANT.

Sketch of Monument, Accessories, and General Area

Location & Comments

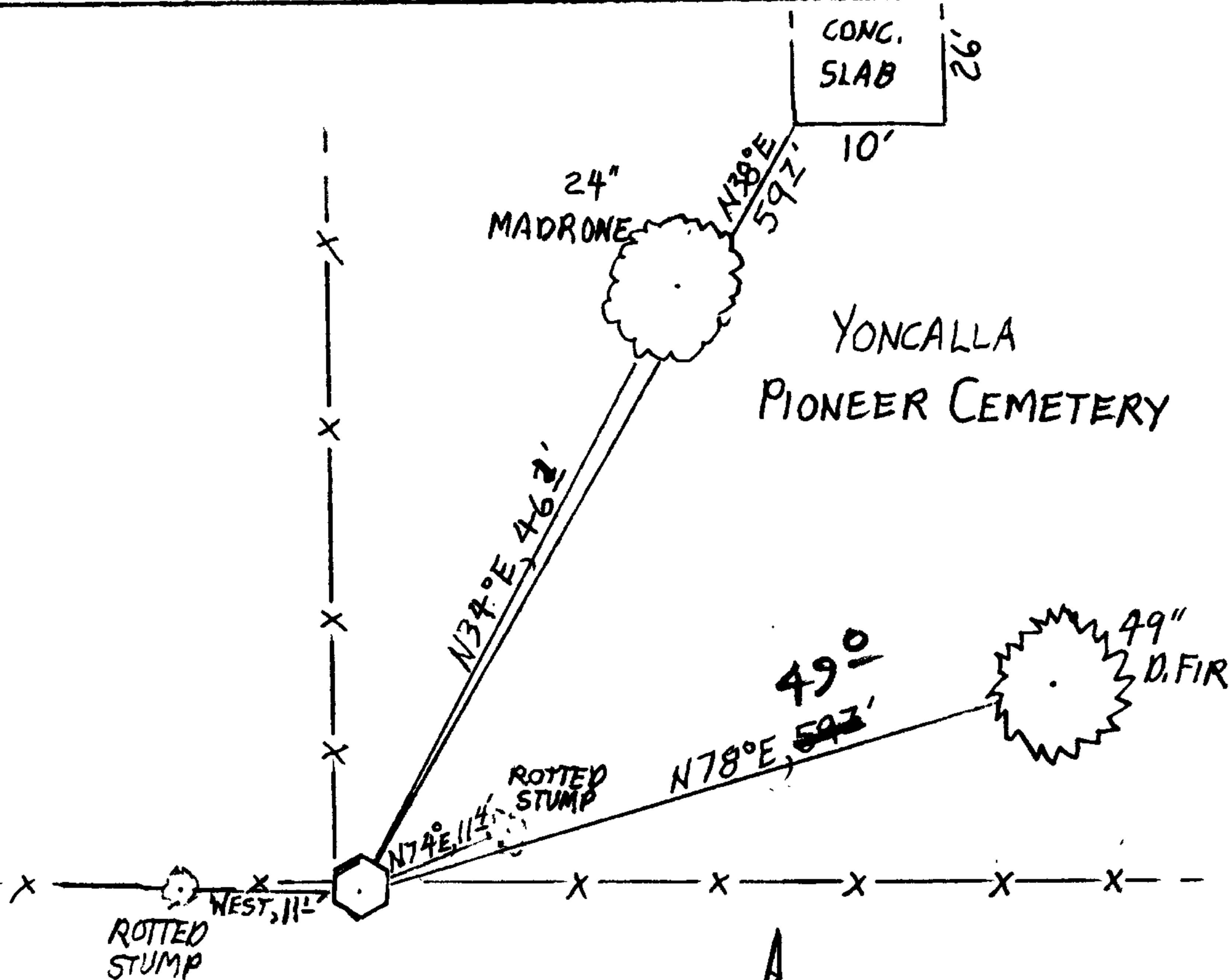

MONUMENT IS NEAR TOP OF GENTLE SOUTH SLOPE AND THE SOUTHWEST CORNER OF YONCALLAS PIONEER CEMETERY WHERE FENCES RUN E-W AND NORTH.

Comp. Declin. 15 3/4° E
Agency DCSD
Party Chief STEPHEN JOHN FLAUSE
Notekeeper Stephen John Flause
Witnesses M. S. KOCH

Address

Surveyor's Seal

REGISTERED PROFESSIONAL LAND SURVEYOR

Renewal 6-30-2014

OREGON JULY 25, 1990 RANDALL W. SMITH 2480