

GOVERNMENT CORNER RESTORATION FORM

FILED

Date: 6/14/2012 By: JC
This survey consists of:

Township 27S Range 07W Sec. 01 County DOUGLAS Map: _____
State OREGON Date JUNE 8, 2012 No. 640600 Narrative: _____
Corner Rpt: CS 67/36-8

Corner Designation

$\frac{1}{4} \frac{S1}{S12}$

DOUGLAS COUNTY
SURVEYOR

- Condition Report Only
- Not Found
- Renewed
- Unrecorded
- Surveyed In
- Referenced Out

MONUMENT DETAIL

Previous Renewals 1922, (NOT FOUND 1969)

Monument(s) Found: (Condition and Source)

N/A

FROM THE 1922 RENEWAL, A 5/8 INCH DIAM. 14 1/2 INCH LONG, SMOOTH IRON ROD (NOW RUST PITTED) SET PLUMB AND FLUSH WITH SURFACE (RECORD A 1/2" IRON BAR).

Accessories Found:

POSSIBLE EVIDENCE OF N.W. O.B.T.; AN APPARENT ROOT CROWN DEPRESSION BEARS REASONABLY CLOSE TO N56°W, 6.5 FEET DISTANT (AS PER RECORD).

GOOD EVIDENCE OF N.E. 1922 RENEWAL B.T.; A CLEAR ROOT CROWN DEPRESSION THE NEAR CENTER OF WHICH, BEARS N52 1/2°E, 14'-DISTANT (AS PER RECORD).

NO EVIDENCE OF OTHER O.B.T.'S OR RENEWAL B.T.'S FOUND

C.S. File No 67/36-8

RENEWAL

Monument Set (Procedure and Description)

Monument Detail

THE FOUND MONUMENT POSITION WHICH FOLLOWED FROM FOUND ORIGINAL BEARING TREE EVIDENCE IN 1922 AND HAS BEEN VERIFIED IN MANY SUBSEQUENT SURVEYS IS ACCEPTED.

THE FOUND 5/8 INCH DIAM. IRON ROD POSITION IS REFERENCED OUT AND THE MONUMENT IS REMOVED FROM GROUND. AT THE REFERENCED POSITION IS SET A 2 1/2 INCH DIAM. BRASS CAP (MARKED AS AT RIGHT) ON A 1 INCH I.D. X 30 INCH LONG GALVANIZED IRON PIPE PROTRUDING APPROX. 4 INCHES ABOVE GROUND. THE FOUND 1922 MONUMENT IS SET ON THE NORTH EDGE OF THE ABOVE SAID B.C. MONUMENT AND NOW PROTRUDES APPROX 2 1/2 INCHES ABOVE GROUND.

DOUGLAS COUNTY SURVEYOR
 T275
 R7W
 1/4 S1
 S12
 2012

A 2 INCH WIDE GALVANIZED STEEL MARKER POST IS SET 0.5 FEET NORTH FROM B.C. MONUMENT AND PROTRUDES APPROX. 4 FEET ABOVE GROUND.

New Accessories

- A 12 INCH D.B.H. WHITE OAK SCRIBED "1/4 S1CS" "BT" ON A DOUBLE BLAZE; BEARS N42 1/4° E, 272 FEET DISTANT.
- A 7 INCH D.B.H. WHITE OAK SCRIBED "1/4 S12CS" "BT" ON A DOUBLE BLAZE; BEARS S40 1/2° E, 26 1/2 FEET DISTANT.
- AN 11 INCH D.B.H. MADRONE SCRIBED "1/4 S12CS" "BT" ON A DOUBLE BLAZE; BEARS S36 1/2° W, 30 3/4 FEET DISTANT.
- A 46 INCH D.B.H. BLACK OAK SCRIBED "1/4 S1CS" "BT" ON A DOUBLE BLAZE; BEARS N78 1/2° W, 31 1/2 FEET DISTANT.

Sketch of Monument, Accessories, and General Area

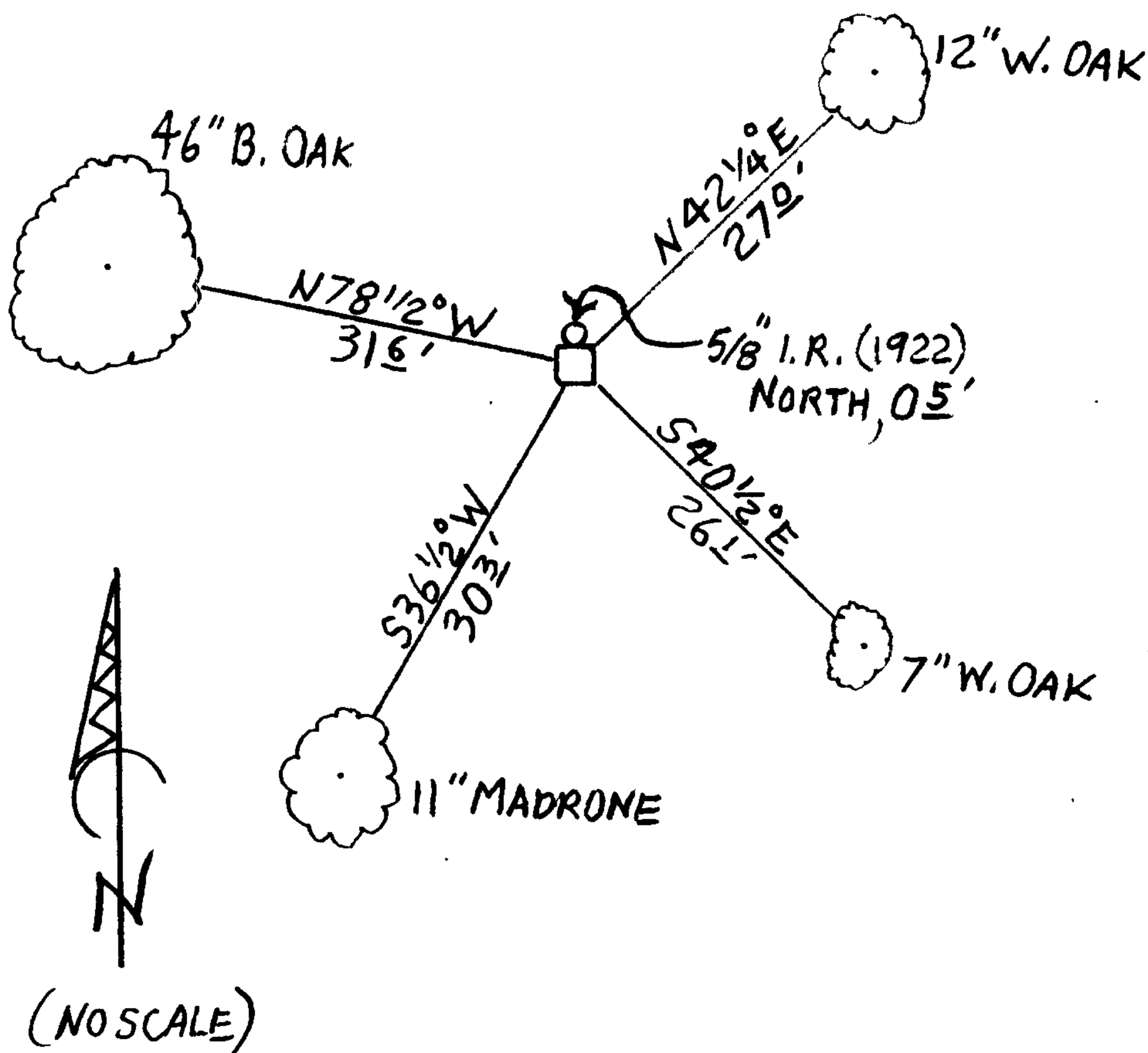

Location & Comments

MONUMENT IS ON GENTLE N.W. SLOPE NEAR TOP OF KNOB HILL COVERED WITH AN OPEN OAK, MADRONE AND PINE WOODS.

MONUMENT IS APPROX. N10° E, 400 FEET FROM A LARGE COMMUNITY WATER TANK.

Comp. Declin. 15 1/2° E
 Agency DC50
 Party Chief STEPHEN JOHN FLAISE
 Notekeeper Stephen John Flaize
 Witnesses M.S. KOCH

Address

REGISTERED
 PROFESSIONAL
 LAND SURVEYOR

Renewed by Surveyor Seal
 RENEWAL 6-30-2012

OREGON
 JULY 25, 1980
 RANDALL W. SMITH
 2488