

FILED

Date: 6/20/2014 By: NW
This survey consists of:
Map: CS 67/35-9A-C
Narrative: _____
Corner Rpt: _____

Douglas County Official Records
Patricia K. Hitt, County Clerk

2014-006762



\$46.00

00369118201400067620030035

05/14/2014 10:15:01 AM

VAC-NSVAC Cnt=1 Stn=17 ROBIN
\$15.00 \$11.00 \$20.00

DOUGLAS COUNTY
SURVEYOR

ORDINANCE NO. 3428

**AN ORDINANCE VACATING THE STEPHENS/GRANDVIEW ALLEYWAY BETWEEN
IMBLER AVENUE AND NEUNER DRIVE IN THE CITY OF ROSEBURG**

WHEREAS, pursuant to Roseburg Municipal Code Chapter 4.06, upon receipt of a report from the Community Development Department, the City Recorder initiated proceedings to vacate the Stephens/Grandview Alleyway between Imbler Avenue and Neuner Drive, in the City of Roseburg, more particularly described in Section 1 of this ordinance and shown on the map attached hereto as Exhibit "A" of this ordinance; and

WHEREAS, the City Recorder published a notice of a public hearing on the proposed vacation to be held before the Roseburg City Council on March 24, 2014, in The News-Review, a newspaper of general circulation in the City of Roseburg, Oregon, on March 9 and 16, 2014, posted said notice at or near each end of the vacation area and mailed the same to all affected property owners, not less than 14 days prior to the date of the hearing, all of which more fully appear in the proof of publication, posting and mailing on file in the City Recorder's Office; and

WHEREAS, such public hearing was duly held before the Roseburg City Council on the above-mentioned date, and all persons desiring to be heard on said matter were heard;

NOW, THEREFORE, THE CITY OF ROSEBURG ORDAINS AS FOLLOWS:

Section 1. The Stephens/Grandview Alleyway between Imbler Avenue and Neuner Drive, as shown on County Assessor's Map as Township 27S, Range 05W, Section 18BC, and more particularly described as follows, is hereby vacated:

The entire 20 foot wide alley platted in Block 8 of Jones' Addition to Roseburg, according to the official plat thereof in Douglas County, Oregon, more particularly described as follows:

Beginning at the most Easterly corner of Lot 12, Block 8 in said Jones' Addition to Roseburg; thence 24° 14' West 300.00 feet to the most Northerly corner of Lot 7 in said Westerly corner of Lot 6 in said Block 8, Jones' Addition to Roseburg; thence South 24° 14' East 300.00 feet to the most Southerly corner of Lot 1 in said Block 8; thence South 65° 46' West 20.00 feet to the point of beginning.

Section 2. The title to the property being vacated by this ordinance shall attach to the lands bordering on such equal portions in accordance with ORS 271.140.

Section 3. Pursuant to ORS 271.150, the City Recorder is hereby directed to file a certified copy of this ordinance and the map attached hereto as Exhibit "A" with the Douglas County Clerk, Douglas County Assessor and Douglas County Surveyor.

ADOPTED BY THE CITY COUNCIL THIS 14th DAY OF APRIL, 2014.

APPROVED BY THE MAYOR THIS 14th DAY OF APRIL, 2014.



Larry Rich, Mayor

ATTEST:



Sheila R. Cox, City Recorder

Proposed Vacation of Right-of-Way (File No. VAC-13-2)



Alleyway Between NE Stephens St. and NE Grandview Dr.
T27, R5W, S188C, Willamette Meridian, Douglas County, Oregon

Community Development Department
900 SE Douglas Ave., Roseburg, Oregon 97470 | 541-492-6750

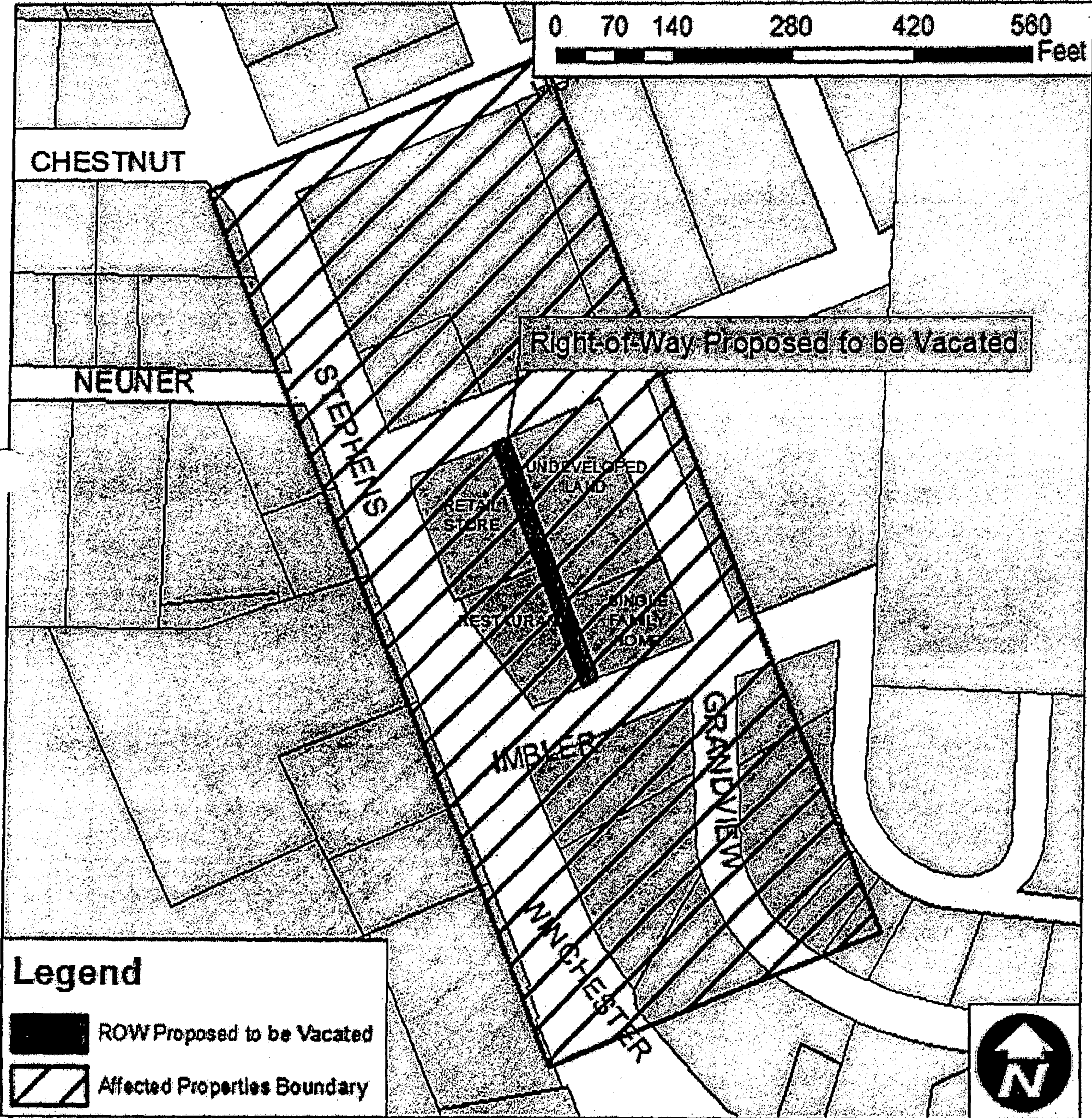

Map is for informational purposes only and is not suitable for legal, engineering or surveying purposes. The City of Roseburg is not responsible for map errors, omissions, misuse, or misinterpretation. Not for determining legal ownership or identification of property boundaries.

EXHIBIT "A" - ORDINANCE NO. 3428

C.S. File No 67/35-90