

GOVERNMENT CORNER RESTORATION FORM

Date: 11-29-2011 By: Jc
This survey consists of:

Township 27S Range 5W Sec. 19 County DOUGLAS Map: _____
State OREGON Date OCT 24, 2011 No. 100372 Narrative: _____
Corner Rpt: CS 67/33-44

Corner Designation

DOUGLAS COUNTY
SURVEYOR

- Condition Report Only
- Not Found
- Renewed
- Unrecorded
- Surveyed In
- Referenced Out

Previous Renewals 1936, 1966, 1987, 2006

Monument(s) Found: (Condition and Source)

FROM 1966 RENEWAL A 2 1/2 INCH DIAMETER BRASS CAP (MARKED AS AT RIGHT) ON A 1 INCH I.D. IRON PIPE IS FIRMLY SET APPROXIMATELY 2 INCHES BELOW SURFACE OF NEWLY BUILT DIRT ROAD. ROAD CONSTRUCTION HAS REMOVED, IN THE LEAST, 2 FEET OF THE SILT PREVIOUSLY NOTED AS DEPOSITED IN AREA IN 2006 RENEWAL. A SEARCH WAS MADE BUT NO EVIDENCE OF THE 1987 OR 2006 IRON ROD MONUMENTS WAS FOUND.

COUNTY SURVEYORS OFFICE

M. C.

R	524	519	R
6			5
W	T 27S		W
	1966		

Accessories Found:

NO 0.13 T.S FOUND-
 NO 1936 B.T.S FOUND.
 NO GOOD EVIDENCE OF 1966 B.T.S FOUND (SOME OUT OF POSITION LARGE BALM TRUNKS WITH NO DISCERNIBLE ROOT HOLES).
 EVIDENCE OF 3 1966 RENEWAL B.T.S FOUND.
 A 10" LOCUST NOW A 12 INCH P.B.H. LOCUST WITH A PARTIALLY HEALED DOUBLE BLAZE SHOWING THE SCRIBING "MC 524 CS" "BT"; BEARS N76°W, 15² FEET DISTANT (AS PER RECORD).
 NEAR BEARING AND DISTANCE OF S.E. ASH TREE IS A POSSIBLE ROOT HOLE.
 A 6" MAPLE, NOW A 13 INCH P.B.H. MAPLE WITH A FULLY HEALED DOUBLE BLAZE; BEARS N15°E, 59² FEET DISTANT (AS PER RECORD).
 EVIDENCE OF TWO 2006 RENEWAL BEARING TREES FOUND. A 15" P.B.H. LOCUST (STILL SAME) WITH A PARTIALLY HEALED DOUBLE BLAZE SHOWING THE SCRIBING "MC 519 CS" "BT"; BEARS N71 3/4°E, 65² FEET DISTANT (AS PER RECORD).
 A 13" P.B.H. LOCUST NOW A 14 INCH P.B.H. LOCUST WITH A PARTIALLY HEALED DOUBLE BLAZE SHOWING THE SCRIBING "MC 524 CS" "BT"; BEARS N33 1/2°W, 58² FEET DISTANT (AS PER RECORD).

RENEWAL

Monument Set (Procedure and Description)

Monument Detail

N/A

N/A

New Accessories

A METAL WITNESS POST AND SIGN IS SET 1 FOOT SOUTH OF B.C. MONUMENT.

Sketch of Monument, Accessories, and General Area

Location & Comments

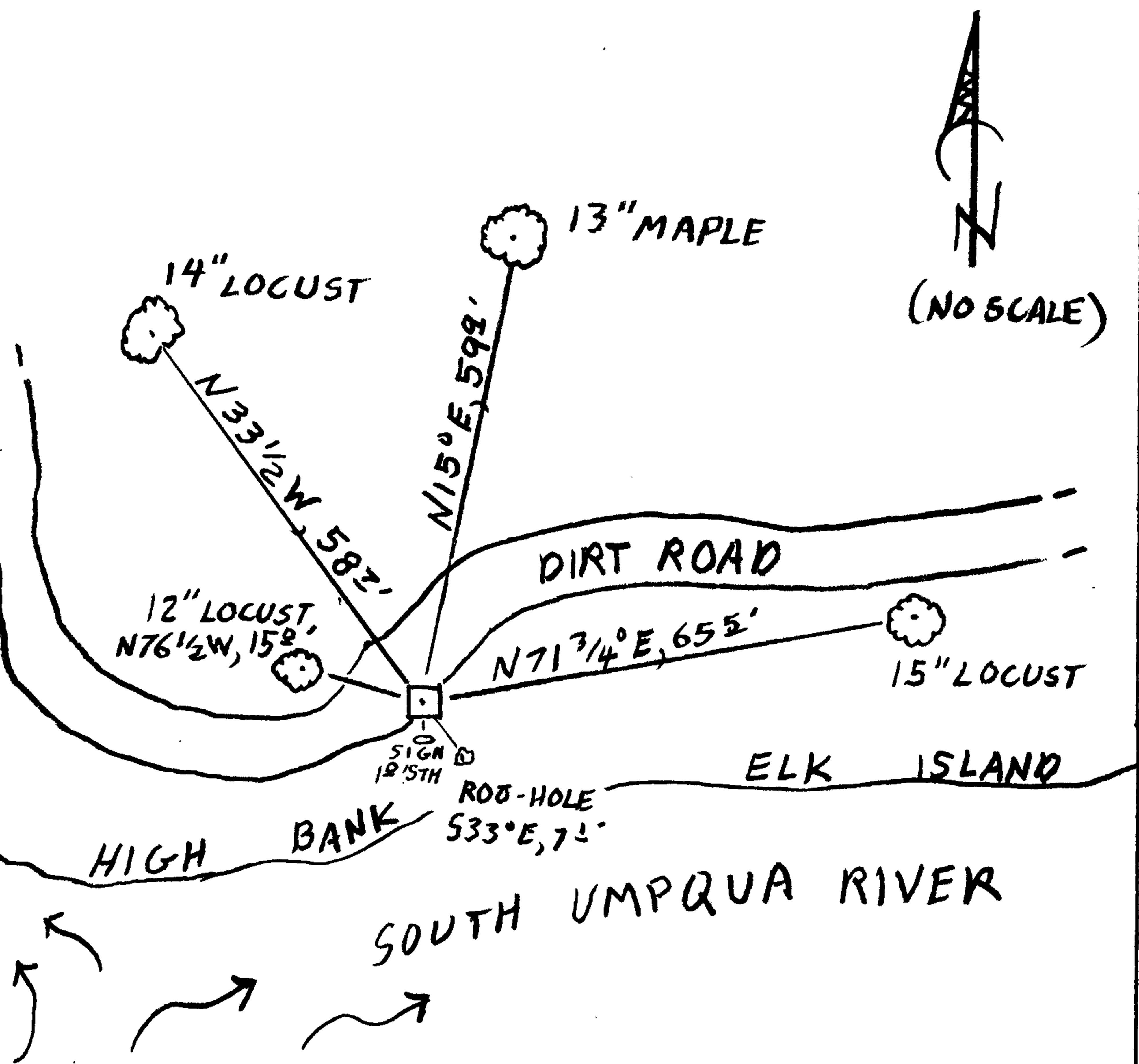

(NO SCALE)

Comp. Declin. 15 3/4 E'
Agency DECU
Party Chief STEPHEN J. MAUSE
Notekeeper _____
Witnesses M. S. KOCH

Address _____

Surveyor's Seal
REGISTERED
PROFESSIONAL
LAND SURVEYOR

Randall W. Smith
RENEWAL - 6-30-2012

OREGON
JULY 25, 1990
RANDALL W. SMITH
2468