

GOVERNMENT CORNER RESTORATION FORM

Date: 10-17-20¹¹ By: JK

This survey consists of:

Township ⁴ 2~~2~~5 Range 6W Sec. 12

County DOUGLAS

State OREGON

Date AUG 18, 2011

No. 620800⁵

Narrative: _____
Corner Rpt: CS 67/33-43

Corner Designation

W 1/16 ⁵¹²/₅₁₃

DOUGLAS COUNTY SURVEYOR

Condition Report Only

Not Found

Renewed

Unrecorded

Surveyed In

Referenced Out

Previous Renewals NONE

MONUMENT DETAIL

Monument(s) Found: (Condition and Source)

A 3 1/8 INCH DIAMETER BRASS CAP (MARKED AS AT RIGHT) ON A 2 INCH I.D., 28 INCH LONG GALVANIZED IRON PIPE WAS FOUND LOOSE FROM GROUND ON EDGE OF DIRT ACCESS ROAD (NIEL HIBBS RLS #52989 FOUND DISPLACED MONUMENT WHICH WAS POINTED OUT BY PROPERTY OWNER).

U.S. DEPT OF INTERIOR

W 1/16 ⁵¹²/₅₁₃

1973

BUR. OF LAND MANAGEMENT

Accessories Found:

EVIDENCE OF TWO ORIGINAL 1973 BEARING TREES.
A FIR, 12 INS. DIAM., NOW A 16 INCH D.B.H., 20 FOOT TALL, DEAD FIR SNAG WITH A FULLY HEALED SINGLE BLAZE; BEARS N 63 1/2° E, 158 FEET DISTANT (AS PER RECORD).
A FIR, 12 INS. DIAM, NOW A 12 INCH D.B.H., 5 FOOT TALL FIR STUMP, WITH A PARTIALLY HEALED SINGLE BLAZE SHOWING THE SCRIBING "W 1/16 S13 BT"; BEARS S 54° E, 409 FEET DISTANT (AS PER RECORD).

RENEWAL

Monument Set (Procedure and Description)

FOUND LOOSE MONUMENT IS RESET AT POSITION DETERMINED FROM FOUND O.B.T.s AND NOW PROTRUDES 4 INCHES ABOVE GROUND. STAMPING IS ADDED TO MONUMENT TO NOW READ AS AT RIGHT.

Monument Detail

U.S. DEPT. OF INTERIOR

W 1/16 S12 RESET
S13 2011

1973

BUR. OF LAND MANAGEMENT

New Accessories

AN 11 INCH D.B.H. DOUGLAS FIR SCRIBED "W 1/16 S12.CS" "BT" ON A DOUBLE BLAZE; BEARS N25°E, 33.6 FEET DISTANT.

AN 11 INCH D.B.H. WHITE OAK SCRIBED "W 1/16 S13.CS" "BT" ON A DOUBLE BLAZE; BEARS S46°E, 15.0 FEET DISTANT.

Sketch of Monument, Accessories, and General Area

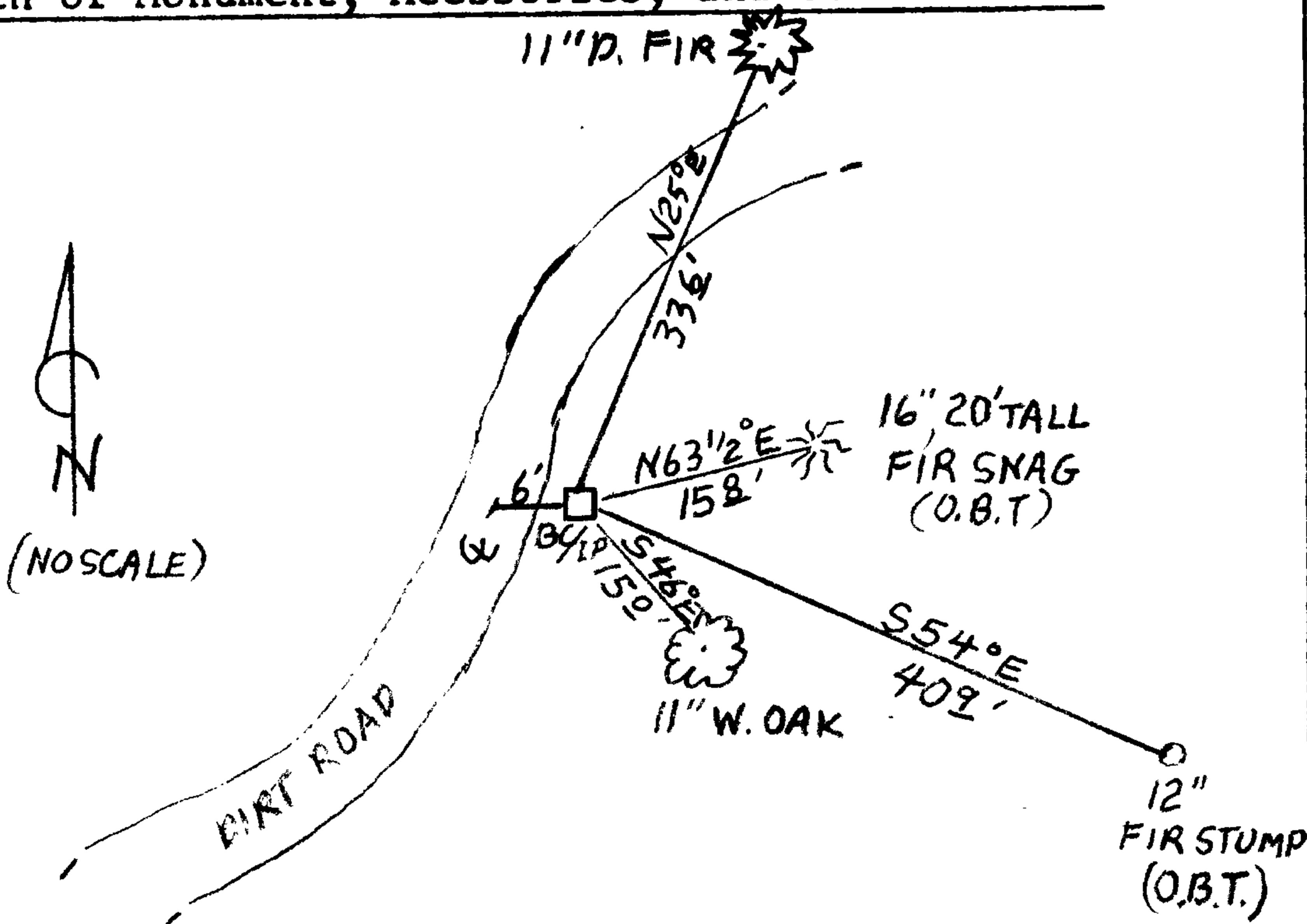

Location & Comments

MONUMENT IS IN OLDER SECOND GROWTH FIR FOREST BOTTOM-LAND WITH A GENTLE SLOPE RISING TO THE WEST AND OPEN FIELDS TO THE NORTH AND WEST.

Comp. Declin. 15 3/4° E

Agency D.C.S.O.

Party Chief STEPHEN JOHN FLAUSE

Notekeeper Stephen John Flause

Witnesses

JASON E. MARTIN

Address

Surveyor's Seal

REGISTERED
PROFESSIONAL
LAND SURVEYOR

Handwritten signature

OREGON
JULY 25, 1997
RANDALL W. SMITH
2468

6-30-2012