

GOVERNMENT CORNER RESTORATION FORM

Date: 4-19-2011 By: JC

Township 21S Range 11W Sec. 20

County DOUGLAS This survey consists of: Map: \_\_\_\_\_

State OREGON Date 4/12/2011

No. 300300 Narrative: \_\_\_\_\_

Corner Rpt: CS 67/33-30

Corner Designation

520 | 521  
529 | 528

DOUGLAS COUNTY

SURVEYOR

- Condition Report Only
- Not Found
- Renewed
- Unrecorded
- Surveyed In
- Referenced Out

Previous Renewals 1891 (NEW ORIG.) 1960

Monument(s) Found: (Condition and Source)

NO EVIDENCE OF 1866 OR 1891 ORIGINAL MONUMENTS IS FOUND.

FROM THE 1960 RENEWAL:  
A 3 1/4 INCH DIAMETER BRASS CAP (MARKED AS AT RIGHT) ON A 2 1/2 I.D. 28 INCH LONG IRON PIPE IS LYING LOOSE ON GROUND SURFACE, WITHOUT POSITION, AND NEAR BASE OF UPROOTED FIR STUMP.

(SOME SCATTERED LOOSE STONES ARE SEEN BUT NO CLEAR EVIDENCE OF DESCRIBED STONE MOUNDS IS FOUND).

U.S. CADASTRAL SURVEY  
T21S R11W

520 | 521  
529 | 528

1960

BUREAU OF LAND MANAGEMENT

Accessories Found:

FROM THE 1891 RESURVEY THE ONE ORIGINAL BEARING TREE:  
A MAPLE 36" DIA., NOW AN 80 INCH DIAMETER BREAST HEIGHT, BIG LEAF MAPLE WITH NO BLAZE MARKS, AND NOW WITH CENTER BURNED OUT AND A 1/3 TO A 1/2 OF THE TRUNK BROKEN AWAY AND FALLEN (TREE IS STILL LIVING). THIS TREE BEARS S 87 1/2° W, 337<sup>2</sup> FEET DISTANT (AS PER RECORD); OUR MEASUREMENT IS SLIGHTLY LONGER, SUGGESTING THIS MAY BE A FACE MEASUREMENT BUT DUE TO STEEP TERRAIN AND LARGE IRREGULAR SHAPE OF ROOT CROWN WE AGREE WITH ORIGINAL RECORD.

EVIDENCE OF TWO 1960 RENEWAL BEARING TREES:  
A FIR 11" DIA. NOW 23 INCH D.B.H. DOUGLAS FIR WITH A FULLY HEALED SINGLE BLAZE; BEARS N 28 1/2° W, 49<sup>5</sup> FEET DISTANT (AS PER RECORD).

A CEDAR 10" DIA., NOW A FALLEN AND ROTTEN 14 INCH DIAMETER 5 FOOT LONG CEDAR STUMP WITH A PARTIALLY HEALED SINGLE BLAZE SHOWING THE LEGIBLE SCRIBING "11 WS". THE ROOT-HOLE OF THE STUMP BEARS S 9° W, 43<sup>6</sup> FEET DISTANT (AS PER RECORD).

CS  
C.S. File No 67/33-30

RENEWAL

Monument Set (Procedure and Description)

THE PREVIOUSLY DESCRIBED BRASS CAP MONUMENT IS RESET AT THE POSITION INDICATED BY THE DESCRIBED ACCESSORIES FOUND. THE STAMPING "RESET DCSD 2011" IS ADDED TO THE BRASS CAP SO IT NOW READS AS AT RIGHT. THE B.C. MONUMENT IS FIRMLY AND PLUMBLY SET AND NOW PROTRUDES APPROX 5 INCHES ABOVE GROUND.

Monument Detail

U.S. CADASTRAL SURVEY  
T21 S R11 W  
520 | 521  
528 | 529  
DCSD  
RESET 1960 2011

BUREAU OF LAND MANAGEMENT

New Accessories

A 6 INCH D.B.H. DOUGLAS FIR (SLIGHT PISTOL-BUTT) SCRIBED "T21SR11W521CS" "BT" ON A DOUBLE BLAZE; BEARS N66°E, 39 FEET DISTANT.

A 12 INCH D.B.H. DOUGLAS FIR (SLIGHT PISTOL-BUTT) SCRIBED "T21SR11W529CS" "BT" ON A DOUBLE BLAZE; BEARS S6°E, 278 FEET DISTANT.

A 7 INCH D.B.H. DOUGLAS FIR (MAJOR PISTOL-BUTT AND AN "S" CURVE IN THE TRUNK AT 3+ FEET HIGH) SCRIBED "T21SR11WCS" "BT" ON A DOUBLE BLAZE; BEARS S44°W, 252 FEET DISTANT

Sketch of Monument, Accessories, and General Area

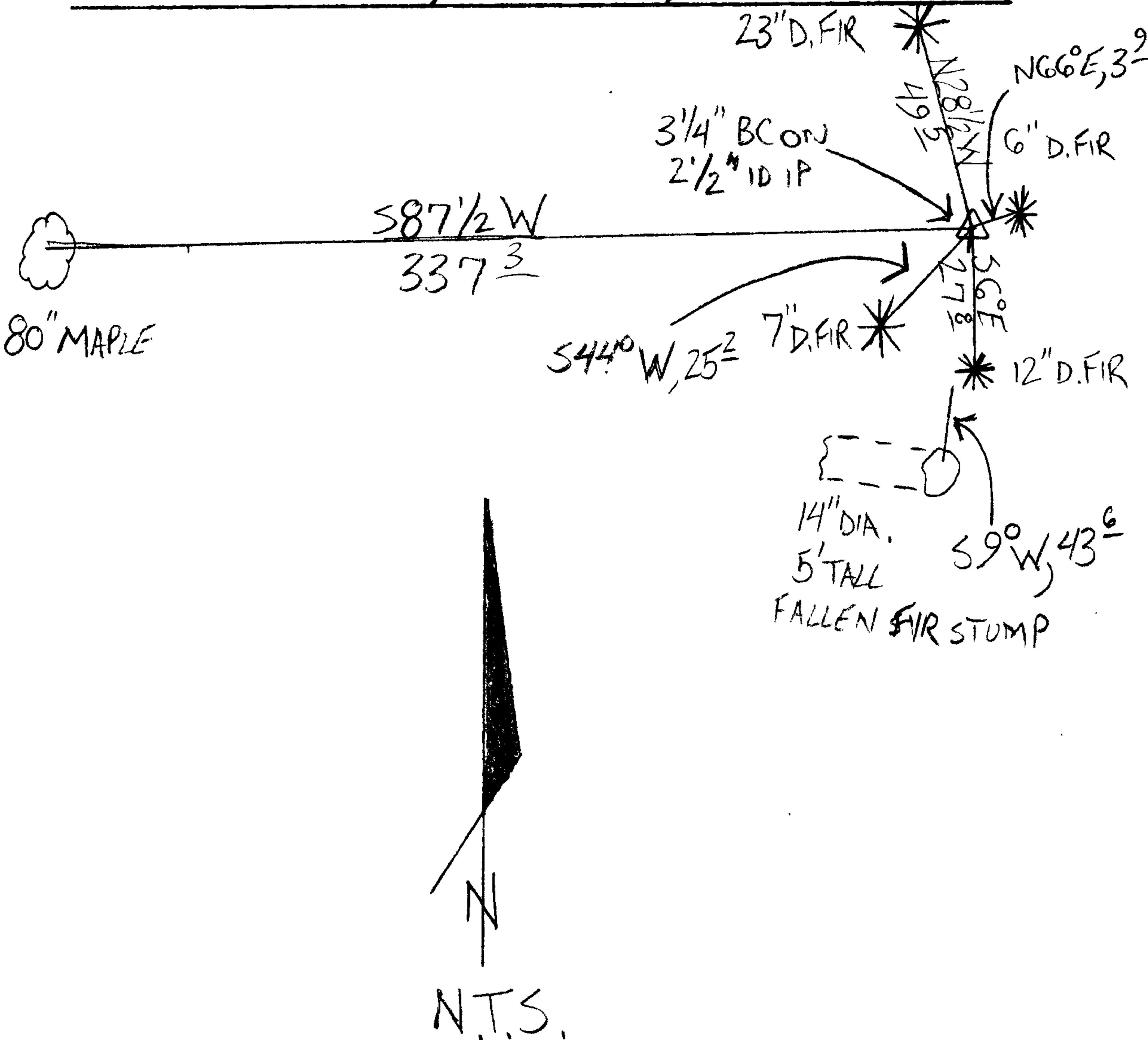

Location & Comments

MONUMENT IS ON VERY STEEP WSW SLOPE IN MIXED FIR, ALDER AND SPRUCE FOREST. MONUMENT IS APPROXIMATELY 250 FEET EAST-ERLY FROM AND 200 FEET HIGHER THAN A DIRT FOREST ACCESS ROAD.

Comp. Declin. 16°E  
Agency DCSD  
Party Chief STEPHEN JOHN FLAUSE  
Notekeeper Stephen John Flause  
Witnesses MIKE S. KOCH  
GARRETT A. MC GRAW

Address

Surveyor's Seal

REGISTERED  
PROFESSIONAL  
LAND SURVEYOR

*Handwritten signature*  
RENEWAL 6-30-2012

OREGON  
JULY 25, 1990  
RANDALL W. SMITH  
2489