

FILED

GOVERNMENT CORNER RESTORATION FORM

Date: 3/25/2011 By: JC  
This survey consists of:  
Map: \_\_\_\_\_

Township 29 S Range 06 W Sec. 01

County DOUGLAS

State OREGON Date FEB 28, 2011

No. 040010

Narrative: \_\_\_\_\_  
Corner Rpt: CS 67/33-15

Corner Designation

NNE  
DLC 40

DOUGLAS COUNTY  
SURVEYOR Only

- Condition
- Not Found
- Renewed
- Unrecorded
- Surveyed In
- Referenced Out

Previous Renewals 1953

Monument(s) Found: (Condition and Source)

FROM 1953 ARTHUR BOYER SURVEY A 3/4"  
BOLT W/ 1" SQ. TOP PROTRUDING 2" ABOVE  
GROUND

N/A

Accessories Found:

FOUND ORIG. 30" DIA W. OAK BEARING TREE. NOW FALLEN INTACT  
WITH NO BARK AND ROTTED FACE BEARS S. 80° W 225<sup>2</sup> FT. (AS PER RECORD).

RENEWAL

Monument Set (Procedure and Description)

Monument Detail

FOUND MONUMENT IS VERY STABLE WE DO NOT SET B.C.

N/A

New Accessories BRG 1/2 DIST TAKEN FROM 3/4" BOLT A 6 INCH D.B.H. DOUGLAS FIR SCRIBED "X" ON HI BLAZE AND "CS BT" ON LOW BLAZE, BEARS N 11 1/2° E, 59 2/3 FEET DISTANT.

A 8 INCH D.B.H. MADRONE SCRIBED "NNE DLC 40 CS" "BT" ON A DOUBLE BLAZE, BEARS N 69° E, 8 2/3 FEET DISTANT.

A 13 INCH D.B.H. WHITE OAK SCRIBED "NNE DLC 40 CS" "BT" ON A DOUBLE BLAZE, BEARS S 17 1/4° W, 46 2/3 FEET DISTANT.

Sketch of Monument, Accessories, and General Area A 19 INCH D.B.H. WHITE OAK SCRIBED "NNE DLC 40 CS" "BT" ON A DOUBLE BLAZE, BEARS N 54 1/2° W, 36 2/3 FEET DISTANT.

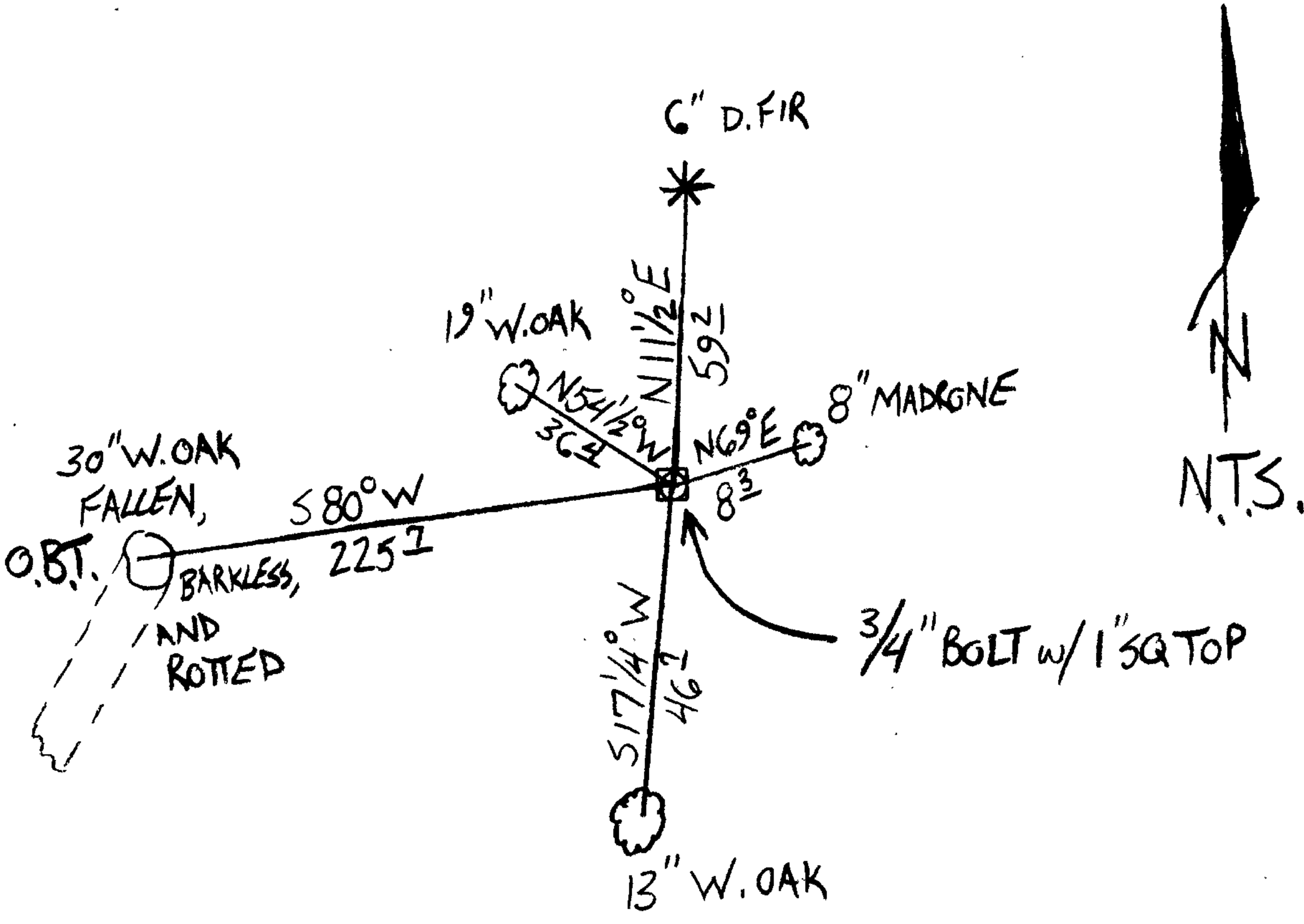

Location & Comments MONUMENT IS ON A MODERATE WEST SLOPE W/MIX OAK, MADRONE AND DOUGLAS FIR TREES. A ROSEBURG FOREST PRODUCTS ROCK QUARRY IS NORTH OF MONUMENT.

Comp. Declin. 15 3/4° E Agency DCSO Party Chief STEPHEN JOHN FLAUSE Notekeeper Michael S. Koch Witnesses MIKE KOCH

Address

Surveyor's Seal REGISTERED PROFESSIONAL LAND SURVEYOR RANDALL W. SMITH OREGON JULY 25, 1990 2488