

GOVERNMENT CORNER RESTORATION FORM

Date: 3/22/2011 By: JC
This survey consists of:

Township 305 Range 5W Sec. 22

County DOUGLAS Map: _____

State OREGON Date FEB. 8, 2011

No. 500300 Narrative: _____
Corner Rpt: CS 67/33-11

Corner Designation

S22 | S23
S27 | S26

DOUGLAS COUNTY SURVEYOR

- Condition Report Only
- Not Found
- Renewed
- Unrecorded
- Surveyed In
- Referenced Out

Previous Renewals 1922, 1951, 1963

Monument(s) Found: (Condition and Source)

FROM THE 1922 RENEWAL, A FORD AXLE WITH A 3 INCH DIAM. GEAR AT ITS TOP IS FIRMLY SET AND PLUMB 6 INCHES BELOW GROUND SURFACE. (MONUMENT COULD BE WENDEROTH'S FROM 1951; EVIDENCE IS NOT CLEAR IF MORE THAN ONE AXLE WAS SET)

FROM THE 1963 RENEWAL, A 2 1/2 INCH DIAMETER BRASS CAP (MARKED AS AT RIGHT) ON A 1 1/2 INCH I.D. X 30 INCH FLANGED IRON PIPE IS FOUND, LAYING DOWN AND BURIED 1+ FOOT DEEP 55° W, 8 3/4 FEET DISTANT FROM ABOVE FOUND AXLE MONUMENT. IRON PIPE ON MONUMENT IS SEVERELY BENT.

Accessories Found:

A THOROUGH SEARCH WAS MADE FOR THE ORIGINAL B.T.'S ~~WAS MADE~~; NO EVIDENCE WAS FOUND.

ONE BEARING TREE FROM 1922 IS FOUND.
A 16" PINE NOW A 35 FOOT TALL 43 INCH D.B.H. PONDEROSA PINE SNAG (ALIVE) WITH GOOD PARTIAL, BUT ILLEGIBLE, SCRIBING VISIBLE AT AN APPROX. 16 INCH DIAMETER INSIDE A PARTIALLY REOPENED BLAZE; BEARS N66°W, 52 3/4 FEET DISTANT (RECORD N60°W, 52 3/4 FT.) NE ROCK MONUMENT FALLS IN SOMETIMES FLOODED AREA, NO EVIDENCE IS FOUND.
UPPER PORTION OF A LARGE FALLEN FIR IS FOUND NEAR B. AND D. TO SOUTHWEST B.T.,

MONUMENT DETAIL

COUNTY SURVEYORS OFFICE
T305

S22 | S23
S27 | S26
R5W
1963

RENEWAL

Monument Set (Procedure and Description)

Monument Detail

1965 RENEWAL BEARING TO THE ONE FOUND NORTHWEST B.T. AGREES REASONABLY WITH AS FOUND BEARING. THE AXLE MONUMENT POSITION IS ACCEPTED AS FOUND.

THE BRASS CAP IRON PIPE MONUMENT IS TOO BENT TO BE REUSED AND IS REMOVED FROM AREA.

New Accessories

A 14 INCH D.B.H. WHITE OAK SCRIBED "X" "BT" ON A HIGH-LOW DOUBLE BLAZE; BEARS $S49^{\circ}W$, $115\frac{1}{2}$ FEET DISTANT.

A 6 INCH D.B.H. OREGON ASH SCRIBED "X" "CSBT" ON A HIGH-LOW DOUBLE BLAZE; BEARS $S72\frac{1}{2}^{\circ}W$, $38\frac{1}{2}$ FEET DISTANT.

A 1 1/2 INCH DIAMETER ALUMINUM CAP STAMPED "DOUGLAS CO. SURVEYOR B.01" ON A 5/8 INCH X 50 INCH LONG IRON ROD IS SET WITH CAP FLUSH WITH GROUND AND BEARS $N45^{\circ}E$, 65° FEET DISTANT.

Sketch of Monument, Accessories, and General Area

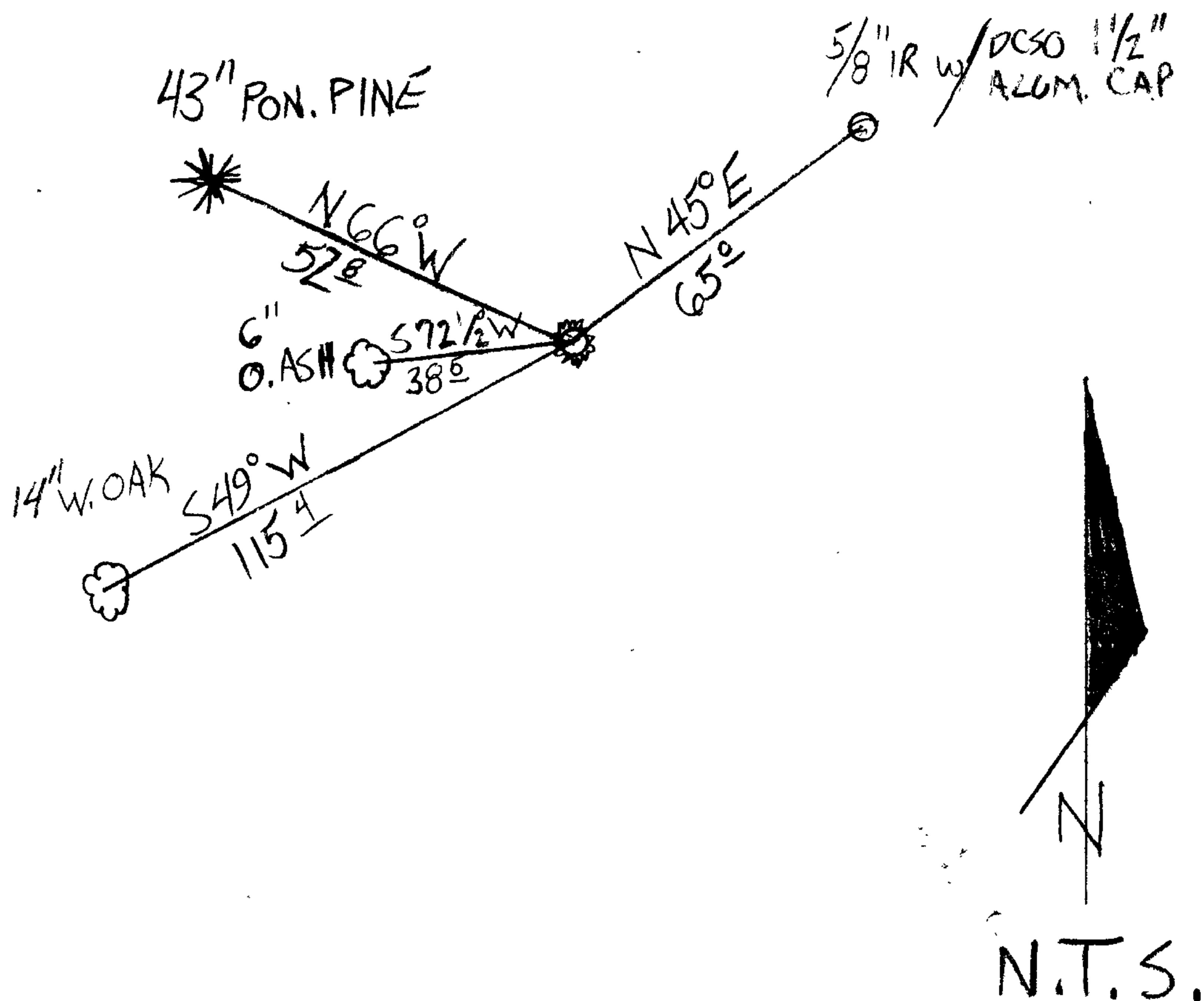

Location & Comments

MONUMENT IS IN RAISED FLAT AREA OF FLOODPLAIN APPROX. 250 FEET NORTH FROM THE SOUTH UMPQUA RIVER.

Comp. Declin. $15\frac{3}{4}^{\circ}E$
 Agency DCSO
 Party Chief STEPHEN JOHN FLAUSE
 Notekeeper Stephen John Flause
 Witnesses MIKE S. KOCH, GARRETT MC GRAW

Address

Surveyor's Seal

REGISTERED PROFESSIONAL LAND SURVEYOR

Randall W. Smith
 RENEWAL 6-30-2012

OREGON
 JULY 25, 1990
 RANDALL W. SMITH
 2468