

GOVERNMENT CORNER RESTORATION FORM

Date: 3/17/2011 By: JC

This survey consists of:

Township 29S Range 25W Sec. 31 County DOUGLAS Map: _____

State OREGON Date FEB 22, 2011 No. 100140 Narrative: _____
Corner Rpt: C567/33-9

Corner Designation

1/4
S36/S31

DOUGLAS COUNTY
SURVEYOR

- Condition Report Only
- Not Found
- Renewed
- Unrecorded
- Surveyed In
- Referenced Out

Previous Renewals 1929, 1978

Monument(s) Found: (Condition and Source)

FROM 1978 PRIVATE SURVEY BY L.S. 498
AND RECORDED IN DCSD AS KM 3-12. A
1 7/8 INCH DIAMETER ALUMINUM CAP (MARKED
AS AT RIGHT) ON A 5/8 INCH DIAMETER REBAR
FIRMLY SET PROTRUDING 1 FOOT ABOVE GROUND.

MEASURING S48°W, 51 1/2 FEET DISTANT
(AGREES WITH RECORD) FROM THE ABOVE DESCRIBED
MONUMENT IS A 3/4 INCH I.D. IRON PIPE
(RECORD A GAL. IRON PIPE) SET IN 1929 BY
COUNTY SURVEYOR. THIS MONUMENT HAS
TWO W. OAK BEARING TREES AS DESCRIBED
WHICH WE DO NOT DISTURB.

Accessories Found:

A THOROUGH SEARCH WAS MADE FOR THE ORIGINAL BITS IN A WIDE
AREA AROUND THE ABOVE FOUND MONUMENTS, NO EVIDENCE WAS FOUND.

THE TWO 1929 BITS ARE FOUND (SEE ABOVE).

THE TWO 1978 BEARING TREES ARE FOUND
7" OAK NOW A 10 INCH D.B.H. WHITE OAK WITH A FULLY HEALED SINGLE BLAZE;
BEARS S70°W 4 1/2 FEET DISTANT (RECORD S40°W, 3.5').

9" OAK NOW A 7 FOOT TALL 10 INCH D.B.H. WHITE OAK STUMP WITH A PARTIALLY HEALED
BLAZE REVEALING A ROTTED FACE WITH NO APPARENT SCRIBING; BEARS
S62°E, 5 1/2 FEET DISTANT (RECORD S58°E, 5.5').

T 29 S
R 25 W
S 36 / S 31
1/4 S
L S 498 1978

RENEWAL

Monument Set (Procedure and Description)

Monument Detail

A NEWER NORTH-SOUTH FENCE PASSES THROUGH THE 1978 MONUMENT AND A VERY OLD FALLEN EAST-WEST FENCE PASSES CLOSER TO THE 1978 MONUMENT THAN THE 1929 I.P.

WE PERPETUATE 1978 CORNER POSITION AS FOUND. DISAGREEMENT WITH ~~BT DESCRIPTIONS~~ SEEM DUE TO SIMPLE MEASUREMENT BLUNDERS NOT A CHANGE IN MONUMENT LOCATION.

N/A

New Accessories

A 21 INCH D.B.H. DOUGLAS FIR SCRIBED "1/4 S 31 CS" "BT" ON A DOUBLE BLAZE; BEARS N80 1/2° E, 58 1/2 FEET DISTANT.

A 16 INCH D.B.H. INCENSE CEDAR SCRIBED "1/4 S 31 CS" "BT" ON A DOUBLE BLAZE; BEARS S25 3/4° E, 58 1/2 FEET DISTANT.

Sketch of Monument, Accessories, and General Area

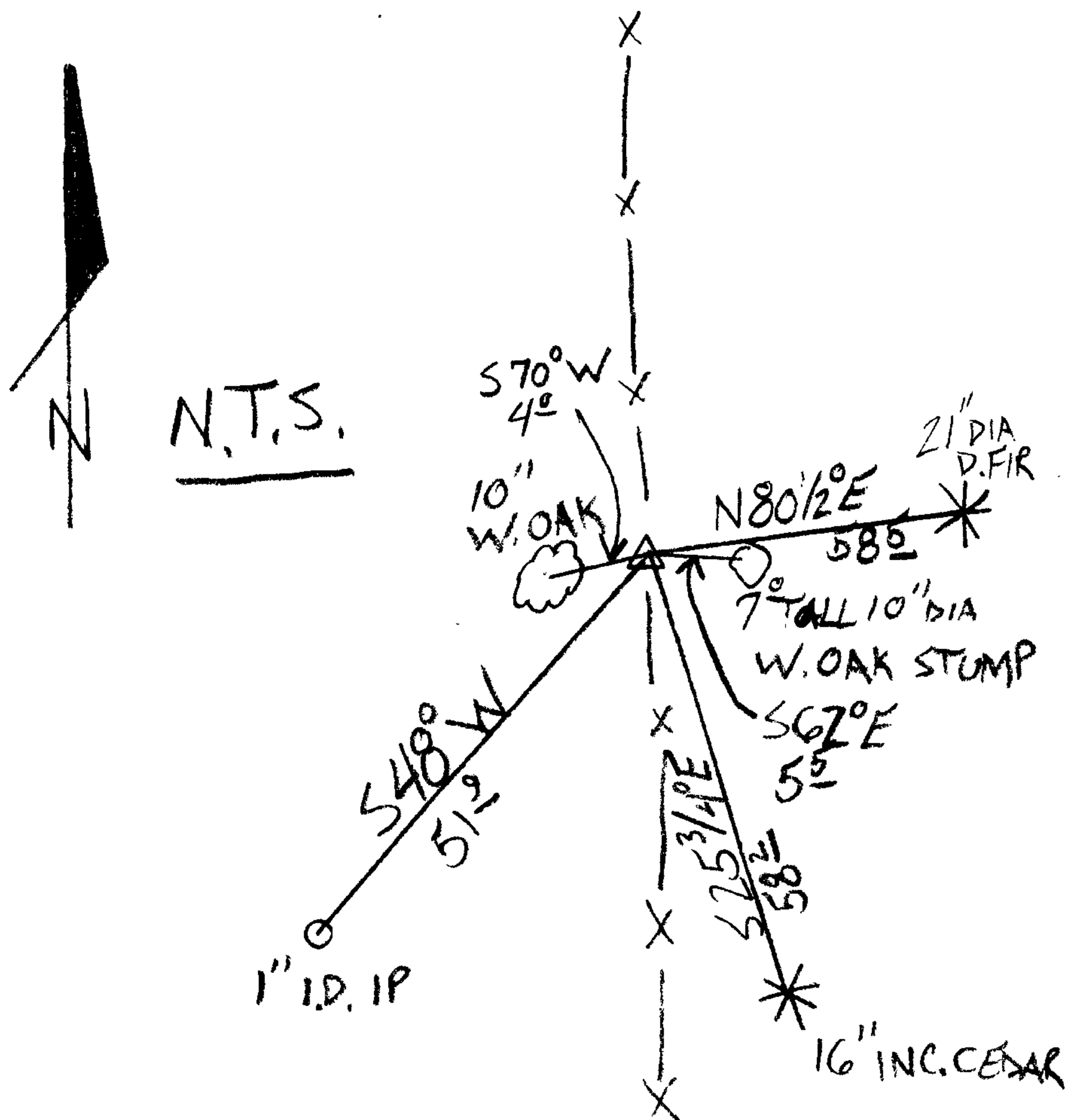

Location & Comments

MONUMENT IS ON GENTLE NORTH SLOPE IN A MIXED OAK AND CONIFER FOREST, APPROX. 200 FT. EASTERLY FROM SKYLINE DRIVE.

Comp. Declin. 15 3/4° E
 Agency DCSD
 Party Chief STEPHEN JOHN FLAUSE
 Notekeeper Stephen John Flause
 Witnesses MIKE KOCH, GARRETT MCGRAW

Address

Surveyor's Seal

REGISTERED
 PROFESSIONAL
 LAND SURVEYOR

Renewal 6-30-2011

OREGON
 JULY 25, 1990
 RANDALL W. SMITH
 2488