

RENEWAL

Monument Set (Procedure and Description)

Monument Detail

N/A

N/A

New Accessories

A 5 INCH D.B.H. DOUGLAS FIR SCRIBEN "X" "CSBT" ON A HIGH-LOW BLAZE;
BEARS S 21 1/2° W, 11 1/2 FT. DISTANT.

AN 18 INCH D.B.H. DOUGLAS FIR SCRIBEN "T325 R9WS3CS" "BT" ON A DOUBLE
BLAZE; BEARS S 65 1/2° W, 45 FT. DISTANT.

Sketch of Monument, Accessories, and General Area

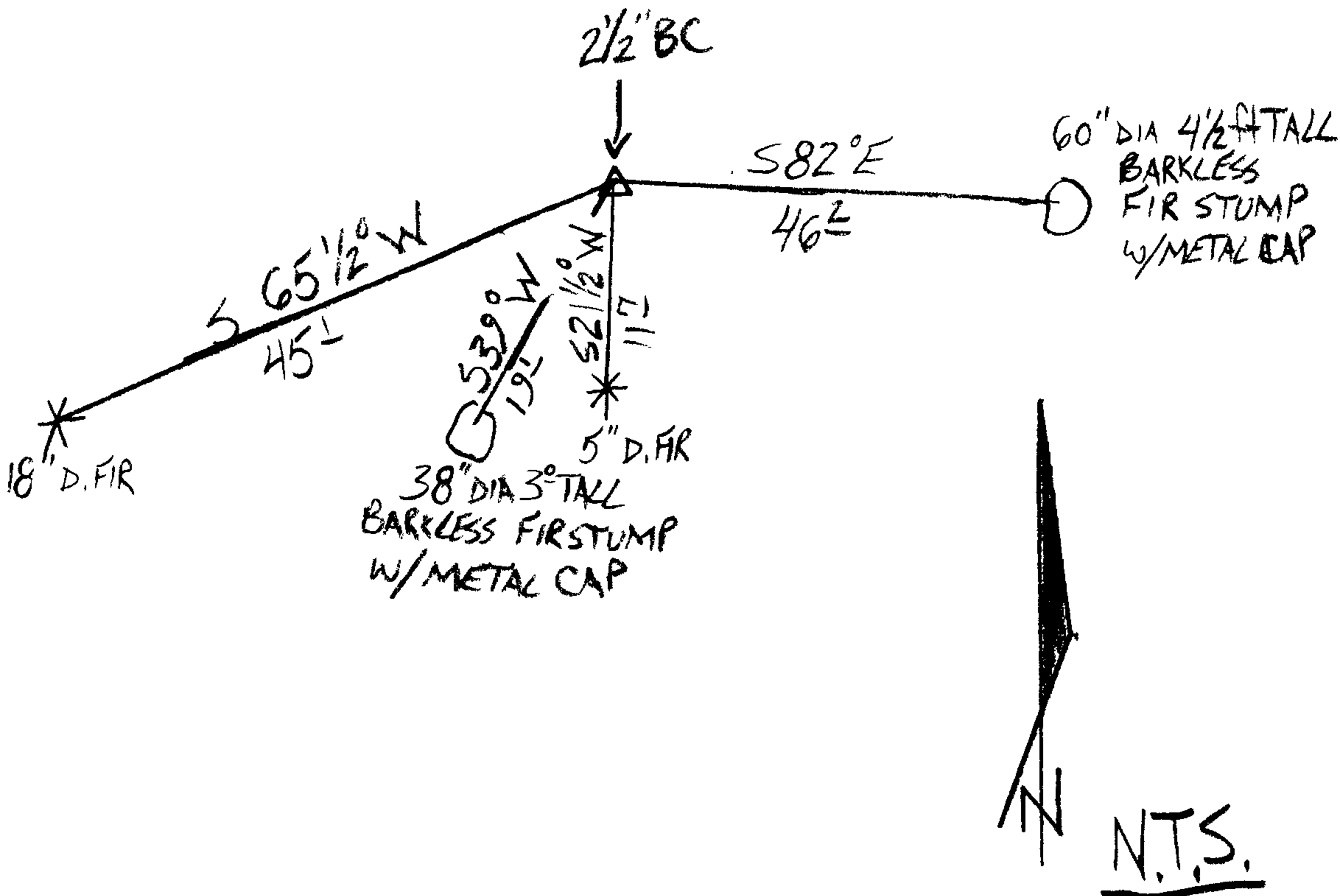

Location & Comments

MONUMENT IS ON MODERATE
SOUTHERLY SLOPE NEAR TOP OF
BROAD NE RUNNING RIDGE.
THERE IS A LARGE NEW CLEAR-
CUT NORTH OF THE E-W SECTION
LINE. MONUMENT IS APPROX. 250
FEET EAST FROM A GRAVELLED BLM
ROAD.

Comp. Declin. 16° E
Agency KCSO
Party Chief STEPHEN JOHN FLAUSE
Notekeeper Stephen John Flauso
Witnesses
MIKE KOCH, GARRETT MCGRAW

Address

Surveyor's Seal

REGISTERED
PROFESSIONAL
LAND SURVEYOR

Randall W. Smith
6-30-2012

OREGON
JULY 25, 1990
RANDALL W. SMITH
2488