

GOVERNMENT CORNER RESTORATION FORM

Township 22S Range 6W Sec. 26

Date: 3/17/2011 By: JC
County DOUGLAS This survey consists of:

State OREGON Date FEB 7, 2011

Map: _____
Narrative: _____
No. 540200
Corner Rpt: CS 67/33-4

Corner Designation _____

DOUGLAS COUNTY

- Conducted Report Only
- Not Found
- Renewed
- Unrecorded
- Surveyed In
- Referenced Out

Previous Renewals 1961 DCSO

Monument(s) Found: (Condition and Source)

A 2 1/2 INCH DIAMETER BRASS CAP (MARKED AS AT RIGHT) ON A 1 1/2 INCH O.D. GALVANIZED IRON PIPE FIRMLY SET AND PROTRUDING 6 INCHES ABOVE GROUND.

COUNTY SURVEYORS OFFICE

T22S R6W

1/4 S26
S35

1961

Accessories Found:

EVIDENCE OF TWO ORIGINAL BEARING TREES FOUND.

A CEDAR 12" DIA., NOW A 4 FOOT TALL APPROX. 20 INCH DIAMETER ROTTEN CEDAR STUMP WITH NO REMAINING EVIDENCE OF BLAZE OR SCRIBING; BEARS SOUTH, 40 FEET DISTANT (AS PER RECORD).

A FIR 36" DIA. NOW A VERY ROTTEN 4 FOOT TALL ONCE 48 INCH DIAMETER FIR STUMP WITH NO EVIDENCE OF BLAZE OR FACE REMAINING; BEARS N 2 1/2° E, 53° FEET DISTANT (RECORD NORTH BEARING HITS WEST EDGE OF STUMP, RECORD 51 1/2 FT. DISTANCE IS GOOD ORIGINAL FACE MEASUREMENT).

1961 RENEWAL BEARING TREE IS FOUND

A 12" MAPLE NOW A DOUBLE TRUNK MAPLE THE MAIN TRUNK OF WHICH IS 22 INCHES D.B.H. AND SHOWS NO GOOD BLAZE EVIDENCE; BEARS S 68 1/2° W, 44 1/2 FEET DISTANT (RECORD S 70° W, 44 1/2 FT).

C.S. File No 67/33-4

RENEWAL

Monument Set (Procedure and Description)

Monument Detail

N/A

N/A

New Accessories

AN 8 INCH D.B.H. DOUGLAS FIR SCRIBED "1/4 S 26 CS" "BT" ON A DOUBLE BLAZE; BEARS N 49 1/2° E, 49 1/2 FEET DISTANT.

A 15 INCH D.B.H. MAPLE SCRIBED "1/4 S 26 CS" "BT" ON A DOUBLE BLAZE; BEARS N 19° W, 54° FEET DISTANT.

Sketch of Monument, Accessories, and General Area

Location & Comments

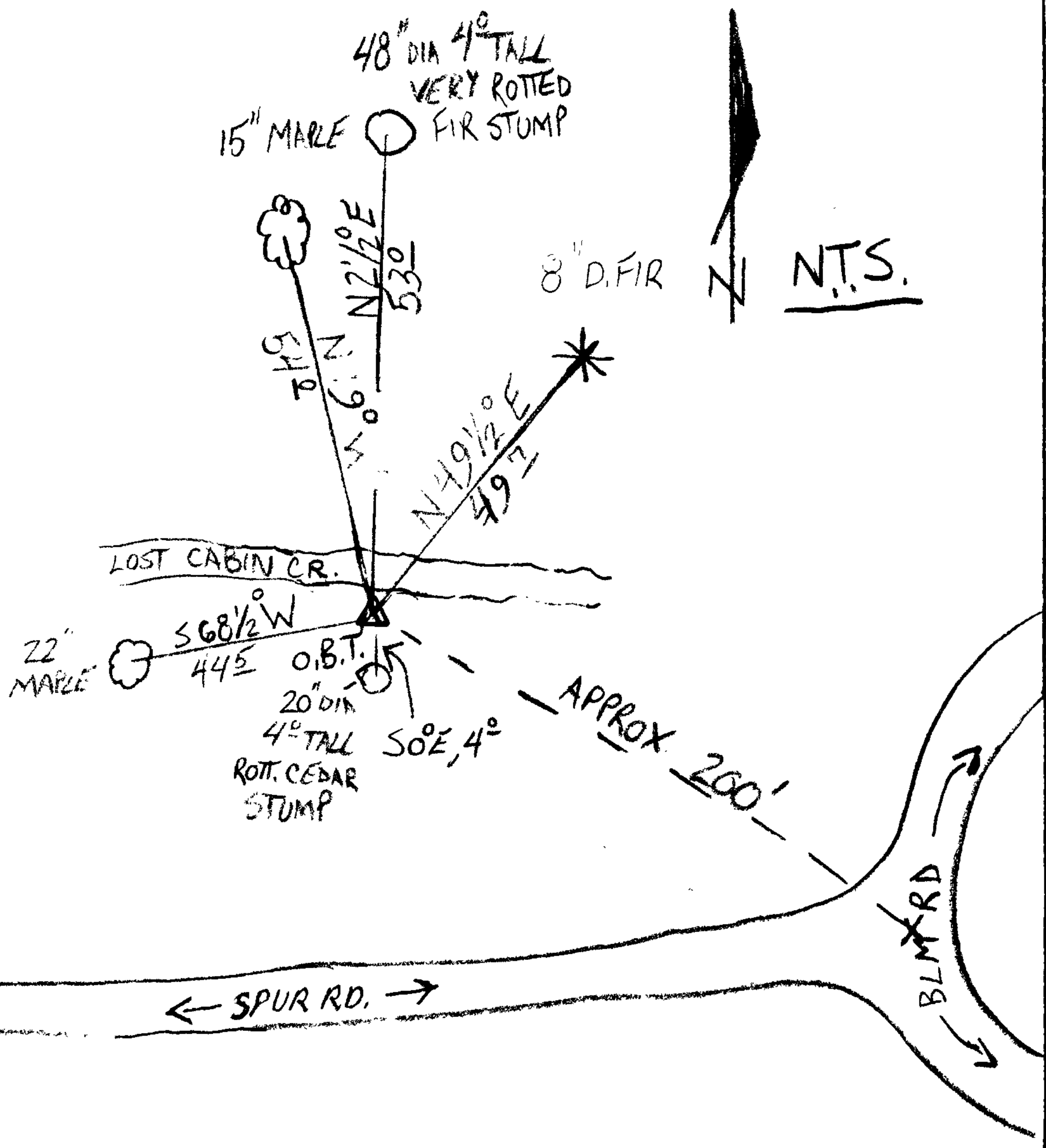

MONUMENT IS IN SHALLOW FORESTED CREEK BOTTOM, NORTH OF A SPUR ROAD AND WESTERLY OF A BLM ROAD.

Comp. Declin. 16° E
Agency DCSO
Party Chief STEPHEN JOHN FLAUSE
Notekeeper Stephen John Flause
Witnesses MIKE KOCH
GARRET MCGRAW

Address

Surveyor's Seal
REGISTERED PROFESSIONAL LAND SURVEYOR

Randall W. Smith
RENEWAL 6-30-2012

OREGON
JULY 25, 1990
RANDALL W. SMITH
2408