

GOVERNMENT CORNER RESTORATION FORM

Date: 1-27-2011 By: JC

This survey consists of:

Township 30S Range 04W Sec. 23

County DOUGLAS Map: \_\_\_\_\_

State OREGON Date JAN 3, 2011

No. 540300 Corner Rpt: 67/33-2

Corner Designation

$\frac{1}{4}$   $\frac{S23}{S26}$

DOUGLAS COUNTY SURVEYOR

- Condition Report Only
- Not Found
- Renewed
- Unrecorded
- Surveyed In
- Referenced Out

Previous Renewals 1889 AND 1981 RESURVEYS, 2000 RENEWAL

MONUMENT DETAIL

Monument(s) Found: (Condition and Source)

FROM THE 1981 RESURVEY A B.L.M. 3 1/4 INCH DIAM. BRASS DISC (MARKED AS AT RIGHT) ON A 2 1/2 INCH DIAM IRON PIPE FIRMLY SET AND PROTRUDING 4 INCHES ABOVE THE GROUND.

U.S. DEPT. OF THE INTERIOR

T30S R4W

1/4 S23

S26

1981

BUR. OF LAND MANAGEMENT

Accessories Found:

A SEARCH WAS MADE FOR THE 1889 BEARING TREES; NO EVIDENCE WAS FOUND.

TWO BEARING TREES FROM THE 1981 RESURVEY WERE FOUND.

A FIR 8" DIA. NOW A 15 INCH D.B.H DOUGLAS FIR SNAG WITH A FULLY HEALED BLAZE, BEARS N51 1/4° E, 73 FEET DISTANT (AS PER RECORD).

A FIR 10" DIA. NOW A 14 INCH D.B.H, 5 FOOT TALL DOUGLAS FIR STUMP WITH A FULLY HEALED SINGLE BLAZE, BEARS S08° E, 132 FEET DISTANT (AS PER RECORD).

TWO BEARING TREES ESTABLISHED IN 2000 RENEWAL WERE FOUND.

A 20" FIR NOW A 24 INCH DIAMETER 2 FOOT TALL DOUGLAS FIR STUMP WITH A PARTIALLY HEALED SINGLE BLAZE WITH THE SCRIBING "1/4 S BT" VISIBLE, BEARS S85° W, 22.2 FT. DISTANT (AS PER RECORD).

A 16" FIR NOW A 17 INCH DIAMETER 3 1/2 FOOT TALL DOUGLAS FIR STUMP WITH A PARTIALLY HEALED SINGLE BLAZE WITH THE SCRIBING "1/4 S BT" VISIBLE, BEARS S40° E, 35.2 FEET DISTANT (RECORD S36° E, 35.0). A NEW NCSO BEARING TREE TAG WITH THE CORRECTED BEARING IS ADDED TO THIS STUMP.

RENEWAL

Monument Set (Procedure and Description)

Monument Detail

MONUMENT POSITION IS ACCEPTED AS FOUND (RECORD BEARING TO SOUTHEAST 2000 RENEWAL BT WAS ERRONEOUS.)

N/A

New Accessories

AN 11 INCH DBH MADRONE SCRIBED "1/4 S 23 CS 13T" ON A DOUBLE BLAZE BEARS N57°W, 22° FEET DISTANT.  
A 7 INCH DBH DOUGLAS FIR SCRIBED "1/4 S 23 CS 13T" ON A DOUBLE BLAZE BEARS N80°E, 61° FEET DISTANT.

Sketch of Monument, Accessories, and General Area

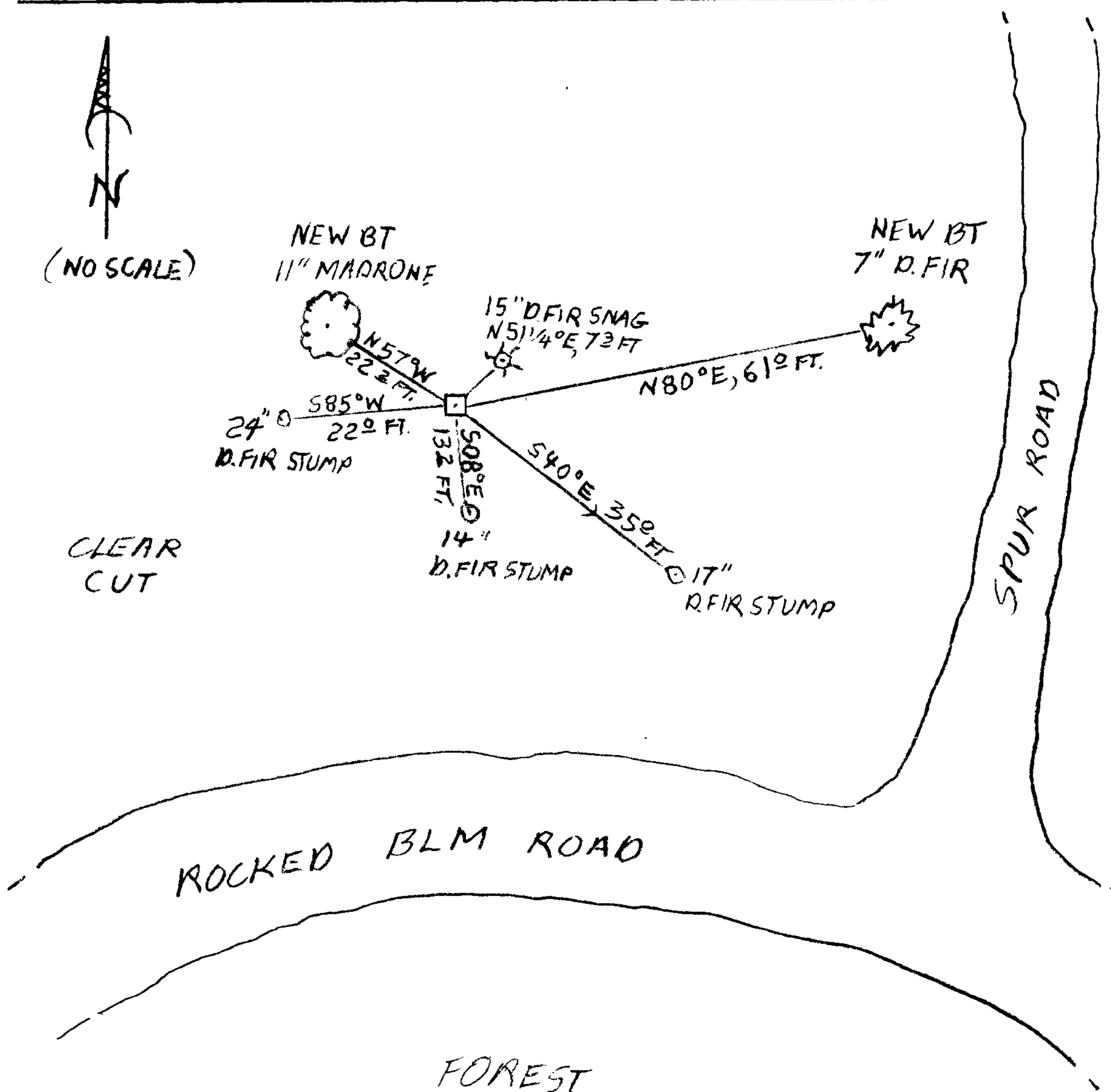

Location & Comments

MONUMENT IS ON HIGH NORTH FACE OF RIDGE, AT TOP OF SECONDARY RIDGE, AND BELOW SUMMIT OF MAIN RIDGE.  
MONUMENT IS IN CLEAR-CUT WITH OLD TREES TO SOUTH AND NORTHEAST.

Comp. Declin. 16 1/4° E  
Agency DCSO  
Party Chief SJ FLAUSE  
Notekeeper Stephen John Flause  
Witnesses M. KOGH  
G. MCGRAW

Address

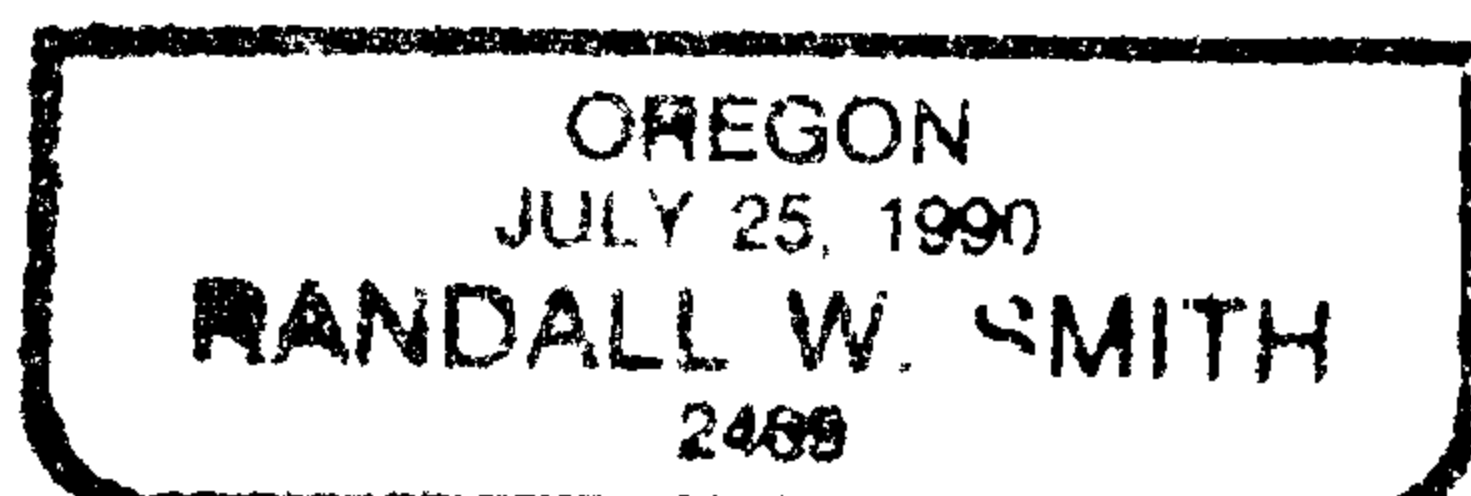
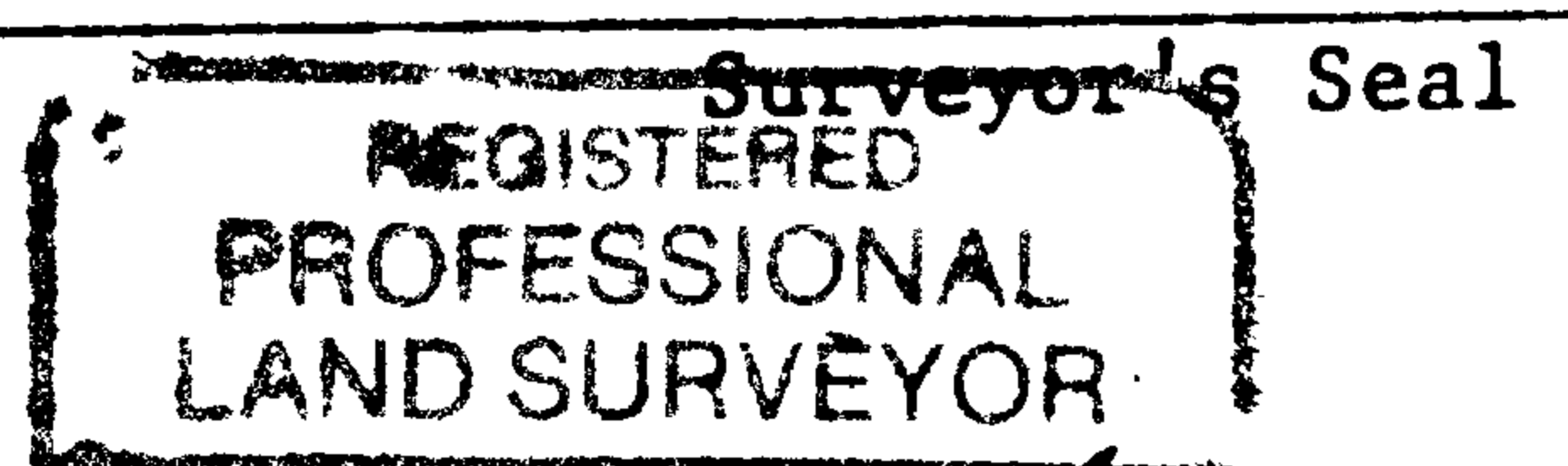

RENEWAL 6-30-2012.