

GOVERNMENT CORNER RESTORATION FORM

Date: 4/16/2010 By: JC

Township 26S Range 2W Sec. 28

County DOUGLAS

This survey consists of:

State OR

Date 4-14-2010

No. 30020

Map:

Narrative: Corner Rpt: 67/31-8

Corner Designation

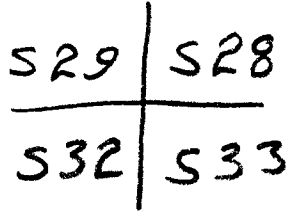

DOUGLAS COUNTY SURVEYOR

- Condition Report Only
- Not Found
- Renewed
- Unrecorded
- Surveyed In
- Referenced Out

Previous Renewals

Monument(s) Found: (Condition and Source)
 2 1/2" DIA ALUM. CAP ON A 3/4" IRON PIPE PROTRUDING 1 FT OUT OF GROUND. PER CS 65/25-4 SET BY R.E. 4287 (THOMAS E SHRUM JR) NOTE CAP MARKED AS IF IN T27S.

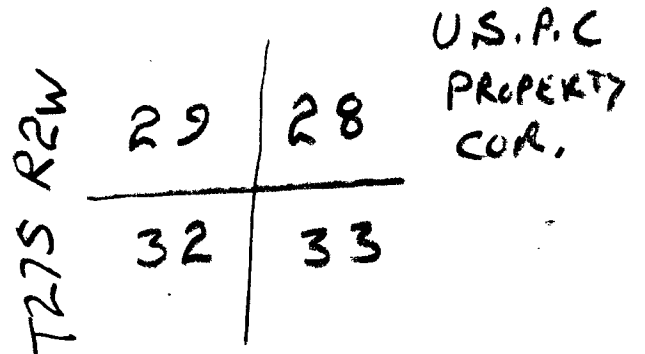

MONUMENT DETAIL

Accessories Found:

- 36" DIA 4 FT HIGH HEMLOCK. SCRIBING VISIBLE ON AN OPEN BLAZE "S32 BT" BEARS S60°W, 35.4 FT SOURCE UNKNOWN NO. BT TAG. (SILVER TAG ON BLAZE MARKED RE 4287)
- 27" DIA. R. CEDAR SCRIBING VISIBLE ON AN OPEN DOUBLE BLAZED "S29 BT" BEARS N26°W, 75.0 FT (1972 BT TAG BY AGE E A? BRG + DIST ON TAG S28°E, 75.0 FT) (SILVER TAG ON BLAZE MARKED RE 4287)
- 11" DIA. HEMLOCK WITH SCRIBING VISIBLE ON A PARTIALLY HEALED DOUBLE BLAZE "SEC COR S32 BT" BEARS S58°W 25.7 FT (1999 BT TAG BY GVN, BRG + DIST ON TAG N59°E 26.0 FT)
- 7" DIA. HEMLOCK WITH SCRIBING VISIBLE ON A PARTIALLY HEALED DOUBLE BLAZE "X BT" BEARS S38 1/2°E, 13.3 FT (1999 BT TAG BY GVN, BRG + DIST ON TAG N40°W, 13.30 FT)
- 11" DIA. D. FIR WITH SCRIBING VISIBLE ON A PARTIALLY HEALED DOUBLE BLAZE "28 SEC" BEARS N4°E, 7.7 FT (1999 BT TAG BY GVN BRG + DIST ON TAG S20°W, 7.75 FT)
- 8" DIA. D. FIR WITH SCRIBING VISIBLE ON A PARTIALLY HEALED DOUBLE BLAZE "SEC COR" BEARS N28°W 42.6 FT (1999 BT TAG BY GVN BRG + DIST ON TAG S30°E 43 FT)

NOTE: ALL BT TAGS ON ABOVE TREES MARKED T27S NOT T26S - FIRST TWO BTS HAVE IDENTICAL STYLE OF SCRIBING

SEE BACK

C.S. File No 67/31-8

RENEWAL

Monument Set (Procedure and Description)

NONE

Monument Detail

ACCESSORIES FD

18" NOW ROTTED REMAINS OF A HEMLOCK BEARS N54°E, 47.5 FT ORIG REC (N48°E, 47.5 FT).

10" NOW 30" DIA 3 FT HIGH HEMLOCK STUMP BEARS S21°E, 12.6 FT ORIG REC (S21°E, 13.2 FT). WE DID NOT OPEN

6" NOW ROTTED REMAINS OF A HEMLOCK BEARS S52°W 22.2 FT ORIG REC (S52°W, 26.4 FT).

NO EVIDENCE OF ORIG NW BT FOUND FALLS IN CAT ROAD.

N/A

New Accessories

NONE

Sketch of Monument, Accessories, and General Area

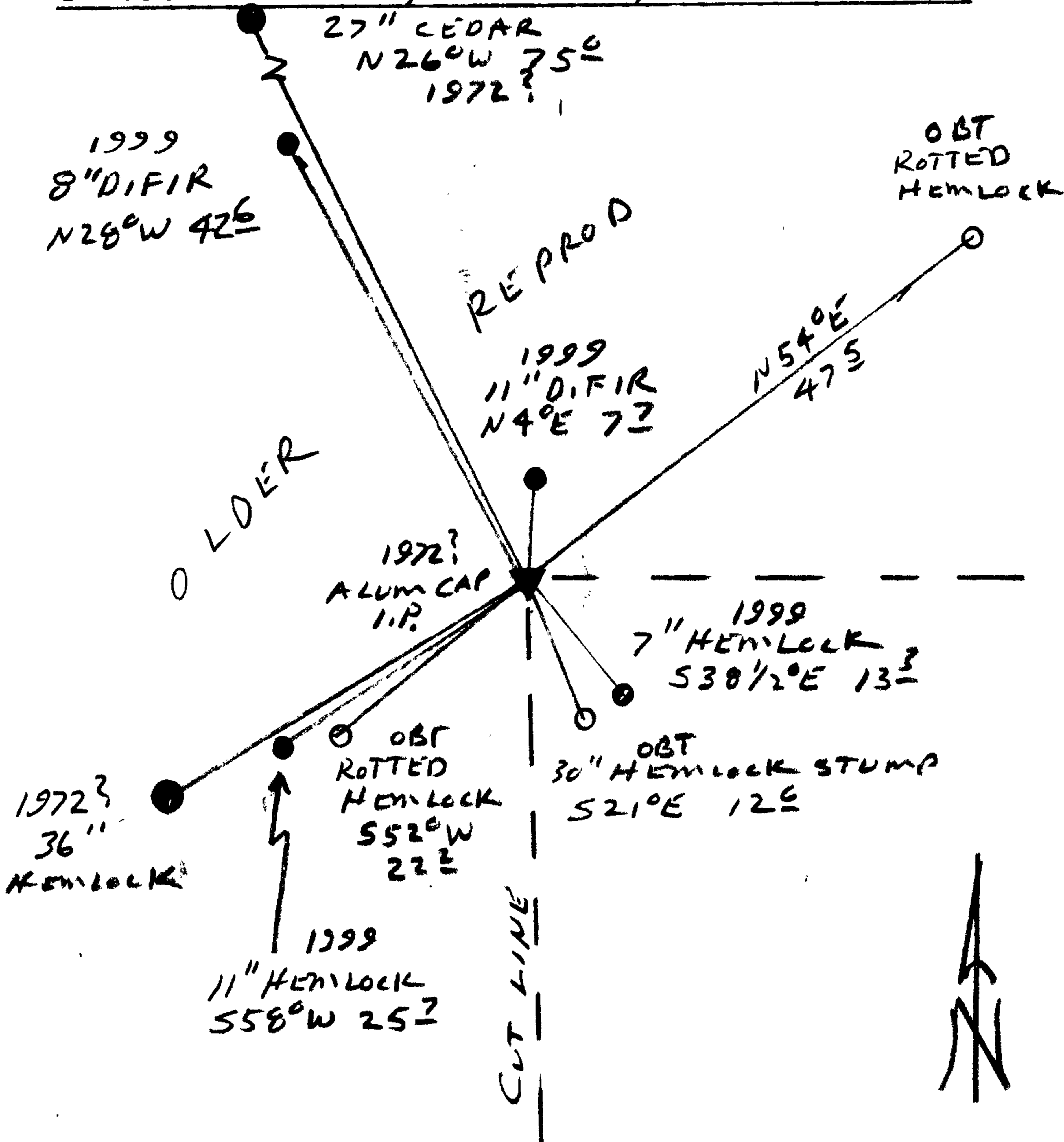

Location & Comments

RECEIVED A COPY OF AN UNRECORDED SURVEY BY GERALD NYGREN THAT DAVID EDWARDS RECENTLY ACQUIRED FROM SENECA TIMBER COMPANY NOW FILED AS CS 65/70-3 ON 4-15-2010

Comp. Declin. 16 1/2° E
Agency D L S O
Party Chief RANDY SMITH
Notekeeper RANDY SMITH
Witnesses STEVE FLAUS

Address

Surveyor's Seal

REGISTERED PROFESSIONAL LAND SURVEYOR

Randy W Smith RENEWAL 6-30-2010

OREGON JULY 25, 1990 RANDALL W. SMITH 2466