

GOVERNMENT CORNER RESTORATION FORM

FILED

Township 22S Range 6W Sec. 4

County DOUGLAS Date 3/1/2010 By JC
This survey consists of:

State OK Date 2-12-2010

No. 3006000

Corner Designation

5 | 4
8 | 9

Monument
Corner Rpt: 67/31-3

DOUGLAS COUNTY
Condition Report Only
 Not Found
 Renewed
 Unrecorded
 Surveyed In
 Referenced Out

Previous Renewals 1914, 1961, 1966

Monument(s) Found: (Condition and Source)

2 1/2" DIA BRASS CAP ON A
1 1/2" IRON PIPE PROTRUDING
12" OUT OF GROUND (1961)
1914 3/4" IRON ROD ALONG
SOUTHERLY EDGE OF BEIP PROTRUDING
6" OUT OF GROUND

COUNTY SURVEYORS OFFICE
T 22S R 6W
55 | 54
58 | 59
1961

Accessories Found:

1961 SW BT CONE
9" NOW 18" DIA 1 FT HIGH D. FIR STUMP, PARTIAL
BLAZE VISIBLE BEARS N00°E, 24.6 FT. 1961
3" NOW 9" DIA D. FIR WITH A FULLY HEALED BLAZE
BEARS S59 1/2°E 23.6 FT 1961
4" NOW DOWN 6" DIA D. FIR WITH BIT TAG. ROOT
HOLE BEARS N11°N 9.5 FT 1961
48" DIA 4 FT HEIGHT RETTED D. FIR STUMP, NO
SURVIVY DISK FD CENTER BEARS S83 1/2°W 24.0 FT 1966
(REC'D S 83 1/2°W 22.0 FT)
"T" IRON PROTRUDING 6" OUT OF GROUND BEARS
S75°E, 35.0 FT (RECORD S 75 3/4°E 41.91 FT.)
1961
33" MAPLE NOTED IN 1961, WES SINGLE BLAZE ABOVE
BURLE 5 FT ABOVE GROUND "SCRIBED" X" BEARS
S 23°E, 3.5 FT.

Monument Set (Procedure and Description)

NONE

N/A

New Accessories

18" DIA. D.FIR DOUBLE BLAZED AND SCRIBED "T225 R6W
S4 CS BT" BEARS N 82°E, 26.0 FT

11" DIA. D.FIR DOUBLE BLAZED AND SCRIBED "T225 R6W
S8 CS BT" BEARS S 20°W, 23.6 FT

Sketch of Monument, Accessories, and General Area

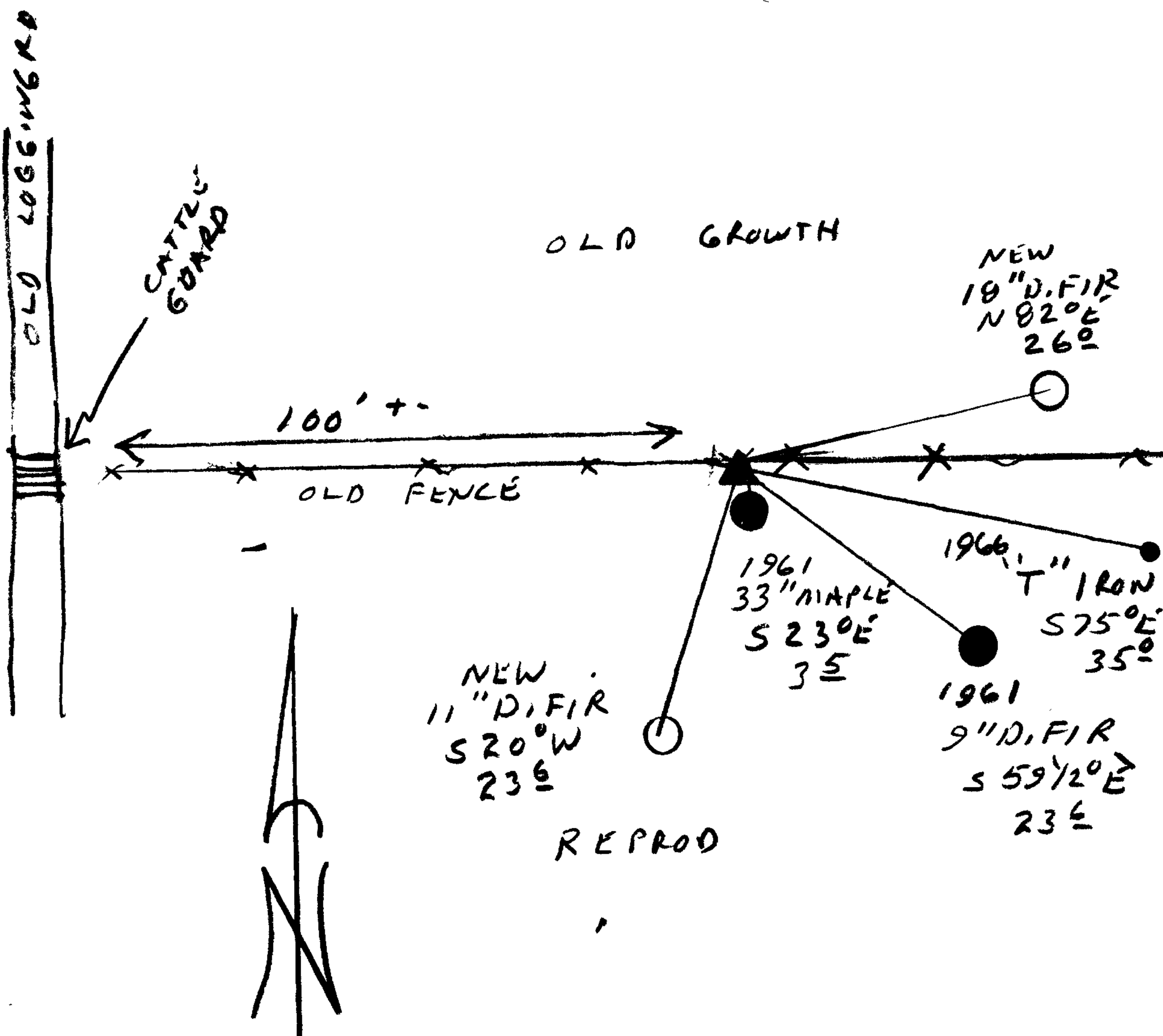

Location & Comments

CORNER LIES 1 FT SOUTH OF AN OLD E-W FENCE LINE, APPROX 100 FT EAST OF AN OLD LOGGING ROAD AND CATTLE GUARD

Comp. Declin. 16 1/2° E
Agency DC SO
Party Chief RANDY SMITH
Notekeeper STEVE FLAUS
Witnesses RANDY SMITH

Address

REGISTERED Surveyor's Seal
PROFESSIONAL
LAND SURVEYOR

Randy Smith

OREGON
JULY 25, 1990
RANDALL W. SMITH
2488

RENEWAL 6-30-2010