

FILED

Date: 4/7/2009 By: JC

This survey consists of:

Map: C.S. 67/30

Narrative:

Corner Rpt: C.S. 67/28-20

C.S. 67/28-21  
DOUGLAS COUNTY  
SURVEYOR

SURVEY IN  
SW 1/4 OF SEC. 35 T22S, R4W, W.M.  
DOUGLAS COUNTY OREGON  
FOR: DOUGLAS COUNTY LAND DEPARTMENT  
BY: DOUGLAS COUNTY SURVEYORS OFFICE  
APRIL 7, 2009

1/4 CORNER  
PLSS# 500140  
SEE 2009 DCSO RENEWAL



LEGEND	
□	SET METAL FENCE POSTS
●	FOUND BRASS CAP/IRON PIPE
+	FD. BLAZED TREE

SEC. 34

CAT ROAD

SEC. 35

NARRATIVE:

THE PURPOSE OF THIS SURVEY WAS TO MARK THE WEST BOUNDARY OF LAND OWNED BY DOUGLAS COUNTY.

FOUND MONUMENTS OF RECORD AT THE W 1/4 AND THE S1/16 CORNER OF SECTION 35 WERE TIED AND LINE POSTED WITH METAL FENCE POSTS AS SHOWN AND WOODEN LATHE WITH PINK FLAGGING.

BLAZED LINE BY PERSONS UNKNOWN WERE FOUND WEST OF SECTION LINE.

FIELD CREW: RANDY SMITH AND STEVE FLAUSE  
OFFICE: RANDY SMITH



REGISTERED  
PROFESSIONAL  
LAND SURVEYOR

*Randy W. Smith*

OREGON  
Randy W. Smith  
July 25, 1980  
LICENSE # 2489

EXPIRES: 6-30-2010

S. 1/16 CORNER  
PLSS# 500120  
SEE DCSO 2009 RENEWAL

C.S. File No 67/30



RENEWAL

Monument Set (Procedure and Description)

Monument Detail

N/A

New Accessories

17" DIA. G. FIR DOUBLE BLAZED AND SCRIBED  
S 1/16 S 35 CS BT BEARS N 10 E, 27.2 FT

5" DIA. D. FIR DOUBLE BLAZED AND SCRIBED  
S 1/16 BT BEARS N 74 W, 7.9 FT

METAL FENCE POST SET 1 FT SOUTH OF BC/IP

Sketch of Monument, Accessories, and General Area

Location & Comments

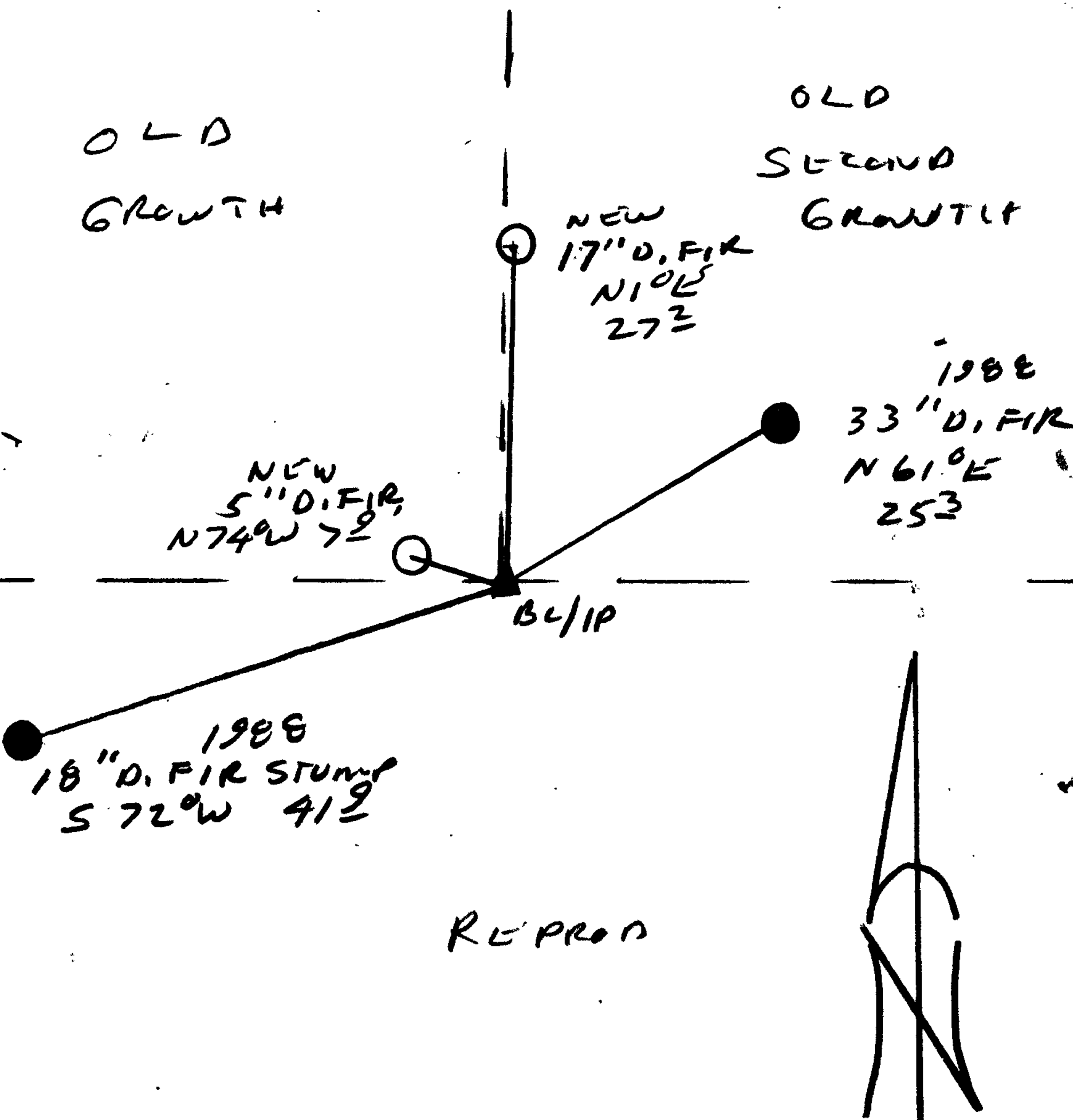

OLD GROWTH

OLD SECOND GROWTH

NEW 5" D. FIR, N 74 W 7.9

1988 33" D. FIR N 61 E 253

1988 18" D. FIR STUMP S 72 W 41.2

REPROD

Comp. Declin. 16 1/2 ° E

Agency DCSO

Party Chief RANDY SMITH

Notekeeper RANDY SMITH

Witnesses STONY FLAUSG

Address

REGISTERED Surveyor's Seal  
PROFESSIONAL  
LAND SURVEYOR

*Randy Smith*

OREGON  
JULY 25, 1990  
RANDALL W. SMITH  
2400

Renewal 6-30-2000

107128-20

GOVERNMENT CORNER RESTORATION FORM

Date: 3/9/2009 By: JC

Township 22S Range 4W Sec. 34

County DOUGLAS

This survey consists of:

State OR

Date 2-27-2009

No. 500140

Narrative: \_\_\_\_\_

Corner Rpt: 67/28-21

Corner Designation

1/4 S34 | S35

DOUGLAS COUNTY

SURVEYOR

Condition Report Only

Not Found

Renewed

Unrecorded

Surveyed In

Referenced Out

Previous Renewals 1964

MONUMENT DETAIL

Monument(s) Found: (Condition and Source)

FD 2 1/2" O.D. BRASS CAPON  
A 1 1/2" O.D. IRON PIPE, PROTRUDING  
4" OUT OF GROUND. (1964)

2" DIA IRON PIPE PROTRUDING  
12" OUT OF GROUND BEARS  
0.5 FT SW OF BC/1P (1944)

COUNTY SURVEYOR OFFICE

T 22S R 4W

1/4 S34/S35

1964

Accessories Found:

15" NOW 32" DIA D.FIR WITH A FULLY HEALED  
BLAZE, BEARS S 20° E, 8.7 FT (AGREES WITH REC) 1964

32" NOW 36" DIA 4 FT HIGH D.FIR STUMP  
WITH A FULLY HEALED BLAZE, BEARS N 42° W, 14.3 FT  
(AGREES WITH REC) 1964

24" ROTTED FIR STUMP BEARS N 69° E 36.2 FT  
(AGREES WITH REC)

