

GOVERNMENT CORNER RESTORATION FORM

FILED

Township 22S Range 4W Sec. 34

County Douglas

Date: 3/9/2009 By: JC

State OK

Date 2-27-09

No. _____

This survey consists of:

Map: _____

Narrative: _____

Corner Rpt: 67/28-20

Corner Designation

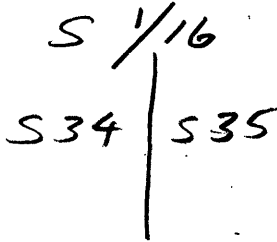

DOUGLAS COUNTY
Condition Report Only

Not Found

Renewed

Unrecorded

Surveyed In

Referenced Out

MONUMENT DETAIL

Previous Renewals M106-59

Monument(s) Found: (Condition and Source)

FD 2" IRON PIPE WITH 2 1/2" BRASS CAP PROTRUDING 3" OUT OF GROUND (1988)

T22S R4W
S 1/16
S34 | S35
PLS 752
1988

Accessories Found:

22" NOW 33" DIA D.FIR WITH A FULLY HEALED SINGLE BLAZE BEARS N61°E, 25.3 FT (REL N64°E, 24.0 FT) 1988

15" NOW 18" DIA 2 FT HIGH D.FIR STUMP WITH A FULLY HEALED BLAZE, BEARS S72°W 41.9 FT (REL S75°W 41.2 FT) 1988

C.S. File No 67/28-20

RENEWAL

Monument Set (Procedure and Description)

Monument Detail

N/A

New Accessories

17" DIA. G. FIR DOUBLE BLAZED AND SCRIBED
S 1/16 S 35 CS BT BEARS N 10 E, 27.2 FT

5" DIA. D. FIR DOUBLE BLAZED AND SCRIBED
S 1/16 BT BEARS N 74 W, 7.9 FT

METAL FENCE POST SET 1 FT SOUTH OF BC/IP

Sketch of Monument, Accessories, and General Area

Location & Comments

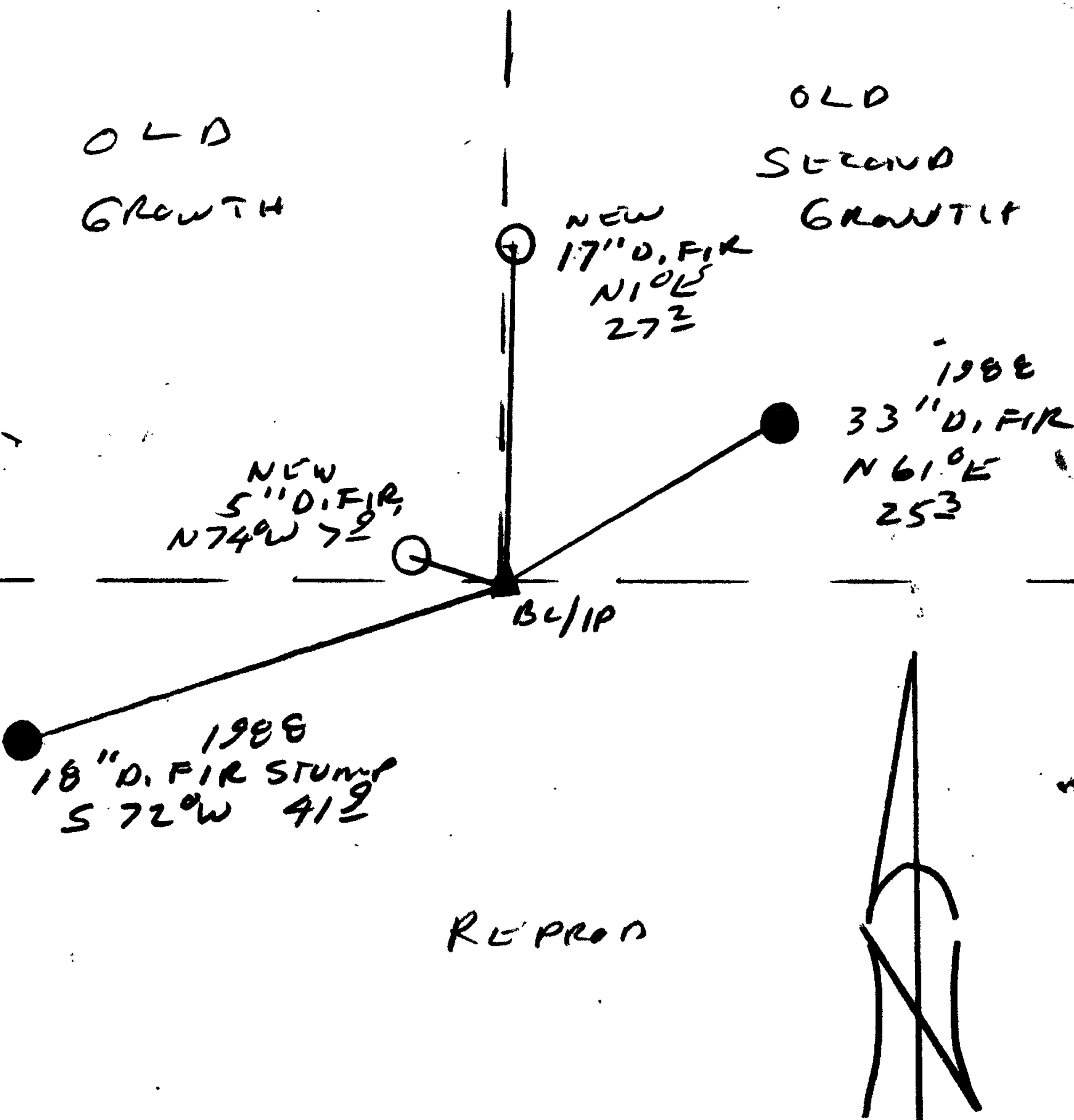

OLD GROWTH

OLD SECOND GROWTH

NEW 5" D. FIR, N 74 W 7.9

1988 33" D. FIR N 61 E 253

1988 18" D. FIR STUMP S 72 W 41.2

REPROD

Comp. Declin. 16 1/2 ° E

Agency DCSO

Party Chief RANDY SMITH

Notekeeper RANDY SMITH

Witnesses STONY FLAUSCH

Address

REGISTERED Surveyor's Seal
PROFESSIONAL
LAND SURVEYOR

Randy Smith

OREGON
JULY 25, 1990
RANDALL W. SMITH
2400

Renewal 6-30-2000