

GOVERNMENT CORNER RESTORATION FORM

Date: 1-15-2009 By: JC

This survey consists of:

Township 29S Range 5W Sec. 6

County Douglas Map: \_\_\_\_\_

State OK Date 1-8-09

No. 140600 Narrative: \_\_\_\_\_

Corner Rpt: 67/28-3

Corner Designation

$\frac{1}{4} \frac{S6}{S7}$

- DOUGLAS COUNTY SURVEYOR
- Condition Report Only
- Not Found
- Renewed
- Unrecorded
- Surveyed In
- Referenced Out

Previous Renewals 1969

Monument(s) Found: (Condition and Source)

FD 2 1/2" BRASS CAP ON A 1 1/2"  
O.D IRON PROTRUDERS 12" OUT  
OF GROUND (1969)

TWP 29S R5W

$\frac{1}{4} \frac{S6}{S7}$

ENG NO.  
2128

NOV 1969

Accessories Found:

26" NOW 30" DIA. W. OAK WITH A FULLY HEALED DOUBLE  
BLAZE BEARS N 34° W, 264.4 FT (KCC N 34° W 263.8 FT) 1969

SW BT GONE

RENEWAL

Monument Set (Procedure and Description)

Monument Detail

N/A

N/A

New Accessories

38" DIA W. OAK DOUBLE BLAZED AND SCRIBED "Y456 CS BT"  
BEARS N 41° E 220.6 FT

9" DIA. W. OAK DOUBLE BLAZED AND SCRIBED "Y457 CS BT"  
BEARS S 80 1/2° E, 149.6 FT

Sketch of Monument, Accessories, and General Area

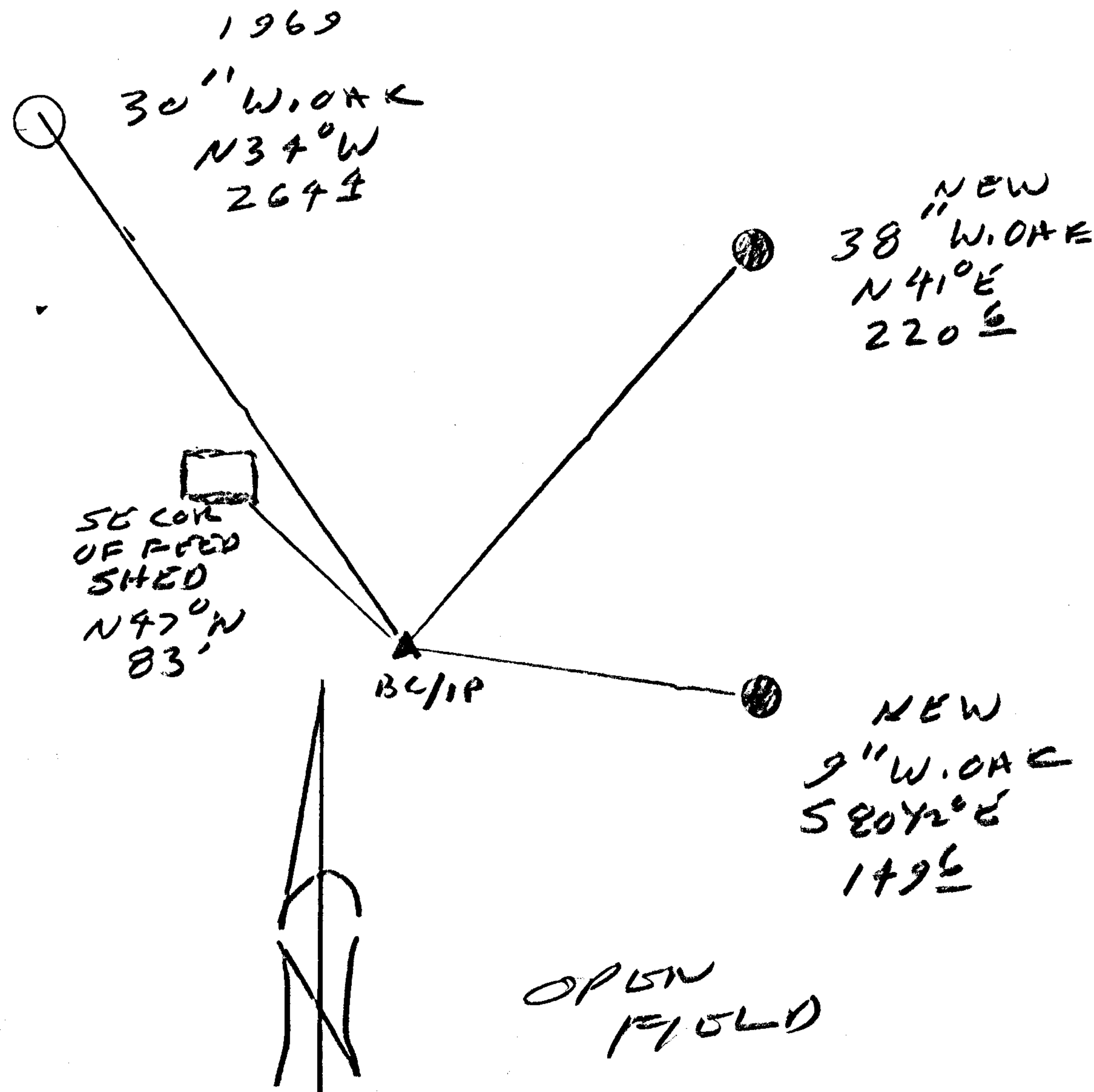

Location & Comments

SE COR OF FEED  
SHED BEARS N 47° W 83'

Comp. Declin. 16 1/2° E  
Agency DESO  
Party Chief RANDY SMITH  
Notekeeper RANDY SMITH  
Witnesses STEVE FLAUSCH

Address

REGISTERED  
PROFESSIONAL Surveyor's Seal  
LAND SURVEYOR

*Randall W. Smith*

OREGON  
JULY 25, 1999  
RANDALL W. SMITH  
2468

Renewal 6-30-2010