

GOVERNMENT CORNER RESTORATION FORM

FILED

Township 235 Range 7W Sec. 20

County DOUGLAS Date: 7/2/08 FRJC

State OR

Date JUNE 12, 2008

No. 045010 Map: _____

This survey consists of:

Corner Designation

NE COR ZIBA DIMMICK
DLC No 45

Narrative: _____
Corner Rpt: 67/25-56

- DOUGLAS COUNTY
- Not a SURVEYOR
- Renewed
- Unrecorded
- Surveyed In
- Referenced Out

Previous Renewals 1938, 1966, 1979

Monument(s) Found: (Condition and Source)

- 1" DIA. IRON ROD, TOP IS MUSHROOMED, PROJECTS 2" ABOVE GROUND
- 3/4" DIA. B.L.M. BRASS CAP, PROPERLY MARKED, IS FOUND LEANING NORTHERLY APPROX. 0.8 FT.
- 3/4" DIA. X 16" LONG I. PIPE IS FOUND LOOSE, ON TOP OF GROUND NEXT TO PREV. DESCRIBED MONUMENTS.

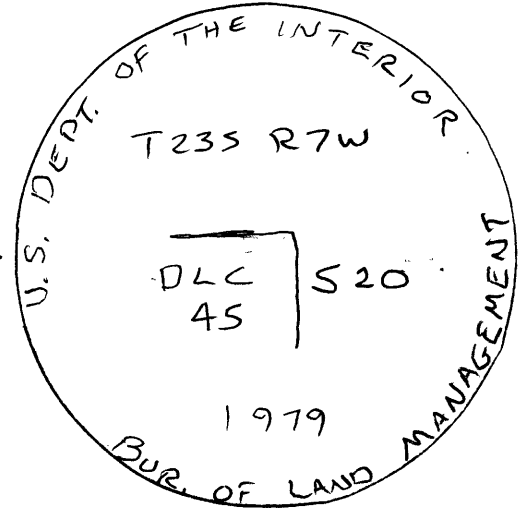

Accessories Found:

- 15" Now 16" DIA. X 3 1/2 FT. TALL ROTTING W. OAK STUMP. ILLEGIBLE REVERSE SCRIBES VISIBLE, FACE HAS ROTTED AWAY. BEARS S45°W, 37.6 FT. (AGREES W/DCSO RECORDS) 1938 BT
- 17" Now 23" DIA. X 3 FT. TALL ROTTED D. FIR STUMP. ILLEGIBLE SCRIBES VIS. ON OPENED FACE. BEARS N16 3/4°E 61.0 FT. (AGREES W/REC) 1979 BT
- 10" Now 15" X 1 FT. TALL ROTTED W. OAK STUMP. NO MARKS VISIBLE BEARS S15°E, 24.3 FT. (AGREES W/REC) 1966 BT

C.S. File No 67/25-56

RENEWAL

Monument Set (Procedure and Description)

Monument Detail

RETURNED BC/IP TO PLUMB POSITION WITHOUT REMOVING FROM GROUND. IRON POST WAS NOT BENT. 1" I. ROD ENDS UP ON NORTH EDGE OF BC/IP. RETURNED 3/4" J. PIPE TO SOUTH EDGE OF BC/IP.

BC/IP IS FLUSH WITH GROUND NOW.

New Accessories

21" DIA. B. OAK, DOUBLE BLAZED & SCRIBED "NE DLC 45 CS BT" BEARS S 45 1/4° W, 52.6 FT.

10" DIA. D. FIR, DOUBLE BLAZED & SCRIBED "NE DLC 45 CS BT" BEARS N 66 1/2° W, 46.3 FT.

4" DIA. D. FIR, DOUBLE BLAZED & SCRIBED "X" ON HIGH BLAZE, "CS BT" ON LOW BLAZE. BEARS N 34° E, 28.8 FT.

NO SUITABLE TREES IN SE QUADRANT WITHIN REASONABLE DIST.

Sketch of Monument, Accessories, and General Area

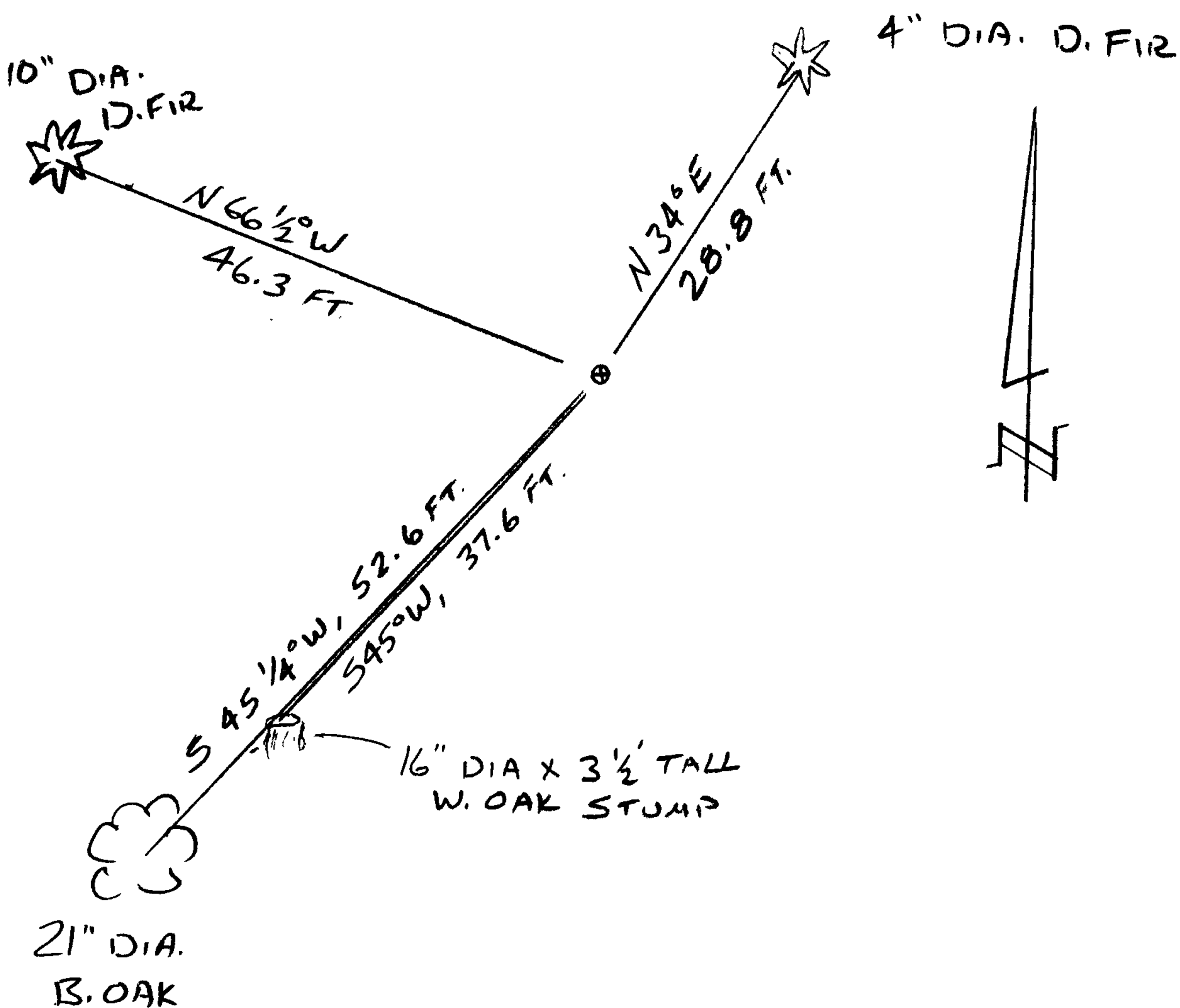

Location & Comments

CORNER LIES ON GENTLE WEST FACING SLOPE, IN YOUNG TREE PLANTATION OVERGROWN IN BLACKBERRIES. 4 FT. STEEL FENCE POST IS DRIVEN ON EAST SIDE OF BC/IP

Comp. Declin. 16 1/4° E
Agency D.C.S.O.
Party Chief S. FLAUSE
Notekeeper J. PIKE
Witnesses

Address

Surveyor's Seal

REGISTERED PROFESSIONAL LAND SURVEYOR

Randall W. Smith

RENEWAL 6-30-08

OREGON JULY 25, 1990 RANDALL W. SMITH 2489