

GOVERNMENT CORNER RESTORATION FORM

FILED

Date: 3/18/2008 By: JC

This survey consists of:

Township 27S Range 4W Sec. 13 County DOUGLAS Map: \_\_\_\_\_

State OR Date 3/10/2008 No. 640400 Narrative: \_\_\_\_\_  
Corner Rpt: 67/25-22

Corner Designation

1/4 S 13  
S 24

DOUGLAS COUNTY  
SURVEYOR

- Condition Report Only
- Not Found
- Renewed
- Unrecorded
- Surveyed In
- Referenced Out

Previous Renewals 1963, 2000

MONUMENT DETAIL

Monument(s) Found: (Condition and Source)

1917 BRASS CAP ON 1" DIA PIPE  
LOOSE IN PLACE, PIPE IS RUSTED  
THROUGH. BC IS MARKED AS PER RECORD  
AND PROJECTS 12" ABOVE GROUND.

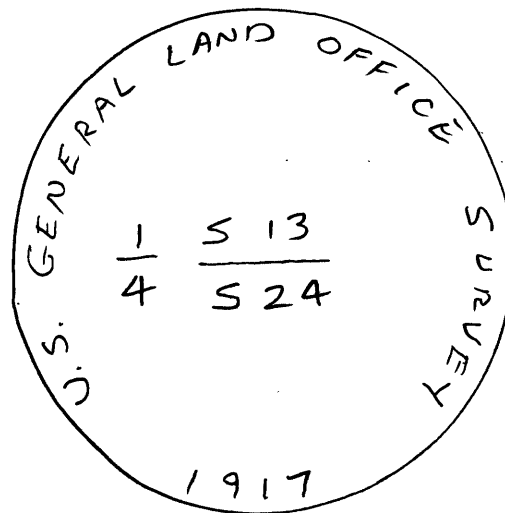

Accessories Found:

- 18" FIR NOW 21" DIA. HEMLOCK, PARTIALLY HEALED LOWER BLAZE W/SCRIBE  
"1/4 S 24 BT" VISIBLE, ALSO HAS SMALL UPPER PARTIALLY HEALED BLAZE, NO SCRIBE  
VISIBLE. BEARS S 43 1/2° W, 10.8 FT. (AGREES W/REC.) 2000 BT
- 8" NOW 9" HEMLOCK, FALLEN, OUT OF POSITION (REC. N 33 1/4° E 79.4 FT)  
2000 BT
- 14" NOW 27" DIA X 4 FT. TALL R. CEDAR STUMP, FULLY HEALED DOUBLE  
BLAZE VISIBLE BEAR N 78 1/2° E, 22.7 FT. (AGREES W/REC.) 1963 BT
- CEDAR SNAG NOW GONE DUE TO RECENT LOGGING (REC. S 70° W, 30.4 FT)  
1963 BT

C.S. File No 67/25-22

RENEWAL

Monument Detail

Monument Set (Procedure and Description)

LOCATED BROKEN LOWER PORTION OF IRON PIPE AND REPLACED WITH NEW B.C./I.P. (MARKED AS SHOWN) IN EXACT SAME POSITION. BROKEN PORTION OF 1917 B.C./I.P. IS RESET ON SOUTH SIDE OF NEW MONUMENT.

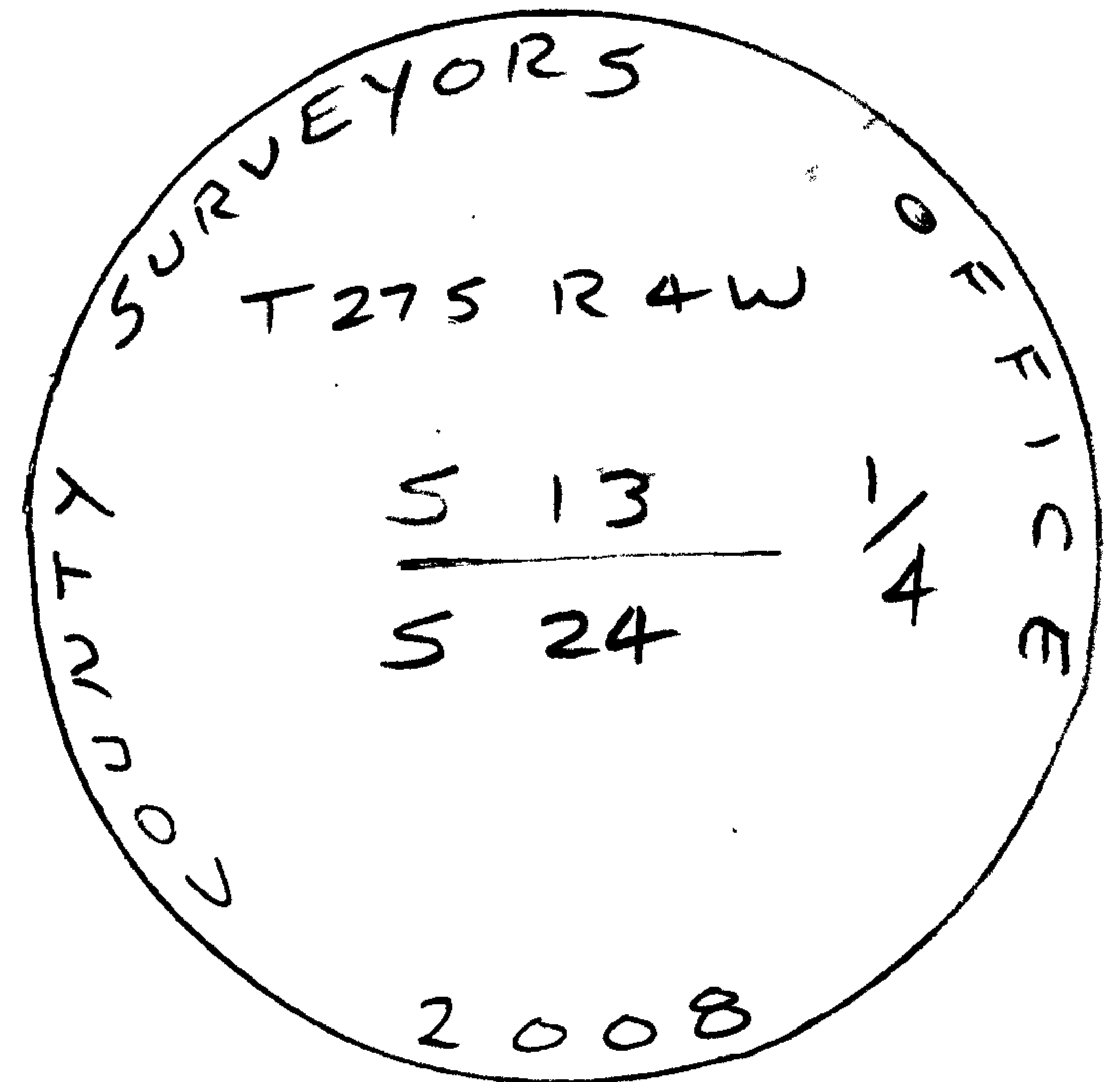

New Accessories

9" DIA. D. FIR DOUBLE BLAZED & SCRIBED "1/4 S13CS BT" BEARS N38°W 80.0 FT. 4" DIA. D. FIR, DOUBLE BLAZED & SCRIBED "X" ON HIGH BLAZE & "CSBT" ON LOW BLAZE BEARS S57 1/2°E, 31.2 FT.

Sketch of Monument, Accessories, and General Area

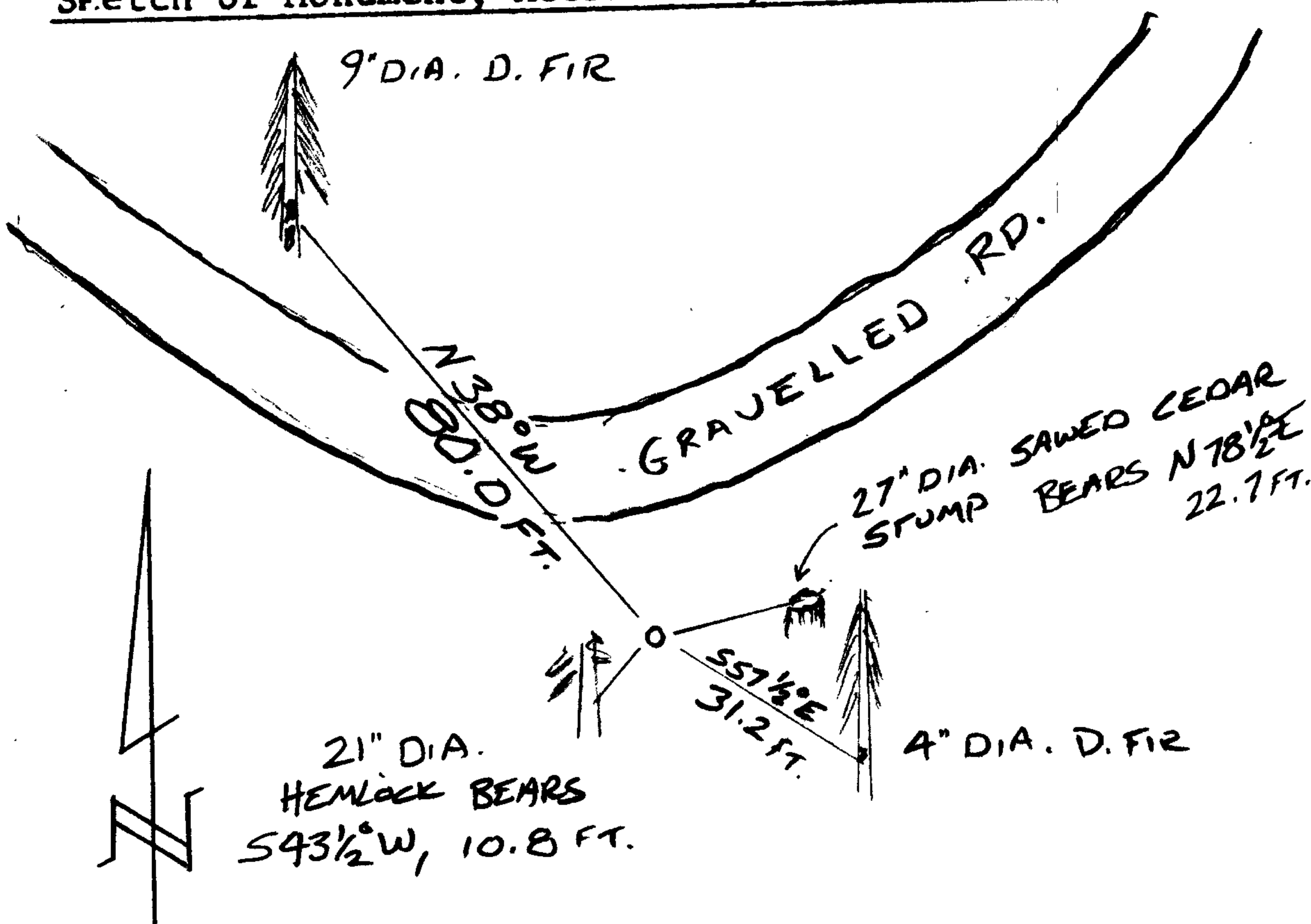

Location & Comments

CORNER LIES 45' ± SOUTHERLY FROM CENTER OF GRAVELLED RD.

Comp. Declin. 16 1/4° E Agency D.C.S.O. Party Chief S. FLAISE Notekeeper J. PIKE Witnesses

Address

Surveyor's Seal

REGISTERED PROFESSIONAL LAND SURVEYOR

Handwritten signature and date: RENEWAL 6-30-08

OREGON JULY 25, 1990 RANDALL W. SMITH 2469