

GOVERNMENT CORNER RESTORATION FORM

FILED

Township 265 Range 3W Sec. 6

County DOUGLAS Date: 3/7/2008 By: JC

State OR Date 2/20/08

No. 100600 Narrative: _____

Corner Designation

SW COR SEC. 6

Corner Rpt: 67/25-15

- DOUGLAS COUNTY SURVEYOR
 Condition Report Only
 Not Found
 Renewed
 Unrecorded
 Surveyed In
 Referenced Out

Previous Renewals 1921, 1966

Monument(s) Found: (Condition and Source)

2 1/2" DIA BRASS CAP PROPERLY MARKED ON 1 1/4" O.D. IRON PIPE, LOOSELY SET IN SCATTERED PILE OF STONE BC/IP PROJECTS 18" ABOVE GROUND.

A 1 3/4" DIA X 33" LONG SPLINED AXLE IS FOUND LOOSE ON TOP OF GROUND ON WEST SIDE OF BC/IP

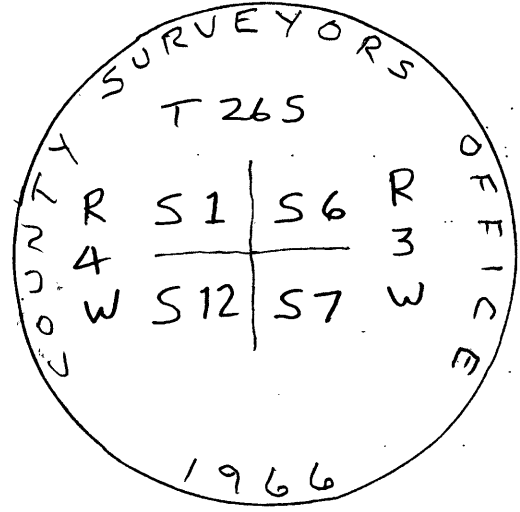

Accessories Found:

- BURNT CEDAR STUMP APPROX. 2 FT. TALL, INDETERMINATE DIA. SHOWS OLD AXE MARKS ON NORTH SIDE BEARS S 4° W, 9.9 FT. (AGREES W/REG) 1921 BT
- 14" NOW 30" DIA. X 2 FT. TALL D. FIR STUMP, CHOPPED INTO TOP AND FOUND PARTIAL SCRIBING ON OLD FACE. BEARS S 88 3/4° W, 100.4 FT (REG. S 88° W, 102.8 FT) 1966 BT

