

FILED

GOVERNMENT CORNER RESTORATION FORM

Date: 1-24-2008 By: JC

Township 32S Range 4W Sec. 6

County DOUGLAS This survey consists of:

State OREGON Date DEC. 13, 2007

No. 120600 Narrative: _____

Corner Rpt: 67/25-1

Corner Designation

W ¹/₁₆ $\frac{S6}{S7}$

DOUGLAS COUNTY

- Condition Survey Report Only
- Not Found
- Renewed
- Unrecorded
- Surveyed In
- Referenced Out

Previous Renewals NONE

MONUMENT DETAIL

Monument(s) Found: (Condition and Source)

A 3.25 INCH DIAMETER BRASS CAP
 (MARKED AS AT RIGHT) ON A 2.5 INCH
 O.D. IRON PIPE FIRMLY SET AND PRO-
 TRUDING APPROXIMATELY 6 INCHES
 ABOVE GROUND.

U.S. DEPT. OF THE INTERIOR

W ¹/₁₆ $\frac{S6}{S7}$

1971

BUR. OF LAND MANAGEMENT

Accessories Found:

EVIDENCE OF TWO ORIGINAL B.T.S FOUND.
 A WHITE FIR 8 INS. DIAM. NOW A SHATTERED AND ROTTED 1 1/2 FOOT TALL
 FIR STUMP OF INDETERMINABLE DIAMETER WITH A PROPERLY SCRIBED
 SINGLE BLAZE FACE STILL INTACT, BEARS N 3° W, 9 1/2 FEET DISTANT (AS
 PER RECORD)
 A FIR 12 INS. DIAM. NOW A 22 INCH D.B.H. DOUGLAS FIR WITH A FULLY
 HEALED SINGLE BLAZE BEARS S 8° E, 15 1/2 FEET DISTANT (AS PER RECORD)

C.S. File No 67/25-1

RENEWAL

Monument Detail

Monument Set (Procedure and Description)

N/A

N/A

New Accessories

A 15 INCH D.B.H. DOUGLAS FIR SCRIBED "W 1/16 S6 CS 13T" ON A DOUBLE BLAZE BEARS N 4 1/2° E, 182 FEET DISTANT

Sketch of Monument, Accessories, and General Area

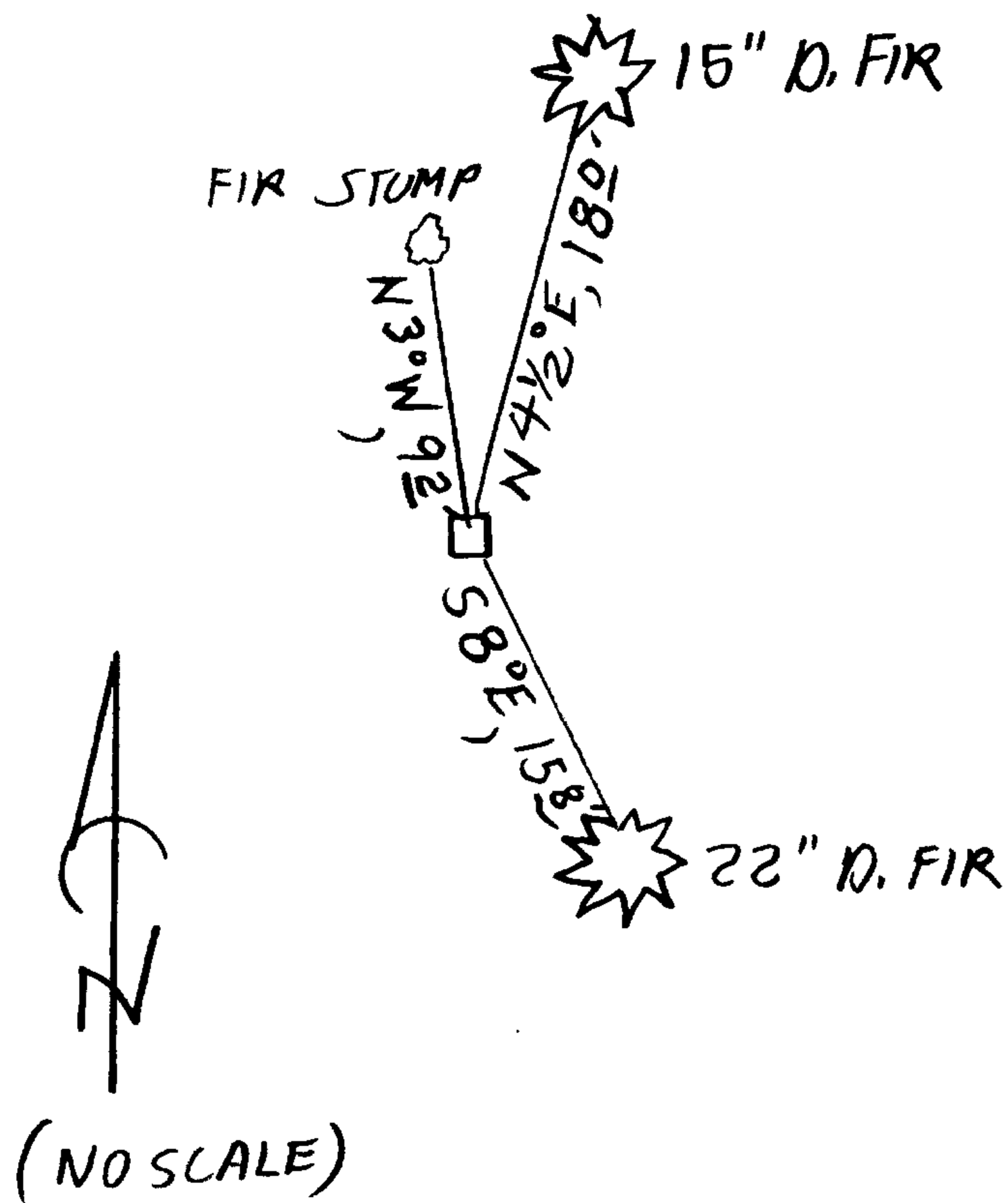

Location & Comments

CORNER IS ON MODERATE NE SLOPE NEAR BOTTOM OF STEEP NE RUNNING RIDGE COR. IS ALSO APPROX. 300 FT. NORTH OF NE-SW SWITCH-BACK IN GRAVELLED FOREST ACCESS RD.

Comp. Declin. 16 1/4° E
Agency RCSI
Party Chief S. J. FLAUSE
Notekeeper Stephen Robert Flause
Witnesses KODY D. INDA

Address

Surveyor's Seal

REGISTERED PROFESSIONAL LAND SURVEYOR

Handwritten signature and number: 6-3008

OREGON
JULY 25, 1990
RANDALL W. SMITH
2488