

GOVERNMENT CORNER RESTORATION FORM

FILED

Date: 9/26/2007 By: JC

Township 22S Range 6W Sec. 10

County Douglas

This survey consists of:  
Map: \_\_\_\_\_

State OR Date 9-18-07

No. 44050

Narrative: \_\_\_\_\_  
Corner Rpt: 67/24-19

Corner Designation

SOUTH  $\frac{1}{4}$  SEC. 10

DOUGLAS COUNTY

- Condition Report Only
- Not Found
- Renewed
- Unrecorded
- Surveyed In
- Referenced Out

MONUMENT DETAIL

Previous Renewals 1928, 1949, 1961

Monument(s) Found: (Condition and Source)

- 2 1/2" DIA BRASS CAP PROPERLY MKD. ON 1 1/4" O.D. IRON PIPE, PROJECTS 8" ABOVE GROUND. 1961 MON.
- 1" DIA. IRON ROD; 2" BELOW GROUND LEVEL BEARS N5 1/4° E, 1.75 FT. 1949 MON.
- 1/2" IRON PIPE NOT FOUND 1928 MON.

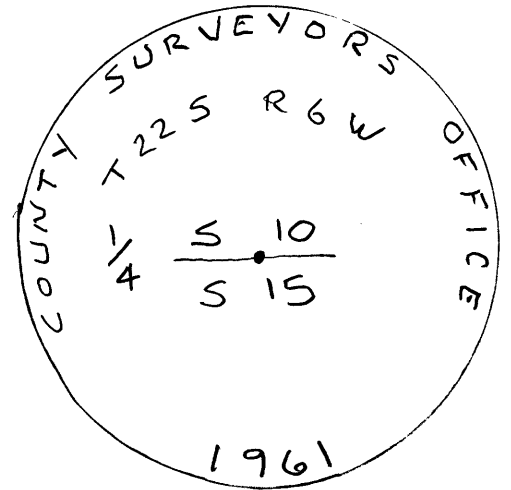

Accessories Found:

- BRACE POLE 6-76-77 A WITH 2 NAILS FORMING A POINT BEARS S63°W, 53.5 FT. MEAS. TO POINT OF NAILS. (POLE LEANS, AGREES WITH REC. WHEN MEAS. TO POINT FORMED BY NAILS) 1961
- POWER POLE DE 73, NAILS MISSING, BEARS N68 1/2° W, 139.0 FT. MEAS. TO SIDE CENTER (AGREES W/REC.) 1961
- 16" NEW 38" DIA LOCUST NO MARKS VISIBLE BEARS N 87 1/2° W, 455.1 FT. (REC N 88° 20' W, 455.1 FT.) 1928 BT
- 3/4" I.R. IN R/W FENCE NOW BENT NORTHERLY, PLUMB POSITION OF I.R. BEARS SOUTH, 27.0 FT. (AGREES W/REC.) 1961
- "X 1/4" IN OLD BRIDGE WING WALL NOT FOUND 1928
- 3'x3' X IN BRIDGE GAVE, BRIDGE NOW REPLACED BY CULVERT 1961

C.S. File No 67/24-19

C

