

GOVERNMENT CORNER RESTORATION FORM

FILED

Date: 9-26-2007 By: JC
Survey consists of:

Township 25S Range 6W Sec. 7 County DOUGLAS

State OR Date 9-12-2007 No. 200540

Native: _____
Corner Rpt: 67/24-18

Corner Designation

EAST 1/4 COR SECTION 7

DOUGLAS COUNTY
Condition: Survey Post Only
 Not Found
 Renewed
 Unrecorded
 Surveyed In
 Referenced Out

Previous Renewals 1909 1958

MONUMENT DETAIL

Monument(s) Found: (Condition and Source)

2 1/2" DIA. BRASS CAP PROPERLY MARKED, FIRMLY SET, PROJECTS 16" ABOVE GROUND. NOTED BRASS CAP IS SITUATED APPROX. N45°W

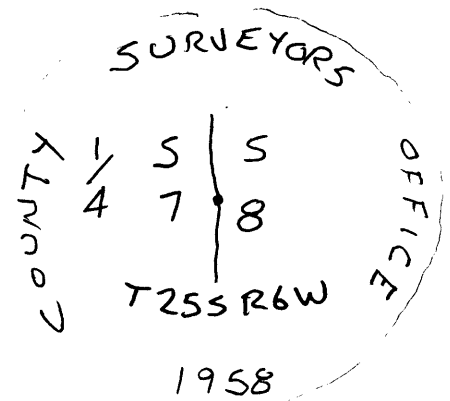

Accessories Found:

- 61" NOW A SHATTERED ROTTED 10 FT. TALL FIR STUMP NO MARKS VISIBLE, BEARS N60°W, 17.8 FT (AGREES W/REC.) 1909 BT
- BOTH 1958 BT'S NOW GONE

C.S. File No 67/24-18

