

FILED

GOVERNMENT CORNER RESTORATION FORM

Date: 9/26/07 By: X
This survey consists of: Map

Township 24 S Range 6 W Sec. 23 County Douglas

State OR Date 7-23-2007 No. 600300

Narrative: _____
Corner Rpt: 67/24-3

Corner Designation

SE COR SEC. 23

DOUGLAS COUNTY
SURVEYOR

- Condition Report Only
- Not Found
- Renewed
- Unrecorded
- Surveyed In
- Referenced Out

Previous Renewals 1919, 1962

Monument(s) Found: (Condition and Source)

2 1/2" D.I.A. BRASS CAP ON 1/4" O.D. IRON PIPE, FIRMLY SET, PROJECTS 10" ABOVE GROUND. PROPERLY MKD

A 3" X 5" SANDSTONE WITH "T" CHISELED ON TOP IS FOUND ON SOUTH SIDE OF IRON PIPE. STONE PROJECTS 6" ABOVE GROUND.

MONUMENT DETAIL

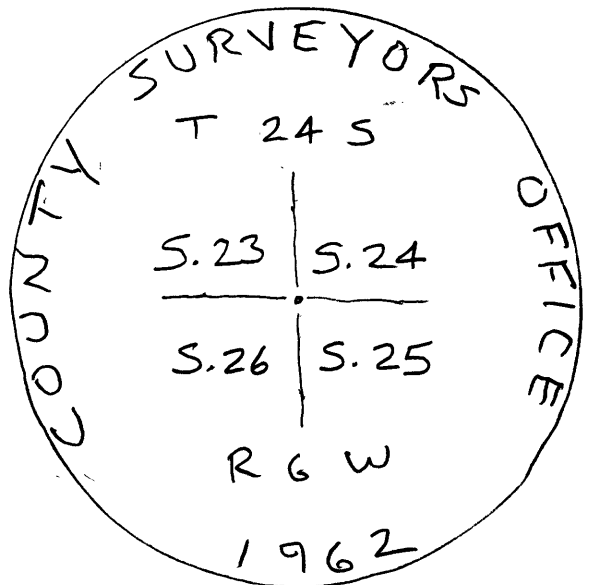

Accessories Found:

8" NOW 26" D.I.A. W. OAK, FULLY HEALED DOUBLE BLAZE BEARS S 32 1/2° W, 317.1 FT. (AGREES W/REC) 1962 BT

C.S. File No 67/24-3

