

GOVERNMENT CORNER RESTORATION FORM

FILED MAY 22 2007

FILED

Township 29 S Range 3 W Sec. 29 County DOUGLAS Date: 5/22/07 Pr. X

State OR Date APR. 23, 2007 No. 2DD200 This survey consists of:

Corner Designation

SW COR SEC. 29	30	29
	31	32

67/21-30

- Condition Report Only
- Not Found
- Renewed
- Unrecorded
- Surveyed In
- Referenced Out

Previous Renewals 1962

Monument(s) Found: (Condition and Source)

2 1/2" DIA. BRASS CAP ON 1 1/4" O.D. IRON PIPE. PROJECTS 19" ABOVE GROUND, FIRMLY SET.

MONUMENT DETAIL

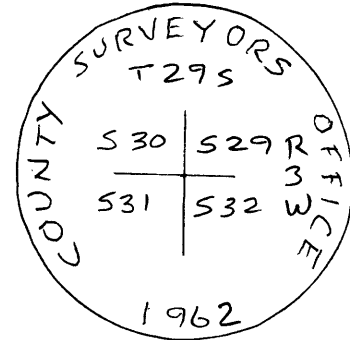

Accessories Found:

- 12" NOW 14" DIA. X 8 FT. TALL ROTTEN D. FIR SNAG SCRIBING VISIBLE IN ROTTED UPPER BLAZE, LOWER BLAZE HEALED BEARS N 49° E, 3.4 FT. (REC. N 44° E, 3.4 FT.) 1962 BT
- 12" NOW 18" DIA. I. CEDAR, HEALED DOUBLE BLAZE FAINT, BEARS S 13 1/2° E, 35.9 FT. (REC. S 12° E, 35.9 FT.) 1962 BT.
- 20" NOW 22" DIA. X 4 FT. TALL, D. FIR ^{STUMP} HEALED DOUBLE BLAZE VISIBLE BEARS N 10° W, 22.3 FT. (AGREES W/REC) 1962 BT
- 58" R. FIR, NOW BLOWN DOWN AND OUT OF POSITION (REC. S 30° W 34.2 FT.) 1962 BT

C.S. File No 67/21-30

