

RENEWAL

Monument Detail

Monument Set (Procedure and Description)

POSITIONED TOTAL STATION ON LINE WITH FOUND 1/2" I.R. (1955 M11-16) AND 5/8" I.R. (1963 M24-77) AND EXTENDED RECORD DIST. 272.7 FT. FROM 5/8" I.R. (REC S89°48'E 272.7 FT. M24-77)

AT CORNER POSITION SET 5/8" X 5 FT. LONG IRON ROD WITH 1/2" DIA. ALUM. CAP MARKED "DOUGLAS CO. SURVEYOR TSCOR 2007". PROJECTS 3" ABOVE GROUND

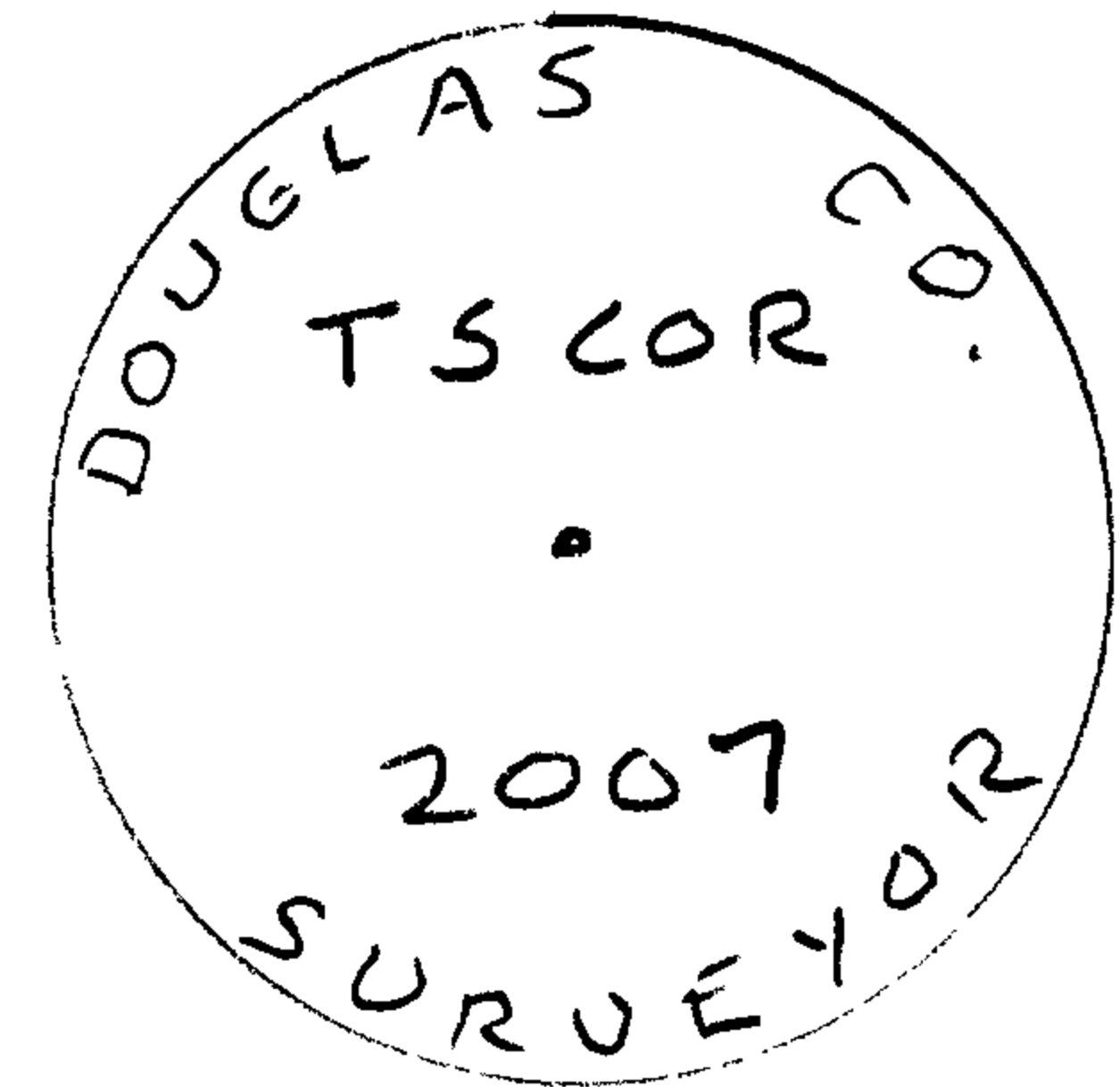

New Accessories

28" DIA. MAPLE, DOUBLE BLAZED & SCRIBED "T275 RAW S31 CSBT" BEARS NORTH, 64.5 FT. TREE IS IN N-S FENCE LINE

13" DIA. ALDER, DOUBLE BLAZED & SCRIBED "T285 RAW S6 CSBT" BEARS S71°E, 3.0 FT.

Sketch of Monument, Accessories, and General Area

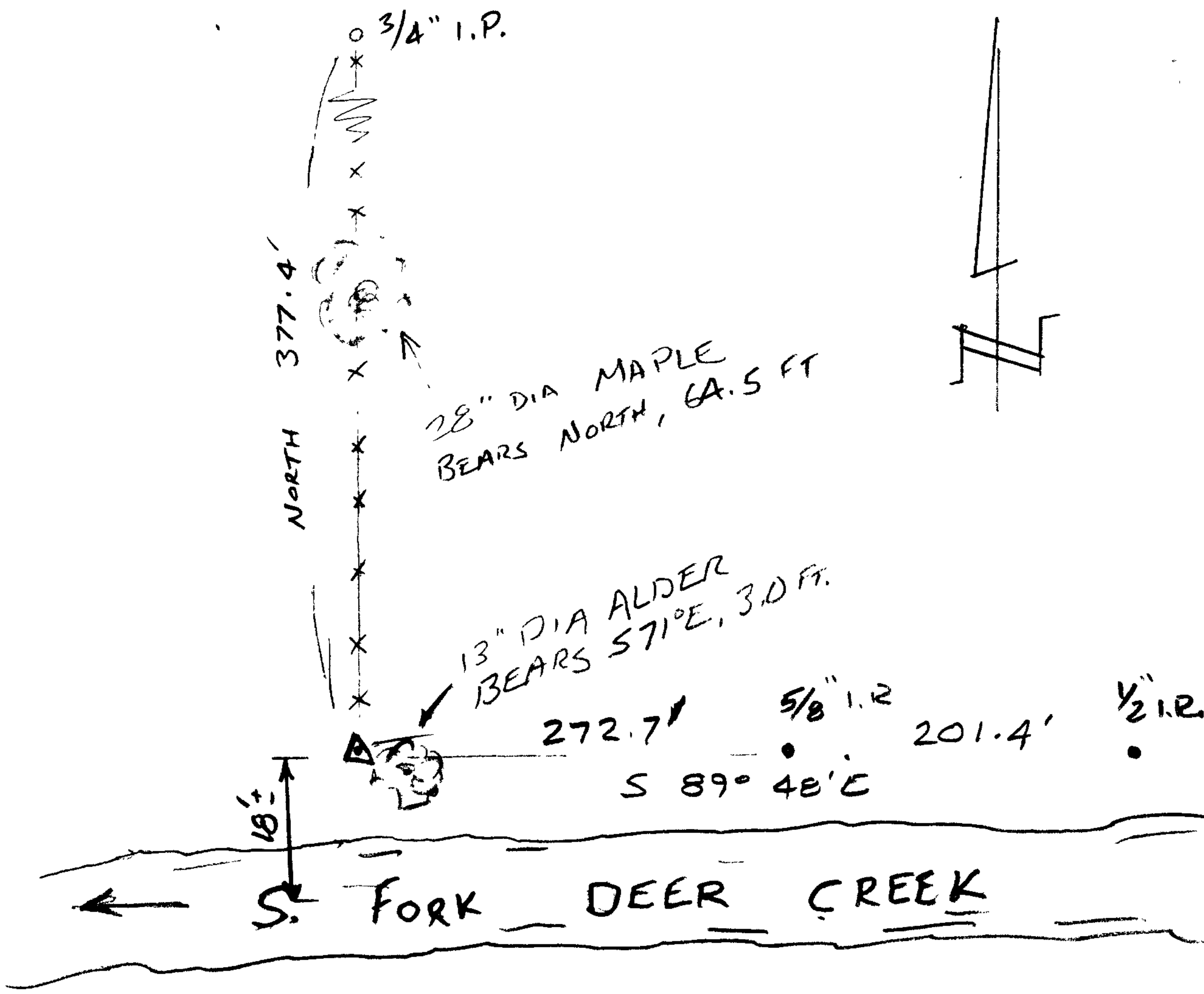

Location & Comments

CORNER LIES APPROX. 18 FT. NORTH OF THREAD, S. DEER CREEK, IN FLOODWAY.

C042610A

Comp. Declin. 16 1/4° E
 Agency D.C.S.O.
 Party Chief S. FLAUSE
 Notekeeper J. PIKE
 Witnesses

Address

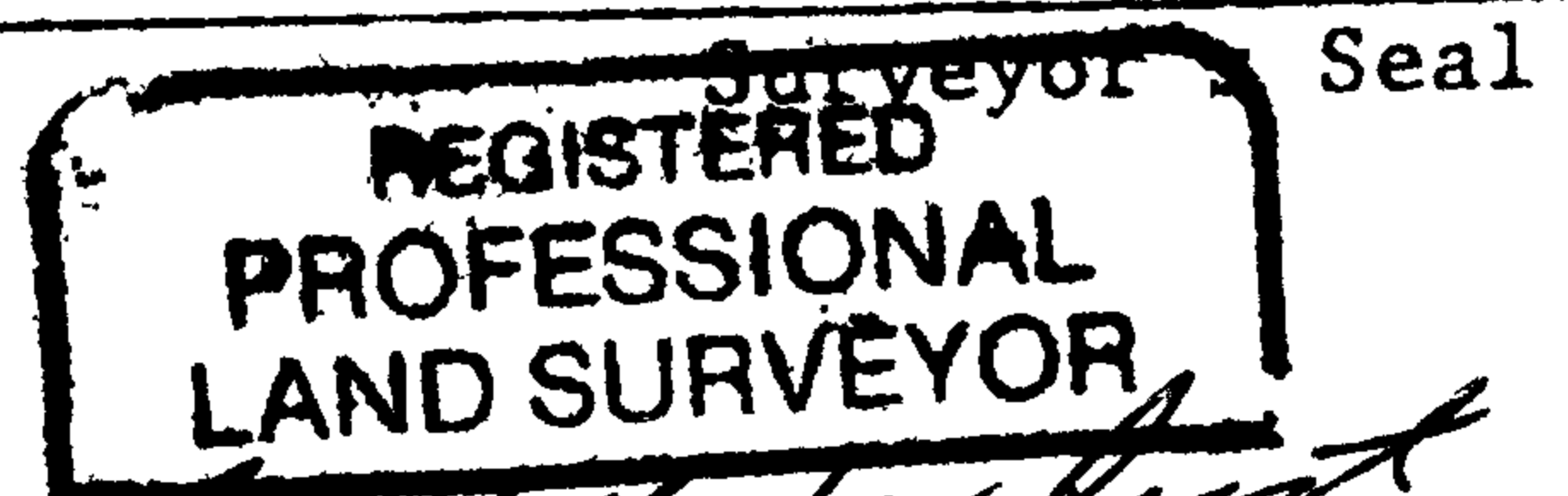

Randall W. Smith
 EXPIRES 6-30-2008

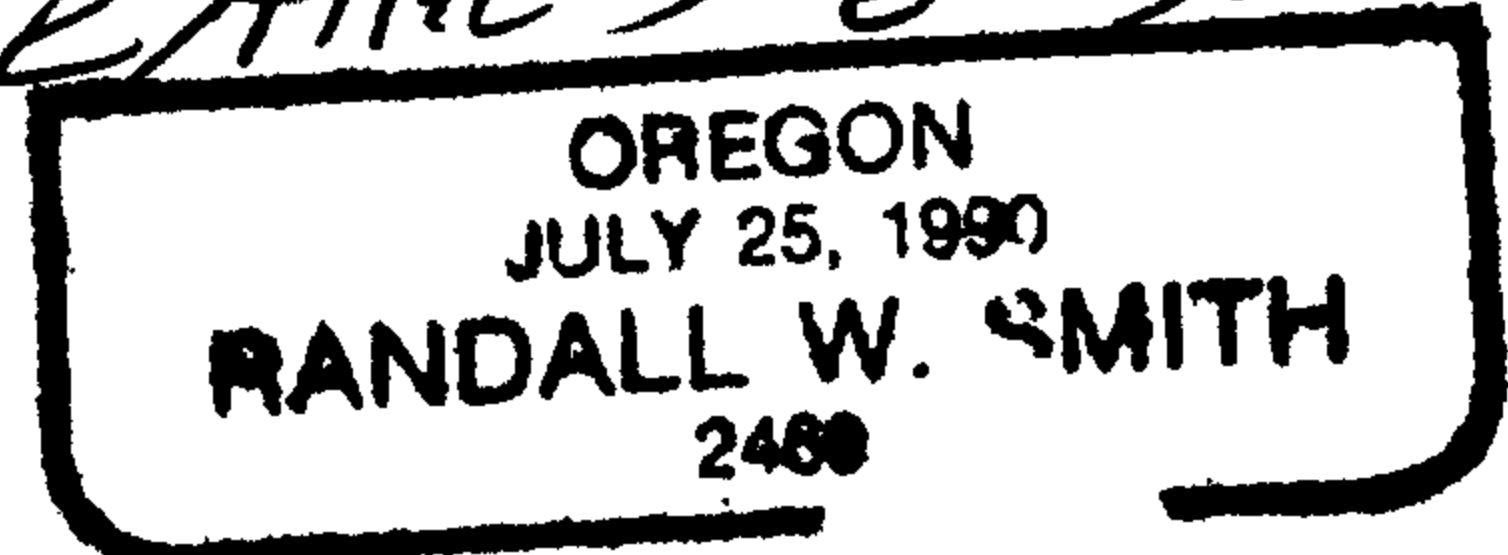

67/21-29