

GOVERNMENT CORNER RESTORATION FORM

FILED

Township 30S Range 8W Sec. 7

County DOUGLAS

Date: 5/1/2007 Pys: SR  
This survey consists of:

State OR Date 4-16-07

No. 140500

Map: \_\_\_\_\_

Corner Designation

Narrative: \_\_\_\_\_

Corner Exp: 67/21-26

S 1/4 SEC. 7

County DOUGLAS COUNTY

Not Found SURVEYOR

- Renewed
- Unrecorded
- Surveyed In
- Referenced Out

Previous Renewals D.C.S.O. 1965

MONUMENT DETAIL

Monument(s) Found: (Condition and Source)

2 1/2" DIA BRASS CAP, PROPERLY  
MARKEED ON 1 1/2" O.D. IRON PIPE  
PROJECTS 14" ABOVE GROUND,  
FIRMLY SET.

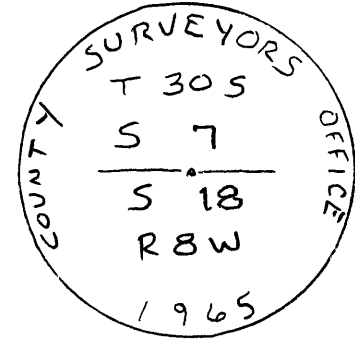

Accessories Found:

13" Now 18" DIA. D. FIR, FULLY HEALED SINGLE BLAZE VISIBLE  
BEARS S 15 1/2° W, 32.9 FT. (REC. S 24° W, 32.9 FT.) 1965 BT.  
APPEARS 1965 CREW READ WRONG SIDE COMPASS NEEDLE?

36" Now 42" DIA D. FIR SNAG, FULLY HEALED SINGLE BLAZE VISIBLE  
BEARS N 61° E, 13.1 FT. (REC. N 61° E, 13.9 FT.) 1965 BT

BOTH ORIGINAL TREES HAVE BLOWN DOWN YEARS AGO.  
ROOT HOLES CHECK WELL FOR RECORD BEARING & DISTANCE.

