

GOVERNMENT CORNER RESTORATION FORM

Date: 3/12/2007 By: JC

Township 22 S Range 8 W Sec. 28

County DOUGLAS

This survey consists of:

State OR

Date 3-7-2007

No. 044120

Map: Narrative:

Corner Rpt: 67/12-19

Corner Designation

INT. "L" CORNER SOUTH LINE
D.L.C. No 44

DOUGLAS COUNTY

Condition: Only

Not Found

Renewed

Unrecorded

Surveyed In

Referenced Out

MONUMENT DETAIL

Previous Renewals 1955, 1964

Monument(s) Found: (Condition and Source)

2 1/2" DIA. D.C.S.O. BRASS CAP
(MARKED AS SHOWN) ATTACHED TO
A 1/4" O.D. IRON PIPE IN SLOUGH OF
CUT BANK ON OLD LOGGING RD. BC/IP
WAS LEANING INTO RD. WITH MOST OF
IRON PIPE EXPOSED. BASE OF BC/IP
APPEARED TO BE UNMOVED. WE REFERENCED
POSITION & REMOVED, DUG DOWN DEEPER
IN A NORTHERLY DIRECTION (MAGNETIC
SOUNDING) & FOUND TOP OF 1955 BC/IP
LAYING ON SIDE. BASE OF 1955 BC/IP APPROX.
40" AWAY IN A NORTHERLY DIRECTION FROM
1964 POSITION.

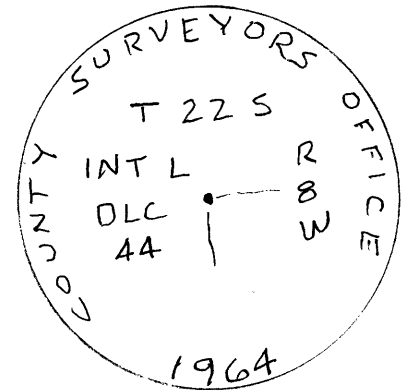

Accessories Found:

- 16" Now 18" DIA. D. FIR, FULLY HEALED DOUBLE BLAZE VISIBLE. BEARS N45°E, 12.7 FT. TREE APPEARS TO HAVE SLID DOWNHILL IN A SOUTHWESTERLY DIRECTION AND LEANS SEVERELY TO THE EAST. (REC. N38°E, 13.0 FT.) 1955 BT
- 15" Now 24" DIA. x 2 FT TALL ROTTEN D. FIR STUMP, FAINT HEALED BLAZE VISIBLE. OPENED & FOUND PARTIAL SCRIBING & AXE MARKS. BEARS N45°W, 16.5 FT. (REC. N45°W, 17.3 FT.) 1964 BT
- TO VERIFY POSITION OF CORNER, DUE TO SLIDING, WE MEASURED THE DISTANCE TO THE EXT'L CORNER DLC 44 AND FOUND THE DISTANCE TO BE 317.2 FT. RECORD DIST. IS 329.25 FT. PER MAP M 8-18

RENEWAL

Monument Detail

Monument Set (Procedure and Description)

AT THE 1964 POSITION A 5/8" X 60" IRON ROD WITH A 1 1/2" DIA ALUM. CAP STAMPED "DOUGLAS CO. SURVEYOR" IS DRIVEN 48" INTO SLOUGH ON NORTHEASTERLY EDGE OF OVERGROWN LOGGING RD.

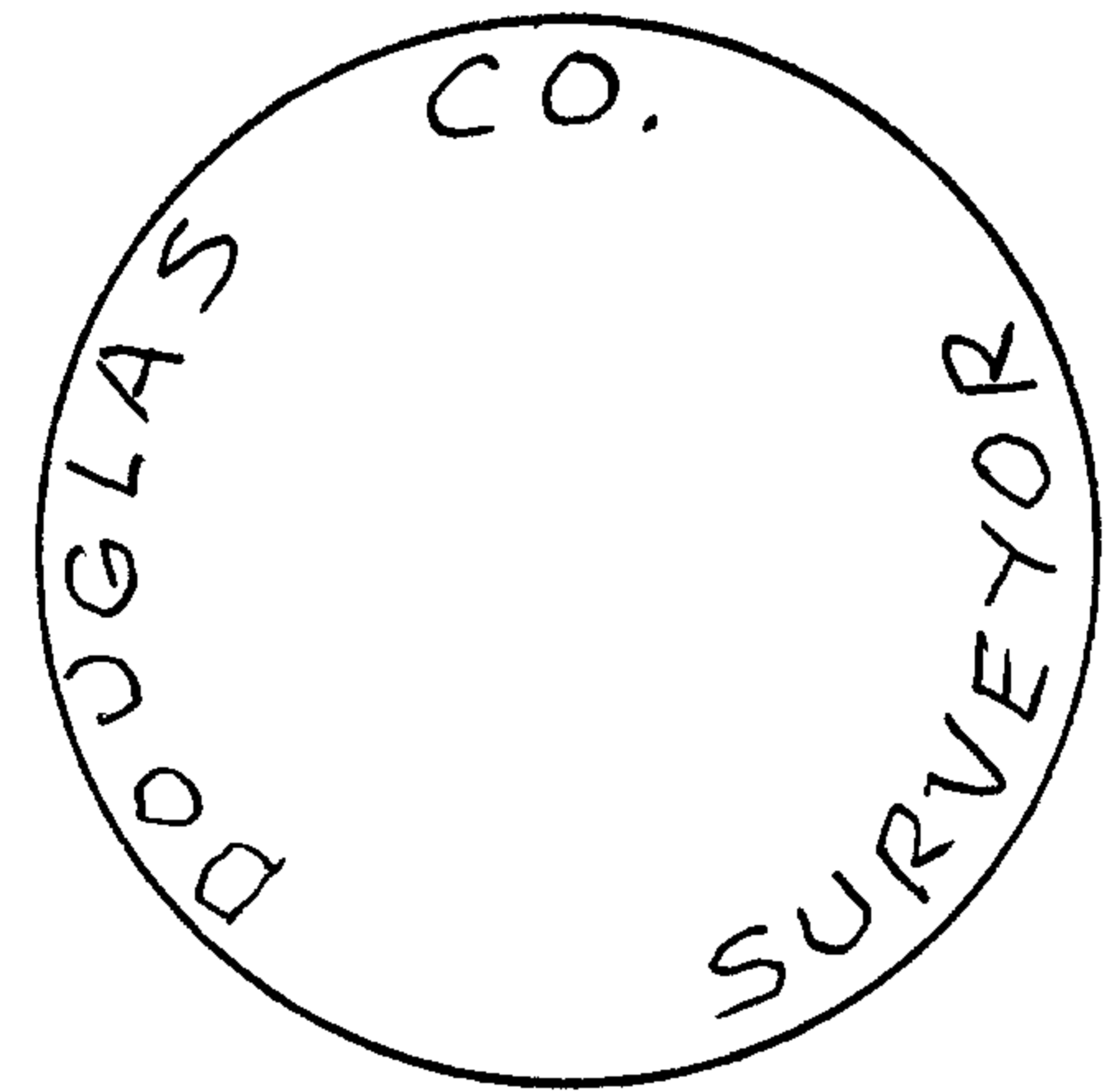

New Accessories

4" DIA. PISTOL BUTT D. FIR, DOUBLE BLAZED & SCRIBED "X" ON HIGH BLAZE AND "CS BT" ON LOW BLAZE, BEARS N 85° W, 36.1 FT.

Sketch of Monument, Accessories, and General Area

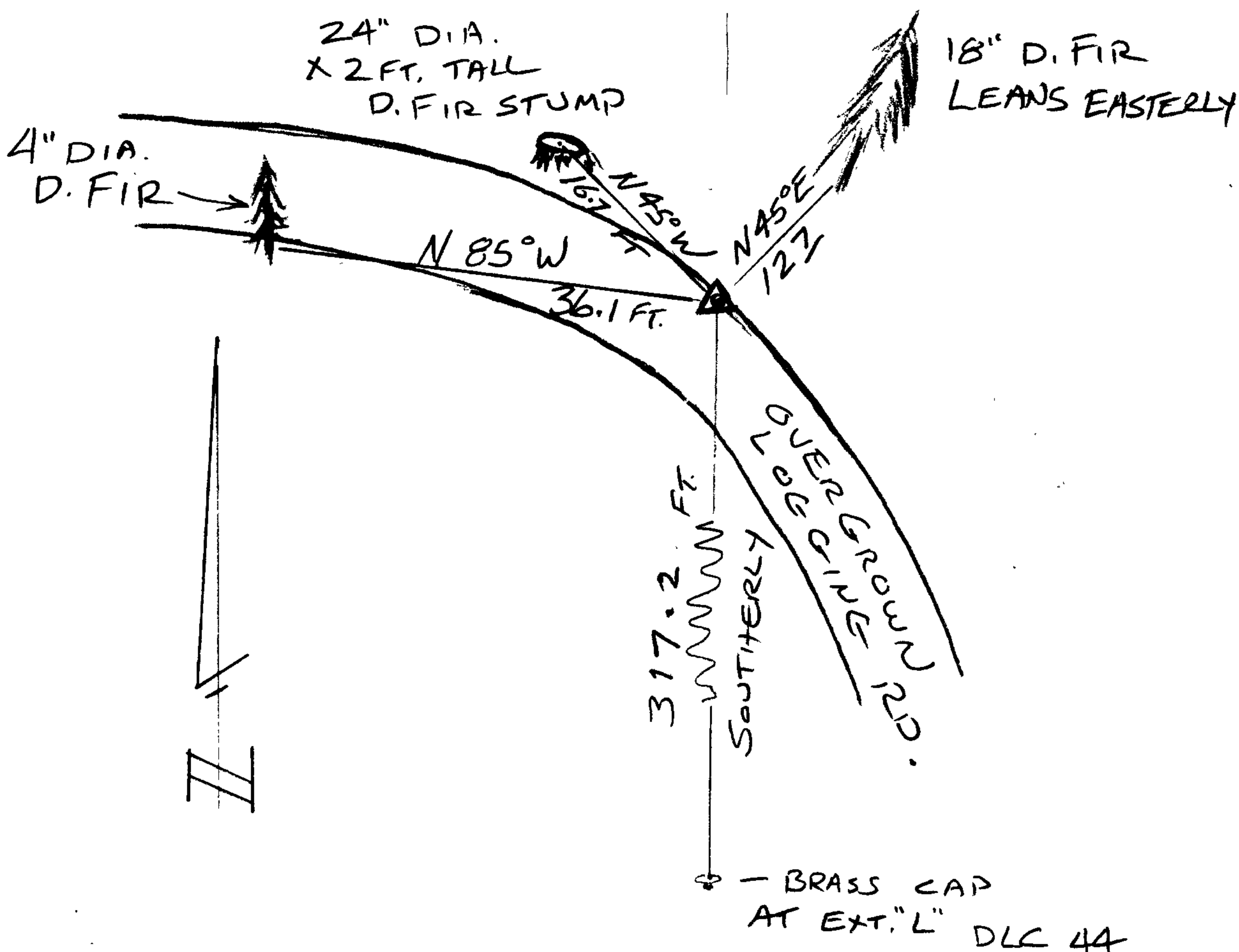

Location & Comments

THE VICINITY AROUND IRON ROD IS BELIEVED TO BE IN PART OF AN ACTIVE SLIDE AREA. 5/8" IRON ROD WAS SET TO PRESERVE APPROX. 1964 LOCATION.

Comp. Declin. 16 1/4° E
 Agency D.C.S.O.
 Party Chief S. FLAUSE
 Notekeeper J. PIKE
 Witnesses

Address

Surveyor's Seal

REGISTERED PROFESSIONAL LAND SURVEYOR

Randall W. Smith
 6-30-08

OREGON
 JULY 25, 1990
 RANDALL W. SMITH
 2400

67/21-19