

GOVERNMENT CORNER RESTORATION FORM

FILED

Date: 3/7/2007 By: JC

Township 30S Range 2W Sec. 32

County DOUGLAS

This survey consists of:

State OREGON

Date MAR. 5

No. 2401

Map: _____
Narrative: _____
Corner Rpt: 67/21-18

Corner Designation

SOUTH 1/4 COR SEC. 32 ONLY

DOUGLAS COUNTY
SURVEYOR

- Condition Report Only
- Not Found
- Renewed
- Unrecorded
- Surveyed In
- Referenced Out

MONUMENT DETAIL

Previous Renewals 1954, 1959, 1979

Monument(s) Found: (Condition and Source)

BYRON'S POSITION

- 2 1/2" DIA. BRASS CAP WITH ALL MARKINGS OBLITERATED, ON 1/4" O.D. IRON PIPE, PROJECTS 11" ABOVE GROUND. SET BY JAMES BYRON IN 1954. (M1-9)

INGRAM'S POSITION

- 2 1/2" DIA BRASS CAP MARKED AS PER RECORD SET BY D.C.S.O. ON 6/19/79 (RM3-26) IT WAS DETERMINED BY THIS OFFICE TO OBLITERATE THIS POSITION. SEE MAP M146-53

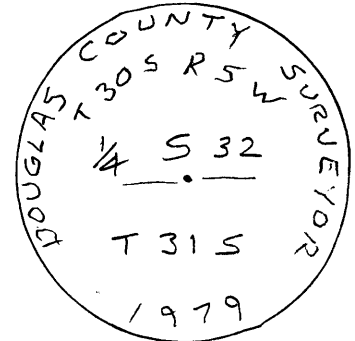

Accessories Found:

INGRAM'S POSITION

1979 ACCESSORIES

- 16" NOW 29" DIA. D. FIR, FULLY HEALED DOUBLE BLAZE, FOUND AS PER 1979 REC.
- 9" NOW 15" DIA. MADRONE, MOSTLY HEALED DOUBLE BLAZE, FOUND AS PER 1979 REC.
- 20" NOW 25" DIA. D. FIR, FULLY HEALED DOUBLE BLAZE, FOUND AS PER 1979 REC.

BYRON'S POSITION

1954 ACCESSORIES

- 10" R. FIR NOW FALLEN & OUT OF POSITION
- 5' R. FIR NOT FOUND

1959 ACCESSORIES

- 2" CHISELED "+" AND LETTERS "B.D." VISIBLE IN ROCK OUTCROP. "+" BEARS N 44° E, 6.7 FT. (REC N 48° E, 6.7 FT.)
- 40" NOW 40" DIA. X 12 FT. TALL D. FIR SNAG, EVIDENCE OF HEALED CHOPPED OUT BLAZE, BEARS NORTH, 91.6 FT. (AGREES W/REC.)

C.S. File No 67/21-18

RENEWAL

Monument Set (Procedure and Description)

Monument Detail

- BRASS CAP AT BYRON'S POSITION WAS FILED SMOOTH AND RESTAMPED. (AS SHOWN)
- ALL MARKINGS ON 1979 BRASS CAP (INGRAM'S POSITION) WERE OBLITERATED AND BLANK BRASS CAP NOW BECOMES AN ACCESSORY TO NEWLY ACCEPTED POSITION.
- BEARING TREE TAGS REMOVED FROM TREES WITNESSING THE 1979 POSITION.



New Accessories

- 10" DIA. D. FIR, DOUBLE BLAZED & SCRIBED "1/4 S 32 CS BT" BEARS N 29 1/2° W, 32.9 FT.
- 11" DIA. MADRONE, DOUBLE BLAZED & SCRIBED "5 S CS BT" BEARS S 46 1/2° W 19.3 FT.
- 6" DIA. LIVE OAK, DOUBLE BLAZED & SCRIBED "5 S CS BT" BEARS S 32° E 28.3 FT.
- 2 1/2" DIA. BRASS CAP ALL MARKS OBLITERATED, FLUSH WITH GROUND BEARS N 75° 22' 45" W, 190.22 FT.

Sketch of Monument, Accessories, and General Area

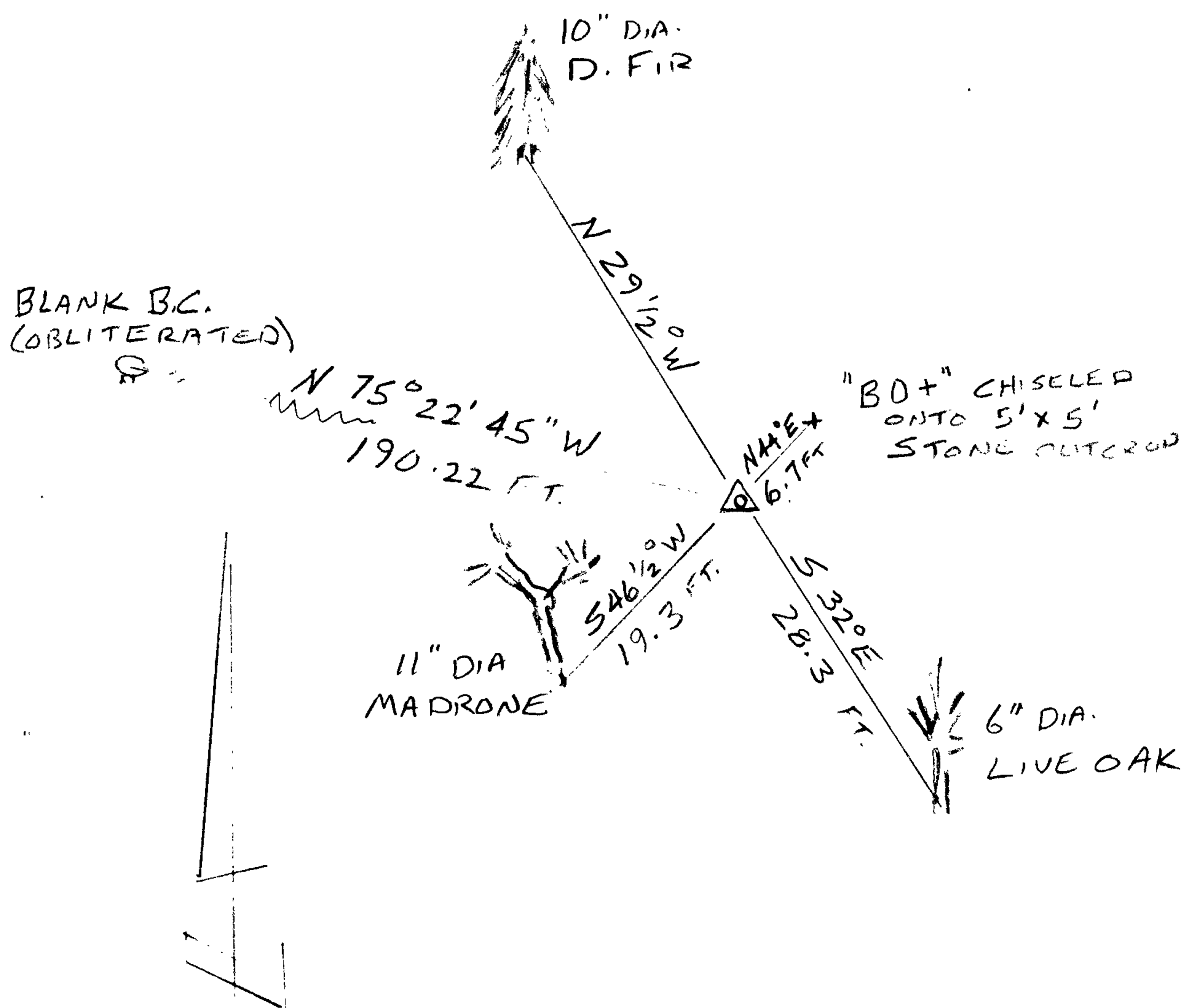

Location & Comments

LIES ON STEEP ROCKY SLOPE

GIS C030514A

Comp. Declin. 16 1/4° E

Agency D.C.S.O.

Party Chief S. FLAUSE

Notekeeper J. PIKE

Witnesses

Address

Surveyor's Seal

REGISTERED PROFESSIONAL LAND SURVEYOR

Randall W. Smith
EXPIRES 6-30-08

OREGON
JULY 25, 1990
RANDALL W. SMITH
2408