

GOVERNMENT CORNER RESTORATION FORM

FILED

Township 23S Range 5W Sec. 10 County DOUG Date: 3/7/2007 By: JC
State OR Date 2/28/2007 No. 50054 Map: _____
This survey consists of:

Corner Designation

EAST 1/4 COR SEC. 10

Narrative: _____
Corner Rpt: 67/21-17
 Douglas Report Only
 Not Surveyed
 Renewed
 Unrecorded
 Surveyed In
 Referred Out

Previous Renewals 1960, 1993

Monument(s) Found: (Condition and Source)

2 1/2" DIA BRASS CAP PROPERLY
MARKED ON 1/4" OD IRON PIPE
PROJECTS 4" ABOVE GROUND.
FIRMLY SET.

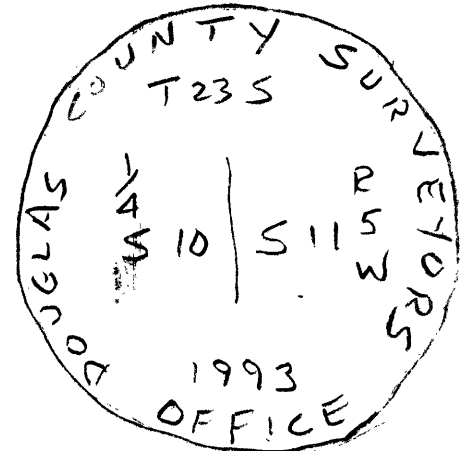

Accessories Found:

26" NOW 30" DIA D. FIR, FULLY HEALED DOUBLE BLAZE, TOP NOW DEAD,
BEARS N1 1/2° E, 264.1 FT. (AGREES W/REC) 1993 B.T.

11" NOW 15" DIA. W. OAK, FULLY HEALED DOUBLE BLAZE,
BEARS N34° W, 311.4 FT (AGREES W/REC) 1993 B.T.

5/8" IRON ROD W/ALUM CAP STAMPED "B.O.1" IN ROTTEN STUMP
BEARS S 26 3/4° E, 110.6 FT. (AGREES W/REC) 1993 ACCESSORY

5/8" IRON ROD "B.O.2" IS FOUND ON TOP OF GROUND LOOSE
(REC. S10 3/4° W, 198.4 FT.)

- NO ROTTEN STUMPS FROM PREVIOUS RENEWALS LOOKED FOR -

C.S. File No 67/21-17

