

GOVERNMENT CORNER RESTORATION FORM

FILED

Township 30S Range 5W Sec. 31

County DOUGLAS

Date: 3/7/07 Py: X

This survey consists of:

State OR

Date JAN. 10, 2007

No. 160140

Map: _____

Corner Designation

Narrative: _____

Corner Rpt: 67/21-14

CENTER EAST $\frac{1}{16}$ COR
SEC. 31

- Condition Report
- Not Found
- Renewed
- Unrecorded
- Surveyed In
- Referenced Out

MONUMENT DETAIL

Previous Renewals 1979

Monument(s) Found: (Condition and Source)

2 1/2" D.A. D.C.S.O. BRASS CAP
FLUSH W/GROUND (1979)

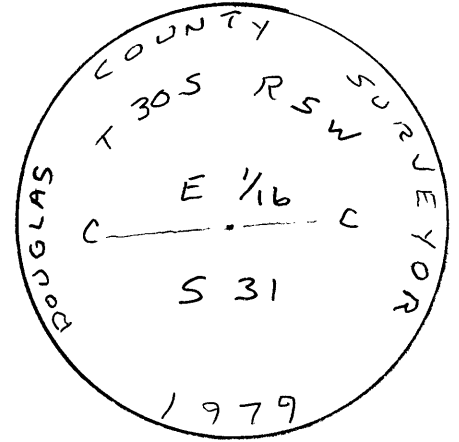

Accessories Found:

11" Now 20" DIA PISTOL BUTT D. FIR, FULLY HEALED
DOUBLE BLAZE, FOUND AS PER 1979 RECORD.

20" Now 27" DIA W. OAK, FULLY HEALED DOUBLE BLAZE,
FOUND AS PER 1979 RECORD.

RENEWAL

Monument Set (Procedure and Description)

Monument Detail

- 2 1/2" DIA. BRASS CAP (MARKED AS SHOWN) ON 1/4" O.D X 30" LONG IRON PIPE PROJECTS 7" ABOVE GROUND.
- MARKINGS ON 1979 BRASS CAP ARE GROUND OFF AND BLANK BRASS CAP NOW BECOMES AN ACCESSORY FOR NEW POSITION.
- 1979 B.T.'S NOW BECOME ACCESSORIES FOR NEW POSITION. W. OAK IS RE-SCRIBED/RETAGGED, PISTOL BUTT D. FIR IS JUST RETAGGED, AS HEALED BLAZES GENERALLY POINT IN CORRECT DIRECTION.

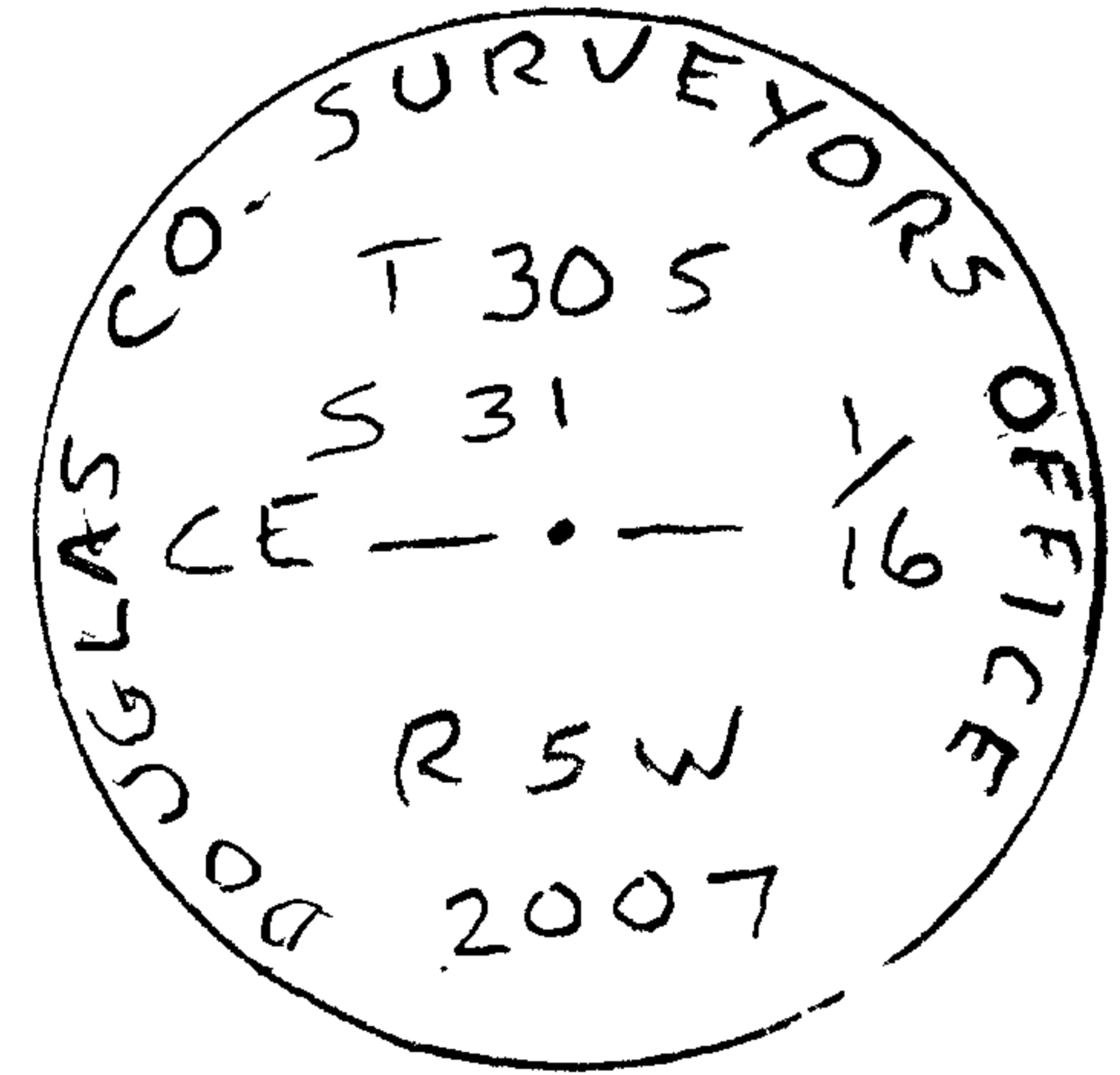

New Accessories

- 27" DIA. W. OAK, DOUBLE BLAZED & SCRIBED "CE 16 S 31 CSBT" BEARS S 83° W, 105.8 FT. 1979 BT IS RE-SCRIBED WITH BLAZES POINTING TO NEW CORNER.
- 20" DIA. PISTOL BUTT D. FIR, (1979 BT) SHOWS GOOD HEALED BLAZE THAT POINTS GENERALLY TOWARD NEW CORNER POSITION, BEARS S 85° E, 61.4 FT.
- 2 1/2" DIA. BLANK BRASS CAP, FLUSH WITH GROUND, BEARS N 70° 30' 57" W, 149.22 FT.

Sketch of Monument, Accessories, and General Area

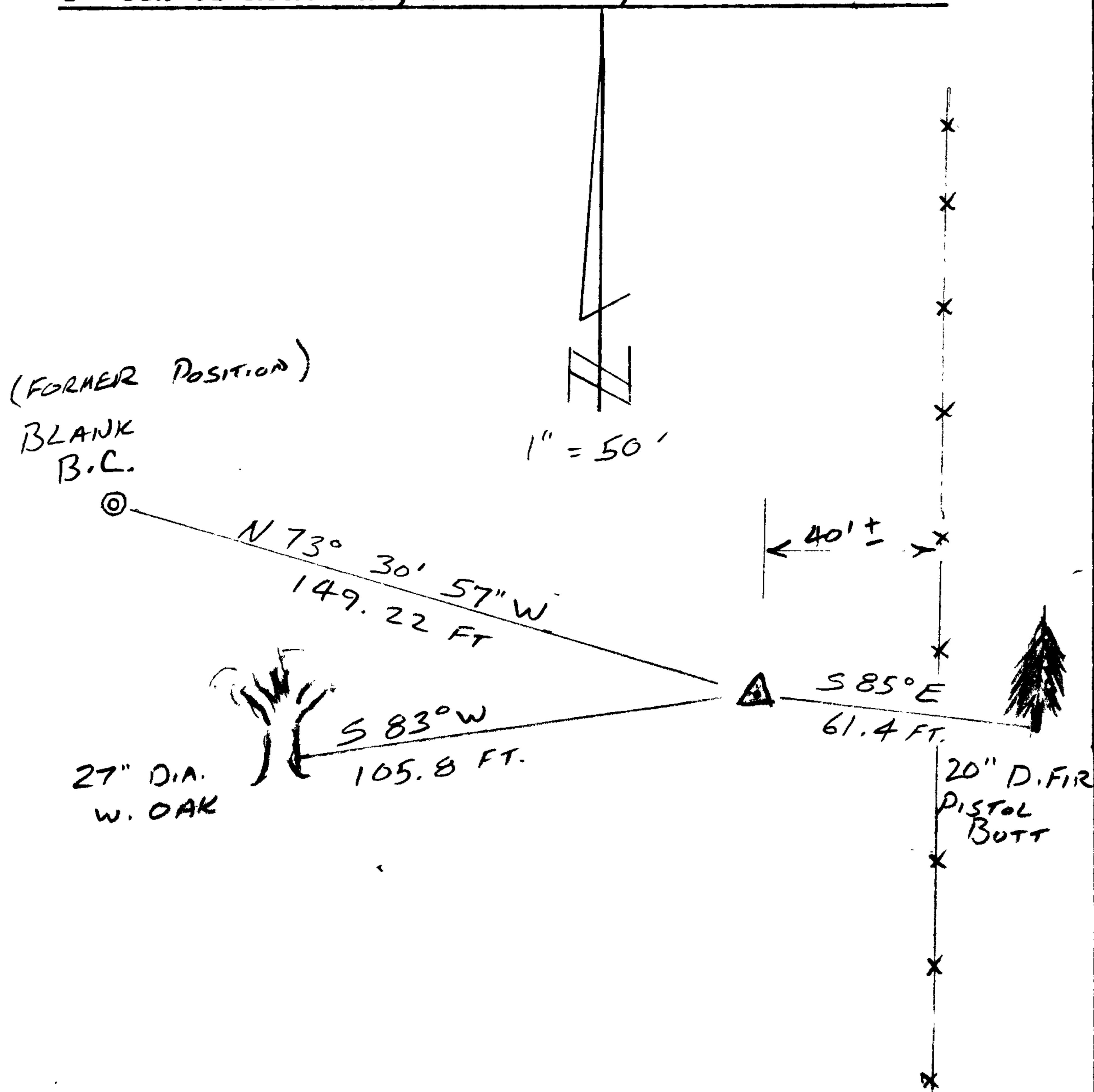

Location & Comments

LIES APPROX. 40 FT WEST OF N-S FENCE ON NEARLY LEVEL GROUND.

Comp. Declin. 16 1/4° E
 Agency D.C.S.O.
 Party Chief S. FLAUSE
 Notekeeper J. PIKE
 Witnesses

Address

Surveyor's Seal

