

RENEWAL

Monument Set (Procedure and Description)

Monument Detail

- 2 1/2" DIA. BRASS CAP (MARKED AS SHOWN) ON 1 1/4" O.D. X 30" LONG IRON PIPE. PROJECTS 7" ABOVE GROUND.
- MARKINGS ON 1979 BRASS CAP ARE GROUND OFF AND BLANK BRASS CAP NOW BECOMES AN ACCESSORY FOR NEW POSITION.
- BEARING TREE TAGS ARE REMOVED FROM TREES WITNESSING THE FORMER POSITION.

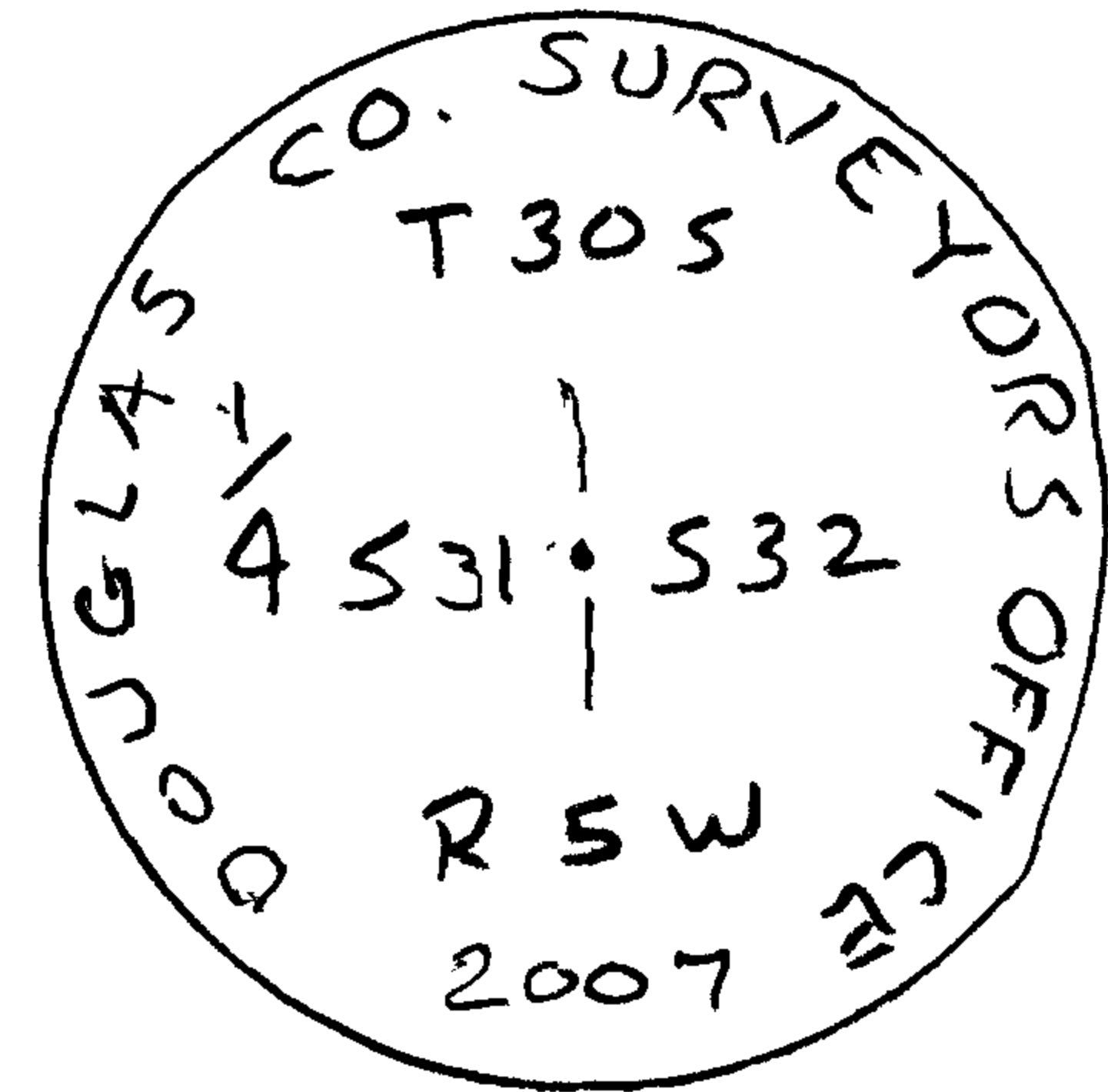

New Accessories

- 10" DIA. KMX PINE, DOUBLE BLAZED & SCRIBED "1/4 S32 CS BT" BEARS N 32° E, 6.7 FT.
- 10" DIA. D. FIR, DOUBLE BLAZED & SCRIBED "1/4 S32 CS BT" BEARS S 41° E, 35.4 FT.
- 10" DIA. MAPLE, DOUBLE BLAZED & SCRIBED "1/4 S31 CS BT" BEARS S 31° W, 2.0 FT.
- 7" DIA. B. OAK, DOUBLE BLAZED & SCRIBED "1/4 S31 CS BT" BEARS N 38 1/2° W, 32.7 FT.
- 2 1/2" DIA. BLANK BRASS CAP, PROJECTS 2" ABOVE GRND., BEARS N 75° 30' 28" W, 195.28 FT. (1979 POSITION)

Sketch of Monument, Accessories, and General Area

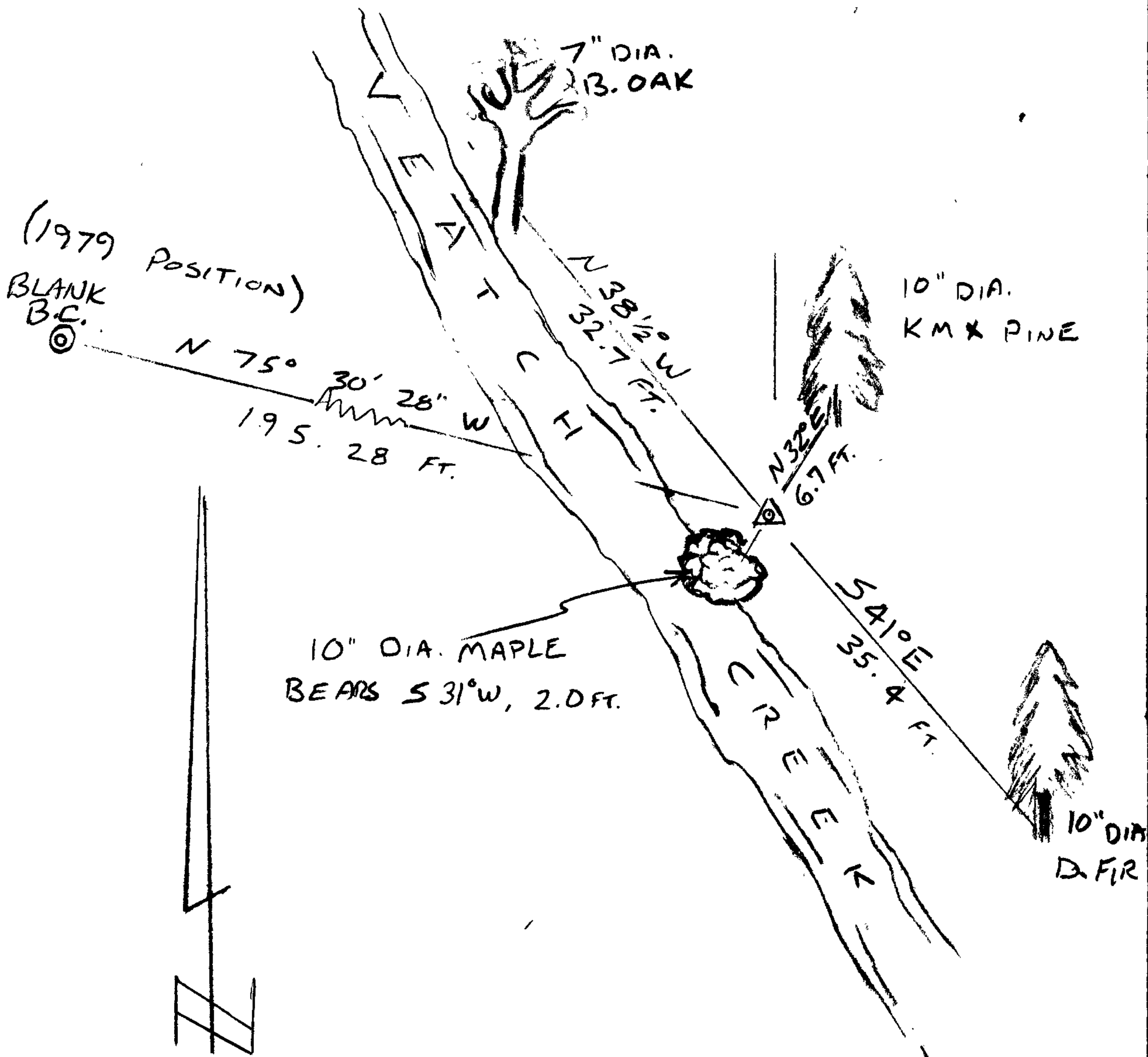

Location & Comments

CORNER LIES ON TOP OF EAST HIGH BANK OF VEATCH CREEK ON NEARLY LEVEL TERRAIN.

Comp. Declin. 16 1/4° E
 Agency D.C.S.O.
 Party Chief S. FLAUSE
 Notekeeper J. PIKE
 Witnesses _____

Address

Surveyor's Seal

REGISTERED
 PROFESSIONAL
 LAND SURVEYOR

James W. Smith
 EXPIRES 6-30-08

OREGON
 JULY 25, 1990
 RANDALL W. SMITH
 2498