

FILED

GOVERNMENT CORNER RESTORATION FORM

Date: 2/27/2007 By: JC

This survey consists of:

Township 30S Range 5W Sec. 31 County DOUGLAS Map: _____

State OR Date 2/22/2007 No. 140100 Narrative: _____
Corner Rpt: 67/21-11

Corner Designation

DOUGLAS COUNTY
SURVEYOR

SOUTH 1/4 COR. SEC. 31 ONLY

- Condition Report Only
- Not Found
- Renewed
- Unrecorded
- Surveyed In
- Referenced Out

Previous Renewals 1946, 1963, 1979

MONUMENT DETAIL

Monument(s) Found: (Condition and Source)

2 1/2" DIA. BRASS CAP, PROPERLY MARKED, FLUSH W/SURFACE OF GROUND.

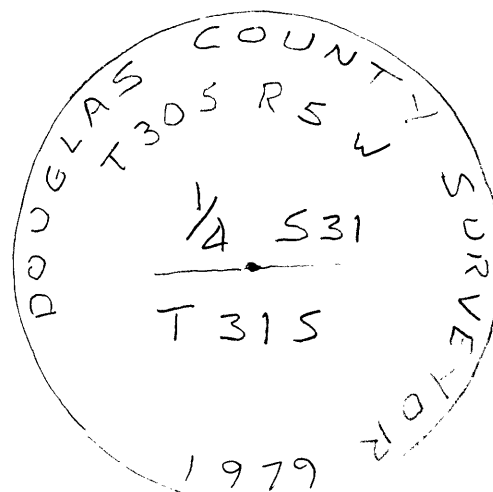

Accessories Found:

6" NOW 6" DIA. LIVE OAK, PARTLY HEALED DOUBLE BLAZE VIS. FOUND AS PER 1979 RECORD.

8" NOW 15" DIA. D. FIR, FULLY HEALED DOUBLE BLAZE FOUND AS PER 1979 RECORD.

18" NOW 23" DIA. D. FIR, FULLY HEALED DOUBLE BLAZE FOUND AS PER 1979 RECORD.

C.S. File No 67/21-11

RENEWAL

Monument Set (Procedure and Description)

Monument Detail

- SET 2 1/2" DIA. BRASS CAP (MARKED AS SHOWN) ON 1/4" O.D. X 30" LONG IRON PIPE. BRASS CAP PROJECTS 3" ABOVE GROUND.
- 1979 BRASS CAP IS CUT OFF AND 1/4" IRON PIPE NOW BECOMES ACCESSORY FOR NEW POSITION
- BEARING TREE TAGS ARE REMOVED FROM 1979 B.T.'S.

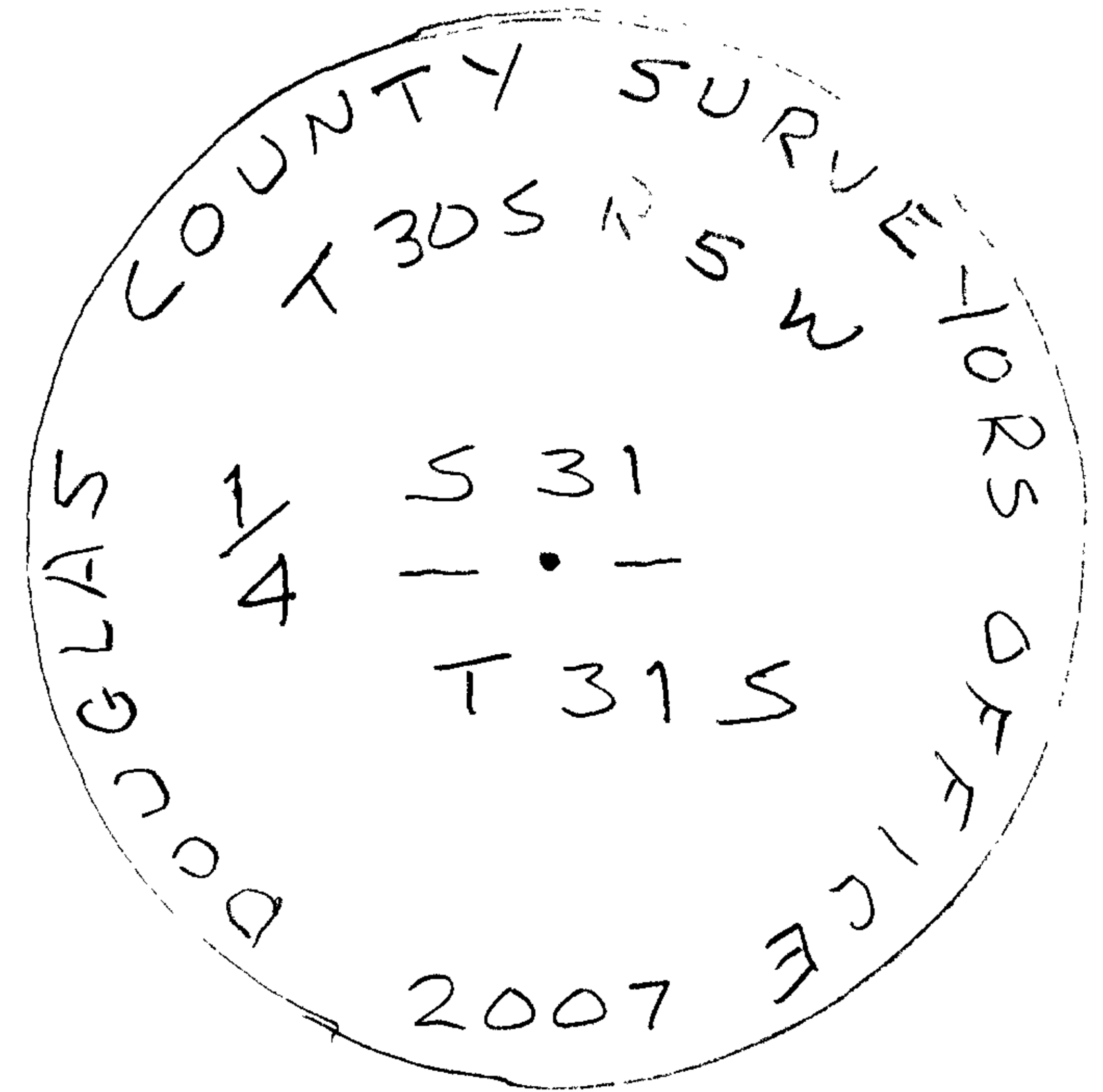

New Accessories

- 18" DIA. D. FIR, DOUBLE BLAZED & SCRIBED "1/4 S31 CS BT" BEARS N 31 1/2° E, 35.2 FT.
- 8" DIA. LIVE OAK, DOUBLE BLAZED & SCRIBED "1/4 S6 CS BT" BEARS S 55 1/2° E, 13.1 FT.
- 8" DIA. MADRONE, DOUBLE BLAZED & SCRIBED "1/4 S6 CS BT" BEARS S 49° W, 23.5 FT.
- 2 1/2" DIA. D. FIR, DOUBLE BLAZED & SCRIBED "1/4 S31 CS BT" BEARS N 30° W, 7.5 FT.
- 1/4" O.D. IRON PIPE, LIES 1" BELOW GROUND, BEARS N 75° 28' 29" W, 198.64 FT. (1979 Pos.)
- 1" IRON PIPE, PROJECTS 18" ABOVE GROUND, BEARS N 81° 54' 45" E, 199.72 FT. (1946 Pos.)

Sketch of Monument, Accessories, and General Area

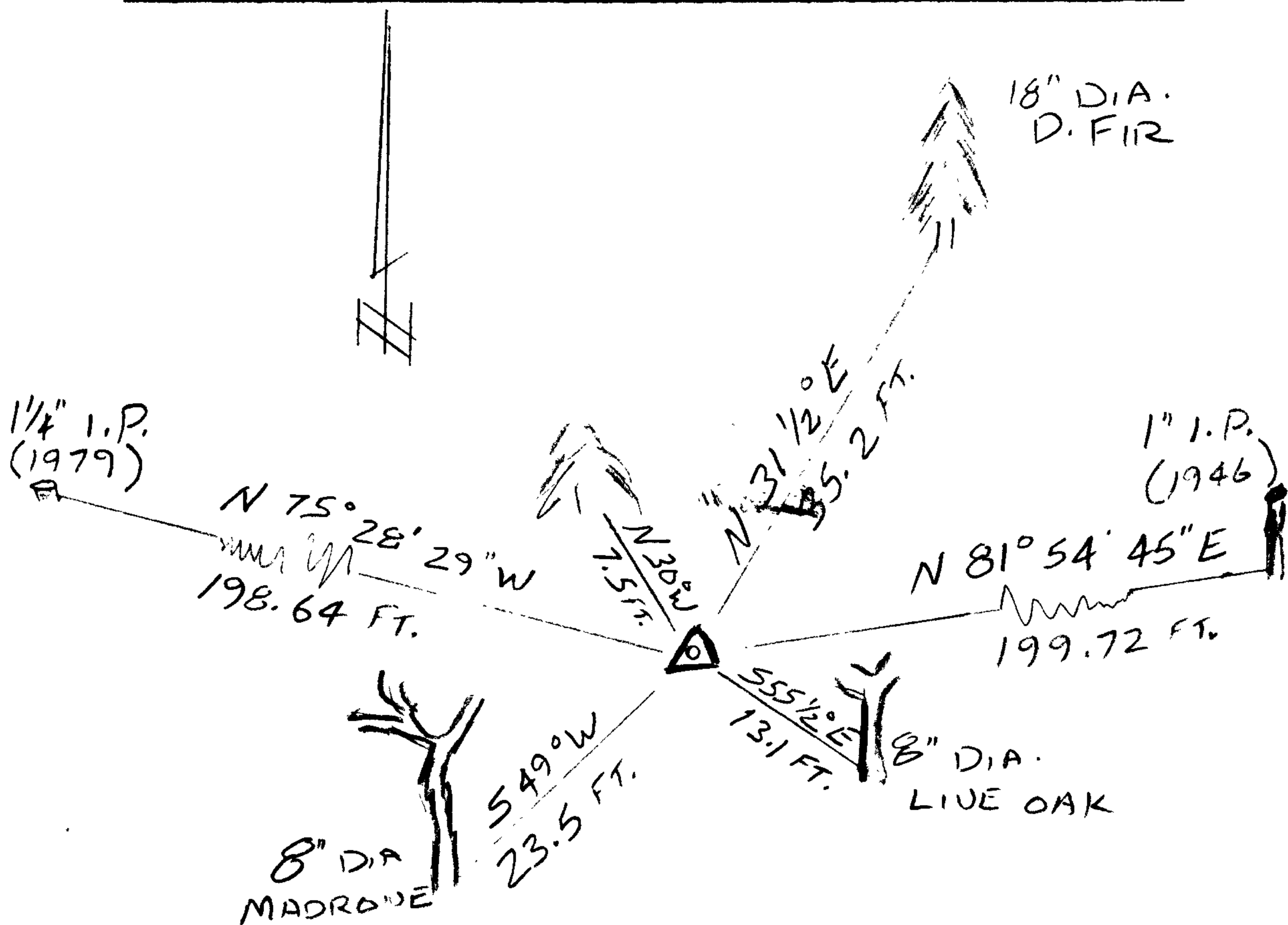

Location & Comments

CORNER LIES ON STEEP WEST FACING SLOPE. BRASS CAP FILLS IN EDGE OF OLD UPTURNED ROOT WAD

Comp. Declin. 16 1/4° E
 Agency D.C.S.O.
 Party Chief S. FLAUSE
 Notekeeper J. PIKE
 Witnesses

Address

Surveyor's Seal

REGISTERED PROFESSIONAL LAND SURVEYOR

Randall W. Smith
ETPLS 6-30-08

OREGON
 JULY 25, 1997
 RANDALL W. SMITH
 2469