

FILED

GOVERNMENT CORNER RESTORATION FORM

Date: 12/28/06 By: JC

This survey consists of:

Township 22S Range 12W Sec. 19

County DOUGLAS Map: _____

State OR

Date 9-19-05

No. 200340

Narrative: _____

Corner Rpt: 67/14-52

Corner Designation

EAST 1/4 COR. SECTION 19

DOUGLAS COUNTY SURVEYOR

Condition Report Only

Not Found

Renewed

Unrecorded

Surveyed In

Referenced Out

MONUMENT DETAIL

Previous Renewals D.C.S.O. AUG. 1973

Monument(s) Found: (Condition and Source)

2 1/2" B.C. ON 1 1/4" O.D. IRON PIPE
PROJECTS 6" ABOVE GROUND.
MARKED AS SHOWN

NOTE: BC IS DATED 1972, RENEWAL
IS DATED 1973.

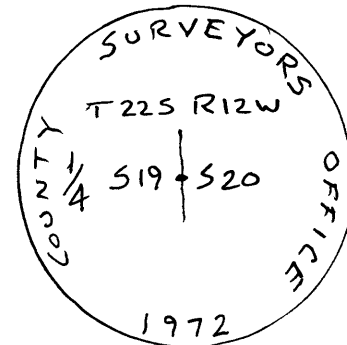

Accessories Found:

18" HEMLOCK NOW 24" DIA. X 4 FT. TALL STUMP. FULLY HEALED
SINGLE BLAZE VISIBLE, BEARS N 87° E, 32 FT.
(REC. N 87° W, 32 FT.) 1973 BT
SPRUCE

12" NOW 24" DIA. X 5 FT TALL STUMP. FULLY HEALED SINGLE BLAZE
VISIBLE, BEARS N 84° W, 15 3/4 FT. (AGREES W/REC.) 1973 BT

ORIG. 15" NOW 54" DIA. HEMLOCK STUMP 4 FT. TALL. NO MARKS VISIBLE
STUMP WAS CUT LOW ON UPHILL (FACE) SIDE
BEARS N 58 1/2° W, 26 1/4 FT. (REC. N 62° W, 22 1/4 FT.) O.B.T.

ORIG 15" NOW 40" DIA. DECAYING HEMLOCK STUMP 3 FT. TALL
NO MARKS VISIBLE. BEARS N 34° E, 14 3/4 FT. (AGREES W/REC.)
O.B.T.

C.S. File No 67/14-52

