

GOVERNMENT CORNER RESTORATION FORM

FILED

Date: 12/19/06 By: JC

Township 27S Range 3W Sec. 7

County DOUGLAS

This survey consists of:

State OR Date 12/13/2006

No. 260540

Map: _____

Narrative: _____

Corner Rpt: 67/14-50

Corner Designation

$\frac{1}{4}$

SEC. 7 * SEC. 8

DOUGLAS COUNTY SURVEYOR

- Condition Report Only
- Not Found
- Renewed
- Unrecorded
- Surveyed In
- Referenced Out

Previous Renewals 1975; BLM

Monument(s) Found: (Condition and Source)

2 1/2" DIA. D.C.S.O. BRASS CAP
(MARKED AS SHOWN) PROJECTS
3" ABOVE GROUND, FIRMLY SET

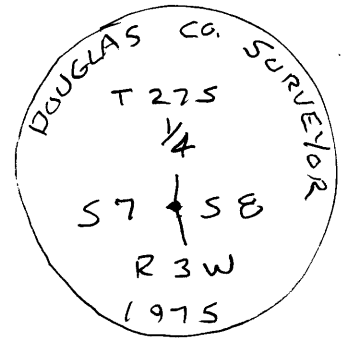

Accessories Found:

ORIG. 24" NOW 26" DIA. X 30 FT. TALL BURNT FIR SNAG
NO MARKS VISIBLE, BEARS S 80° E, 13.9 FT. (AGREES W/REC.) ORIG. S.T.

13" NOW 27" DIA. I. CEDAR, PARTIALLY BURNED ON SOUTH SIDE
- IS ALIVE - FULLY HEALED SINGLE BLAZE VISIBLE,
BEARS N 65° W, 37.6 FT. (AGREES W/REC.) 1958 BT

22" NOW 12" DIA. X 4 FT. TALL MADRONE STUMP EAST PORTION
OF TREE ROTTED AWAY, ILLEGIBLE SCRIBING ON OPENED ROTTED FACE
BEAR S 84 1/2° E, 35.6 FT. (AGREES W/REC.)

13" DIA. D. FIR, FULLY HEALED SINGLE BLAZE W/BT TAG.
THIS TREE NOT OF PREVIOUS RECORD. TAG INDICATES TREE
WAS MARKED 8/1/00 BY DEVORE. BEARS N 23 3/4° E,
37.6 FT. (WE AGREE WITH INFORMATION POSTED ON TAG.)

C.S. File No 67/14-50

