

GOVERNMENT CORNER RESTORATION FORM

FILED

Township 29S Range 8W Sec. 9

County DOUGLAS This survey consists of:

Date: 11/9/06 By: JC

State OR Date OCT. 30, 2006

No. 340508

Corner Designation

$\frac{1}{4}$   $\frac{S\ 9}{S\ 16}$

Map: \_\_\_\_\_

Narrative: \_\_\_\_\_

Corner Bkt: 67/14-36

- DOUGLAS COUNTY  
 Condition/Report Only  
 Not Found  
 Renewed  
 Unrecorded  
 Surveyed In  
 Referenced Out

Previous Renewals 1938, 1958, 1978

Monument(s) Found: (Condition and Source)

2 1/2" B.C. MARKED AS SHOWN  
PROJECTS 12" ABOVE GROUND

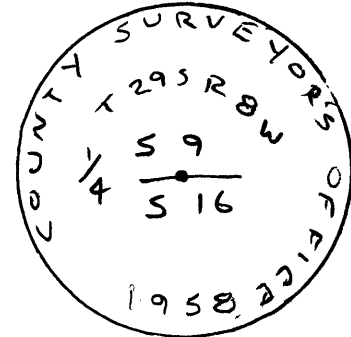

Accessories Found:

28" NOW 30" DIA. X 4 FT. TALL D. FIR STUMP. WITH ANGLE CUT  
TOP, BEARS S 34 1/2° E, 21.6 FT. (AGREES W/REC.) 1958

7 FULLY HEALED DOUBLE BLAZE

30" NOW 28" DIA X 2 1/2 FT. ROTTED D. FIR STUMP FULLY HEALED  
LOWER BLAZE BEARS N 48° E, 23.3 FT. (REC. N 48° E, 22.7 FT)

18" NOW 18" DIA. X 1 1/2 FT TALL VERY ROTTED D. FIR STUMP.  
NO MARKS VISIBLE BEARS S 76 1/4° W, 21.5 FT. (AGREES W/REC.) 1938

10" NOW 26" DIA. X 1 1/2 FT TALL ROTTED STUMP EVID. OF LOW BLAZE  
BEARS N 31° W, 77.4 FT. (AGREES W/REC) 1978

10 FT. X 10 FT X 4 FT TALL STONE WITH CHISELLED " + 30"  
BEARS N 26° E, 13.3 FT TO " + " (REC N 25° E, 13.3 FT.) 1958

C.S. File No 67/1436

