

FILED

GOVERNMENT CORNER RESTORATION FORM

Date: 11/9/06 By: X

Township 30 S Range 5 W Sec. 31 County Douglas

This survey consists of:

State OR Date 10-17-2006 No. 100140

Narrative: _____
Corner Rpt: 67/14-33

Corner Designation

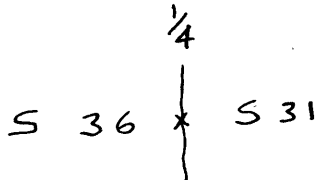

DOUGLAS COUNTY
SURVEYOR

- Condition Report Only
- Not Found
- Renewed
- Unrecorded
- Surveyed In
- Referenced Out

Previous Renewals 1946, 1963, 1979

MONUMENT DETAIL

Monument(s) Found: (Condition and Source)

3/4" I.D. IRON PIPE PROJECTS 28" ABOVE GROUND (WENDEROTH 1946)

2 1/2" DIA. B. CAP ON 1" IRON PIPE PROJECTS 6" ABOVE GROUND. (DCSO 1979)
IT HAS BEEN DETERMINED BY EVIDENCE PREVIOUSLY OMITTED FROM CORNER RENEWAL NOTES THAT WENDEROTH ESTABLISHED HIS POSITION FROM ORIGINAL BEARING TREES. THEREFORE WE ACCEPT THIS POSITION AND CUT OFF THE 1979 BRASS CAP, LEAVING THE 1" I. PIPE PROJECTING 4" ABOVE GROUND.

Accessories Found:

ACCESSORIES FOR 1979 BC/IP:

- 10" Now 16" DIA. D. FIR HEALED DOUBLE BLAZE, BEARS N65°W, 267' (REC. 252')
- 9" Now 15" DIA. D. FIR SNAG, HEALED DOUBLE BLAZE, BEARS S52°W, 64'
- 9" Now 12" DIA. D. FIR STUMP 1 FT TALL, EVID. OF LOW BLAZE, BEARS S84°E, 33'
- 10" Now 15" DIA. D. FIR SNAG HEALED DOUBLE BLAZE, BEARS N52°E, 39'

ACCESSORIES FOR 1946 3/4" I. PIPE:

- 19" DIA. D. FIR SNAG NOW 18" DIA X 15 FT. TALL SNAG. SHOWS CHOPPED OUT BLAZE BEARS S 8°W, 10.4 FT. (AGREES W/REC) 1946 BT
- 18" B. OAK NOW TIPPED OUT & LAYING ON GROUND, ROOT HOLE AGREES WELL WITH REC. (N 53°E, 54.8 FT.) 1946 BT

C.S. File No 67/14-33

RENEWAL

Monument Set (Procedure and Description)

Monument Detail

POSITION OF 3/4" I.P. WAS REFERENCED & REMOVED. SET 2 1/2" DIA. BRASS CAP (MARKED AS SHOWN) ON 1 1/4" O.D. IRON PIPE AT REFERENCED POSITION. RESET 3/4" I.P. AT WEST EDGE OF BC/IP.

BEARING TREE TAGS ARE REMOVED FROM EXISTING SNAGS. NW BT NOW BECOMES REFERENCE FOR NEW POSITION.

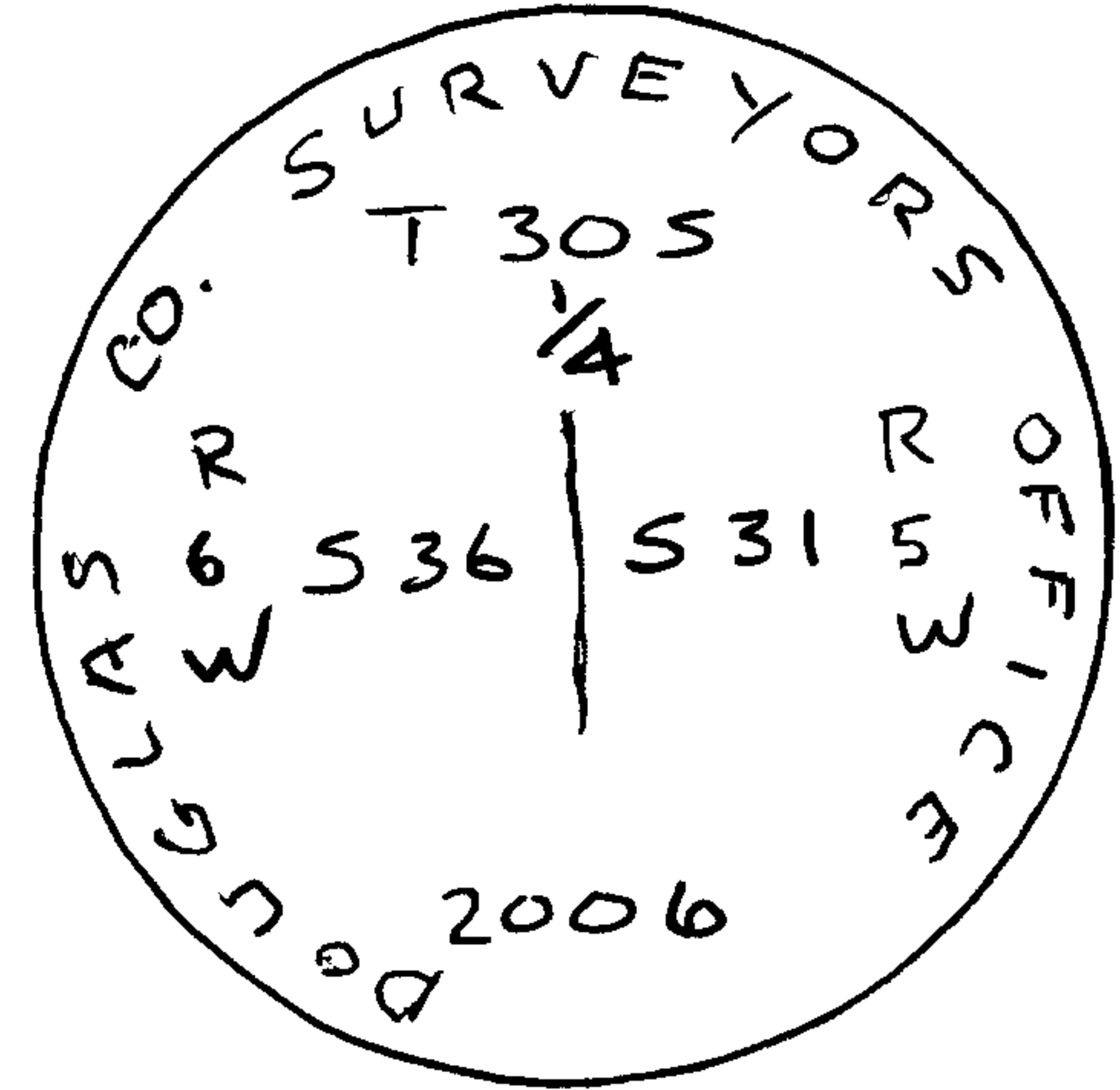

New Accessories

- 1" I.D. IRON PIPE, PROJECTS 4" ABOVE GROUND BEARS N 36 1/2° E, 25.1 FT. -
 ← COMPASS BEARING - (REC. N 38° 31' 27" E, 25.08 FT.) 1979
- 17" DIA. D. FIR, DOUBLE BLAZED & SCRIBED "1/4 S31CS BT" BEARS N 9 1/2° E, 12.3 FT.
- 11" DIA. MADRONE, DOUBLE BLAZED & SCRIBED "1/4 S31CS BT" BEARS S 29° E, 12.7 FT.
- 8" DIA. W. OAK, DOUBLE BLAZED & SCRIBED "1/4 S36CS BT" BEARS S 88° W, 37.2 FT.
- 16" DIA. D. FIR, HEALED DOUBLE BLAZE VISIBLE, BEARS N 16° W, 32.1 FT. - 1979 BT -
 NOW REFERENCES NEW POSITION.

Sketch of Monument, Accessories, and General Area

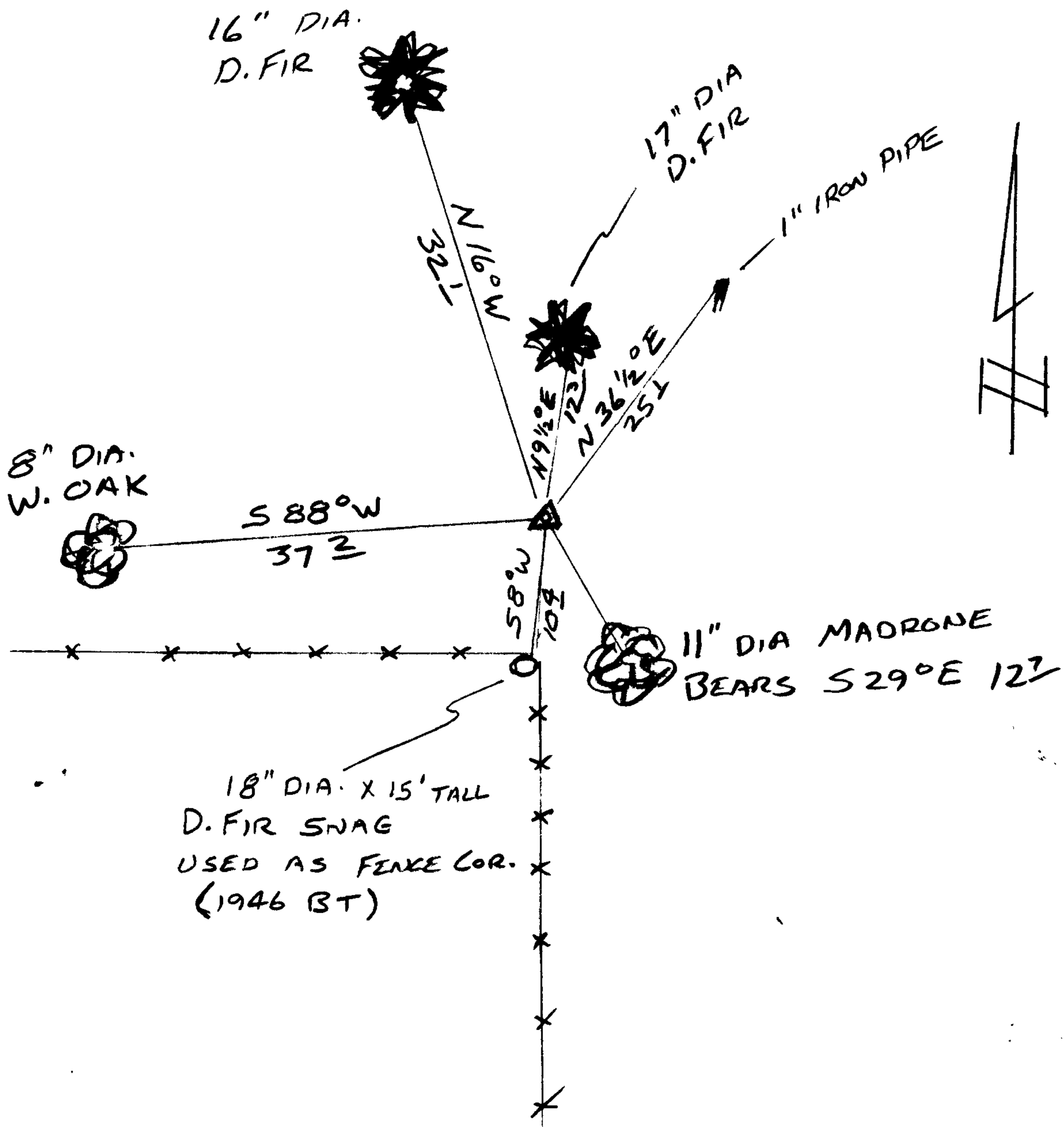

Location & Comments

CORNER BEARS N 8° E 109 FT. FROM FENCE CORNER W/ FENCES EXTENDING WEST AND SOUTH.

Comp. Declin. 16 1/2° E
 Agency DCSO
 Party Chief S. FLAUSE
 Notekeeper J. PIKE
 Witnesses _____

Address

Surveyor's Seal
REGISTERED PROFESSIONAL LAND SURVEYOR

Randall W. Smith
 RENEWAL 6-30-08

OREGON
 JULY 25, 1909
RANDALL W. SMITH
 2469

67114-33