

GOVERNMENT CORNER RESTORATION FORM

Date: 11/9/06 By: JC

This survey consists of:

Township 30S Range 6W Sec. 24 County Douglas

State OR Date 9-21-2006 No. 640300

Narrative:

Corner Fpt: 67/14-32

Corner Designation

DOUGLAS COUNTY SURVEYOR

Condition Report Only

Not Found

Renewed

Unrecorded

Surveyed In

Referenced Out

1/4 S 24
*
S 25

MONUMENT DETAIL

Previous Renewals 1937; 1970

Monument(s) Found: (Condition and Source)

2 1/2" DIA. BC. (MARKED AS SHOWN)
ON 1 1/4" O.D. IRON PIPE FIRMLY
SET PROJECTS FROM GROUND
14".

1" O.D. IRON PIPE HAS BEEN HIT
TOP IS BENT OVER EASTERLY.
BEARS APPROX N 85° E, 0.9 FT.
(1937)

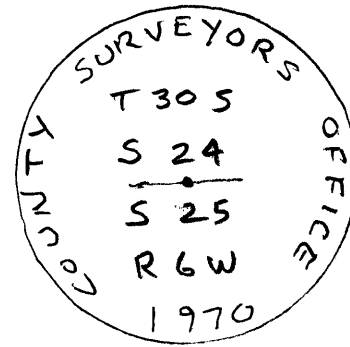

Accessories Found:

8" NOW 18" DIA. D. FIR, FULLY HEALED DOUBLE BLAZE VISIBLE
BEARS S 20° E, 44.4 FT. (AGREES W/REG.) 1970 BT

23" NOW 31" DIA. B. OAK, (MEAS. 2 FT. ABOVE GROUND DUE TO LOW FORK)
HEALED SINGLE BLAZE VISIBLE BEARS N 89° W, 26.5 FT
(AGREES W/REG.) 1937 BT.

12" FIR STUMP NOW 13" DIA. X 1 FT. TALL ROTTED OUT STUMP
BEARS S 51° W 46.5 FT. (REG. S 51° W, 47.5 FT.)
1937 BT.

