

GOVERNMENT CORNER RESTORATION FORM

FILED

Date: 8/24/2005 By: JC

Township 29S Range 4W Sec. 32

County Douglas

This survey consists of:

State OR

Date 8-16-2005

No. 300140

Corner Rpt: 67/10-45

Corner Designation

1/4 cor 32 | 33

DOUGLAS COUNTY

Condition: SURVEYOR Only

Not Found

Renewed

Unrecorded

Surveyed In

Referenced Out

Previous Renewals

MONUMENT DETAIL

Monument(s) Found: (Condition and Source)

2" O.D. IRON PIPE BADLY BENT. TOP LEANS SSE APPROX 15". PIPE IS IN 2 PIECES. A 1 1/2" PIPE IS STUCK INSIDE THE 2" PIPE TOTALING 42" IN LENGTH

Accessories Found:

- 30" D. FIR, NOW 33" X 6 FT TALL STUMP CAPPED W/ALUM. AND BARK SAWN SMOOTH. HEALED BLAZE VISIBLE BEARS N 19° E, 10 1/2 FT. (REC N. 19° E, 9 1/2 FT. PROBABLE FACE MEAS.)
- 18" NOW 27" I. CEDAR, HEALED DOUBLE BLAZE VISIBLE BEARS N 70° W, 41 1/2 FT. (REC. N 70° W, 41 1/2 FT) BYRON 1963
- ROOT HOLE FOUND AT APPROX REC. BRC. & DIST. (REC. S 26° W, 16 1/2) SHEPPARD 1955

RENEWAL

Monument Detail

Monument Set (Procedure and Description)

2 3/8" BRASS CAP ON 1/4" O.D. X 30" IRON PIPE (MARKED AS SHOWN) IS SET IN REFERENCED PLUMB POSITION OF BENT 2" IRON PIPE THE 2 PIECES OF PIPE FOUND ARE RESET ON THE EAST & WEST SIDES. BC/IP PROJECTS FROM GROUND 6".

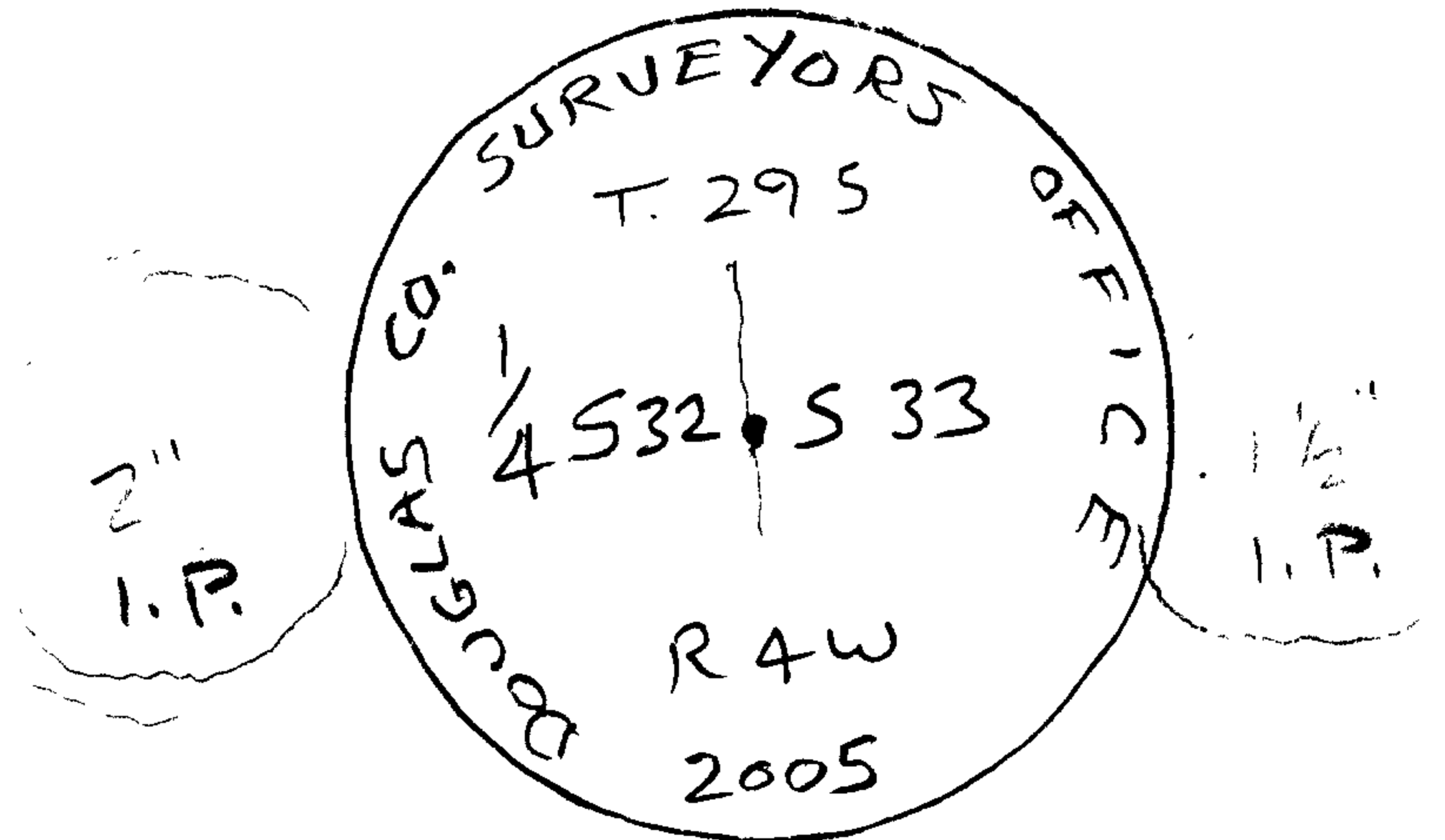

NTS

New Accessories

8" W. FIR, DOUBLE BLAZED & SCRIBED "1/4 S 32 CS BT" BEARS S 64 1/2° W, 18 7/8 FT.  
 14" D. FIR, DOUBLE BLAZED & SCRIBED "7/4 S 32 CS BT" BEARS N 6° W, 35 1/4 FT.  
 6" I. CEDAR, DOUBLE BLAZED & SCRIBED "X CS BT" ON LOW BLAZE BEARS S 53 1/2° E, 33 6/8 FT. TREE IS PISTOL BUTT

Sketch of Monument, Accessories, and General Area

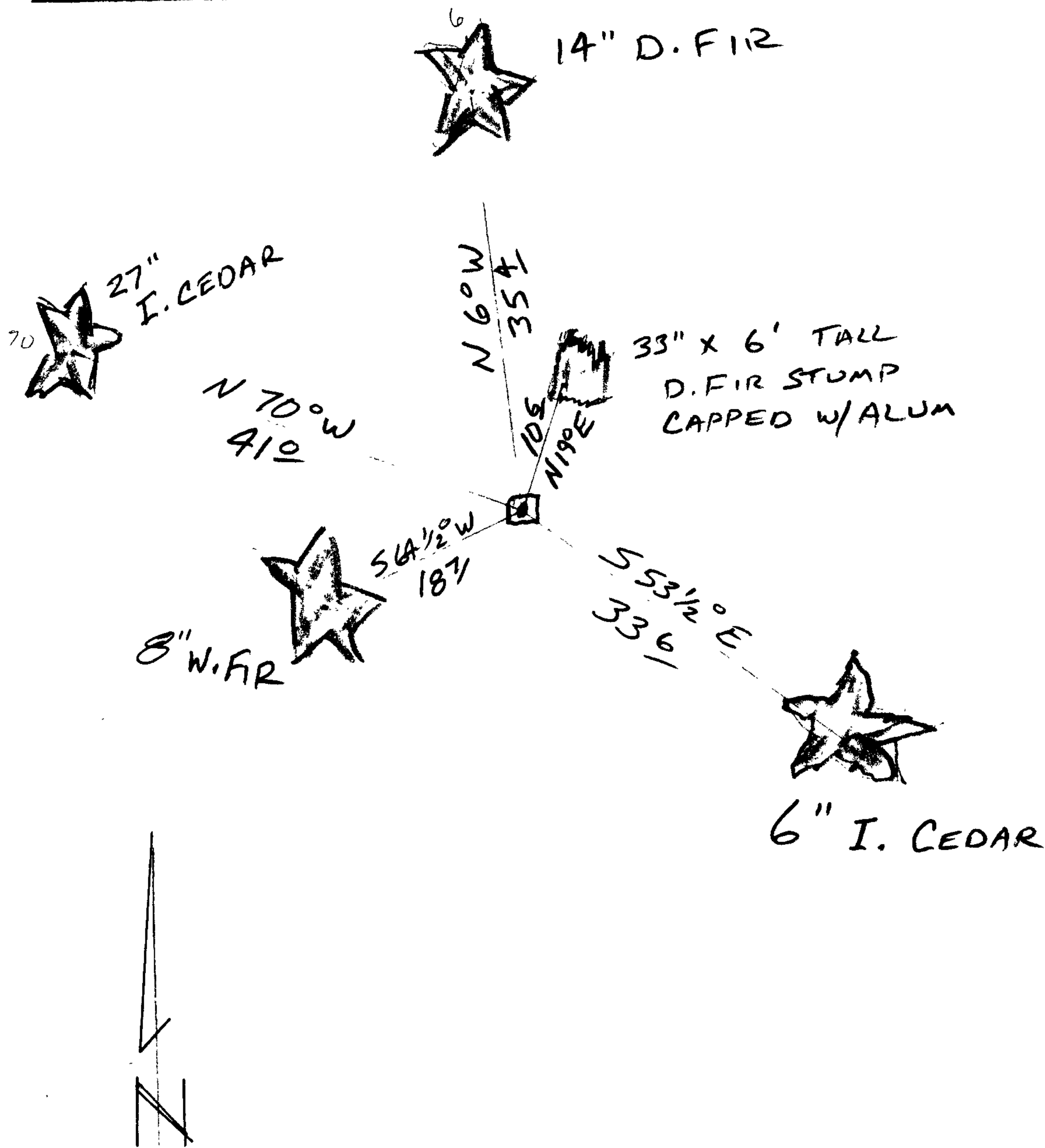

Location & Comments

LIES ON NORTH FACING SLOPE

GPS SESSION = C081612A

Comp. Declin. 16 3/4° E  
 Agency D. C. S. O.  
 Party Chief S. FLAUSE  
 Notekeeper J. PIKE  
 Witnesses

Address

Surveyor's Seal

REGISTERED PROFESSIONAL LAND SURVEYOR

*Randall W. Smith*  
 6-30-06

OREGON  
 JULY 25, 1990  
 RANDALL W. SMITH  
 2400